

UNLESS OTHERWISE SPECIFIED:

- 1) THIS IS AN ULTRA HIGH VACUUM (UHV) PART AND REQUIRES SPECIAL ATTENTION TO AVOID UHV CONTAMINATION. READ LBNL SPECIFICATION M773 BEFORE PERFORMING ANY FABRICATION.
- 2) ALL WELDS ARE TO BE VACUUM LEAK TIGHT AND ARE TO BE HELIUM LEAK TESTED. THE LEAK RATE IS NOT TO EXCEED  $2 \times 10e-9$  cc/sec He.
- 3) SURFACE TREATMENT: THIS IS A UHV PART. FABRICATE AND CLEAN PER LBL SPEC. #M775.
- 4) PROTECT FINISHED PART BY BAGGING OR SIMILAR METHOD TO PROTECT AND MAINTAIN CLEANLINESS DURING SHIPMENT AND STORAGE. TAKE EXTREME CARE NOT TO DING, SCRATCH, DENT, OR OTHERWISE MARK ANY MACHINED SURFACE.

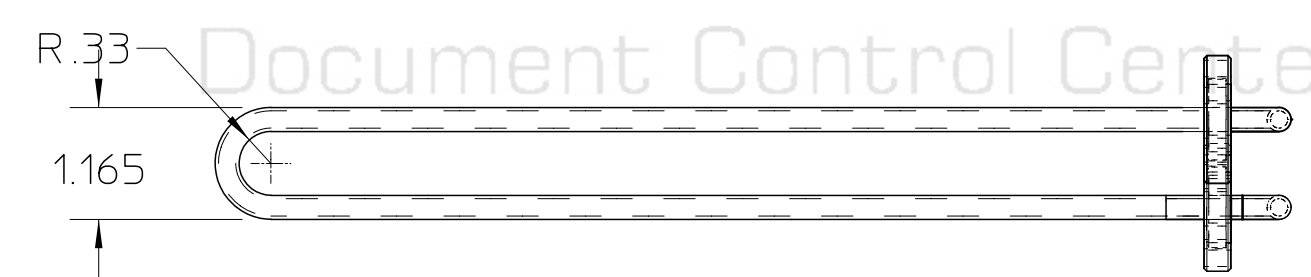
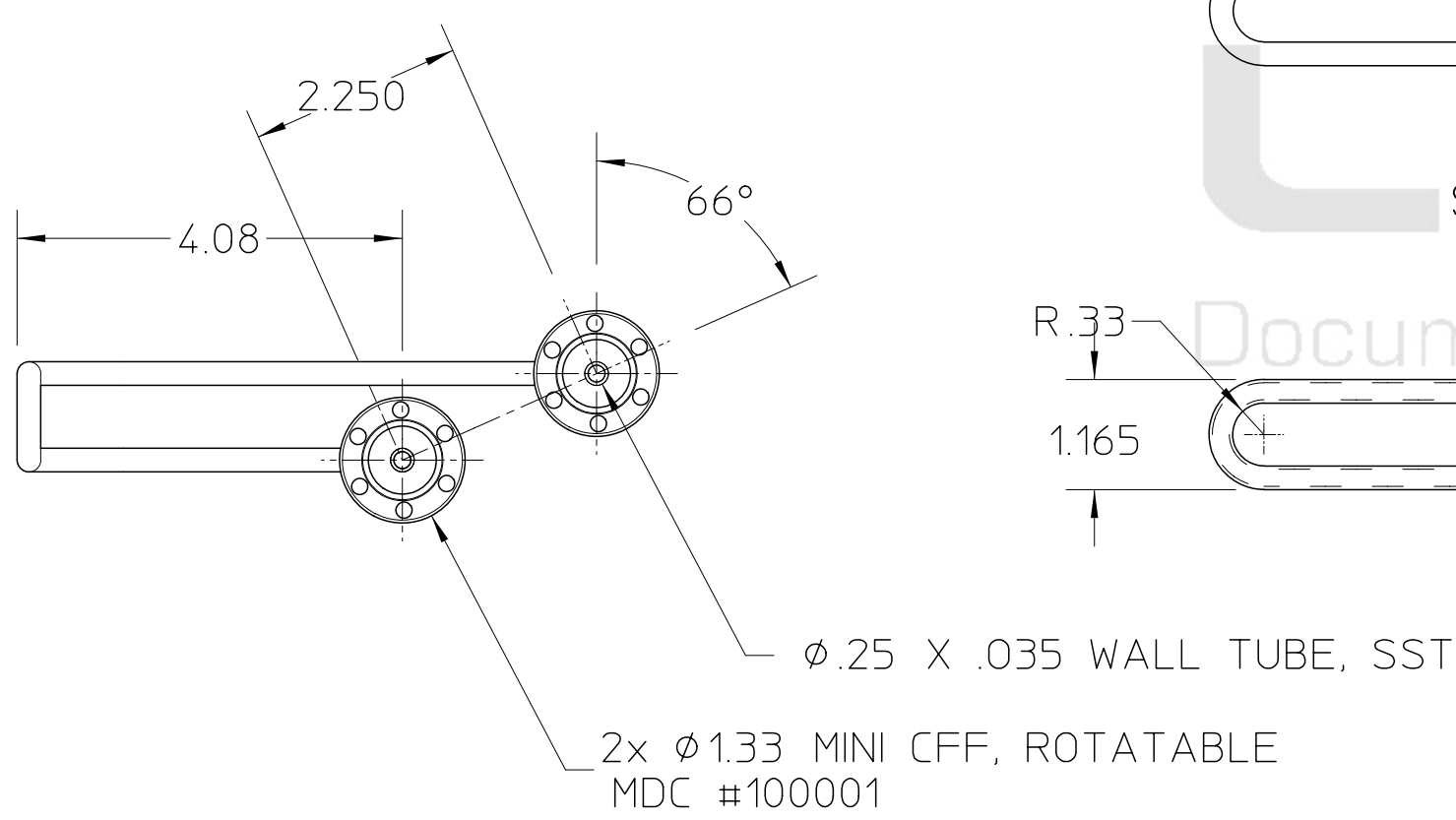
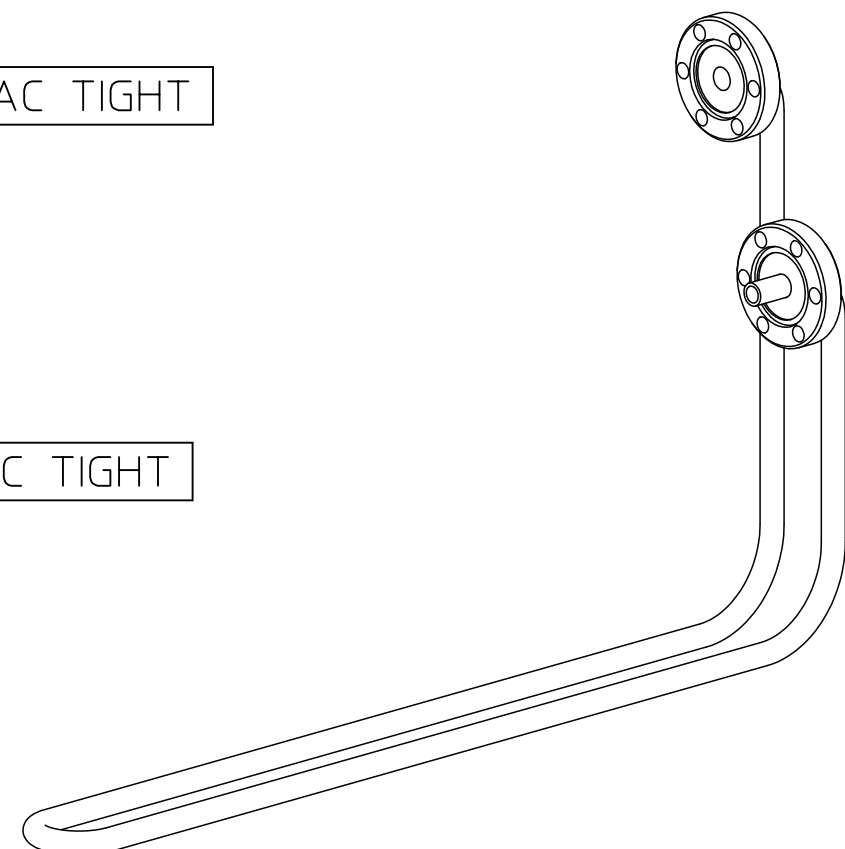
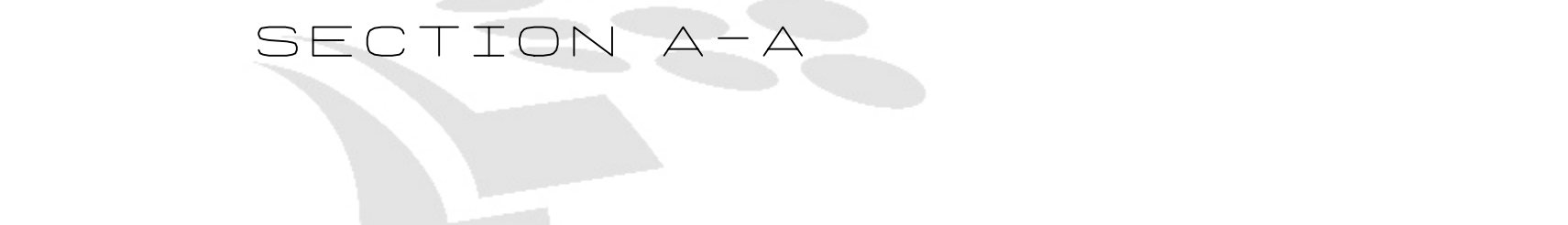
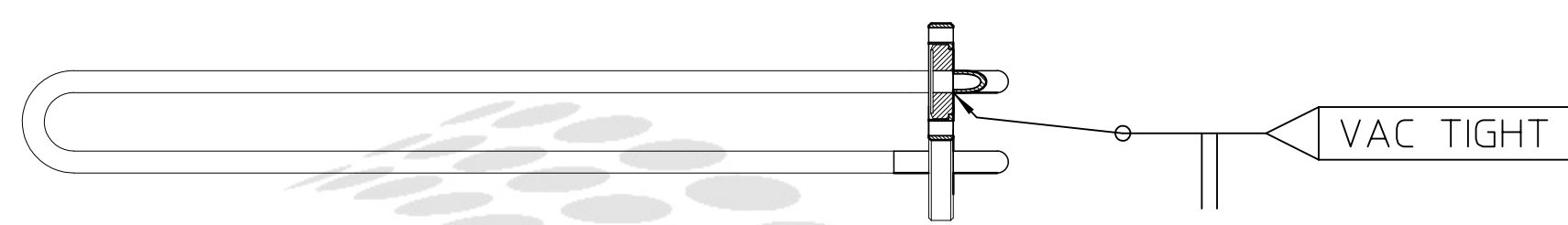
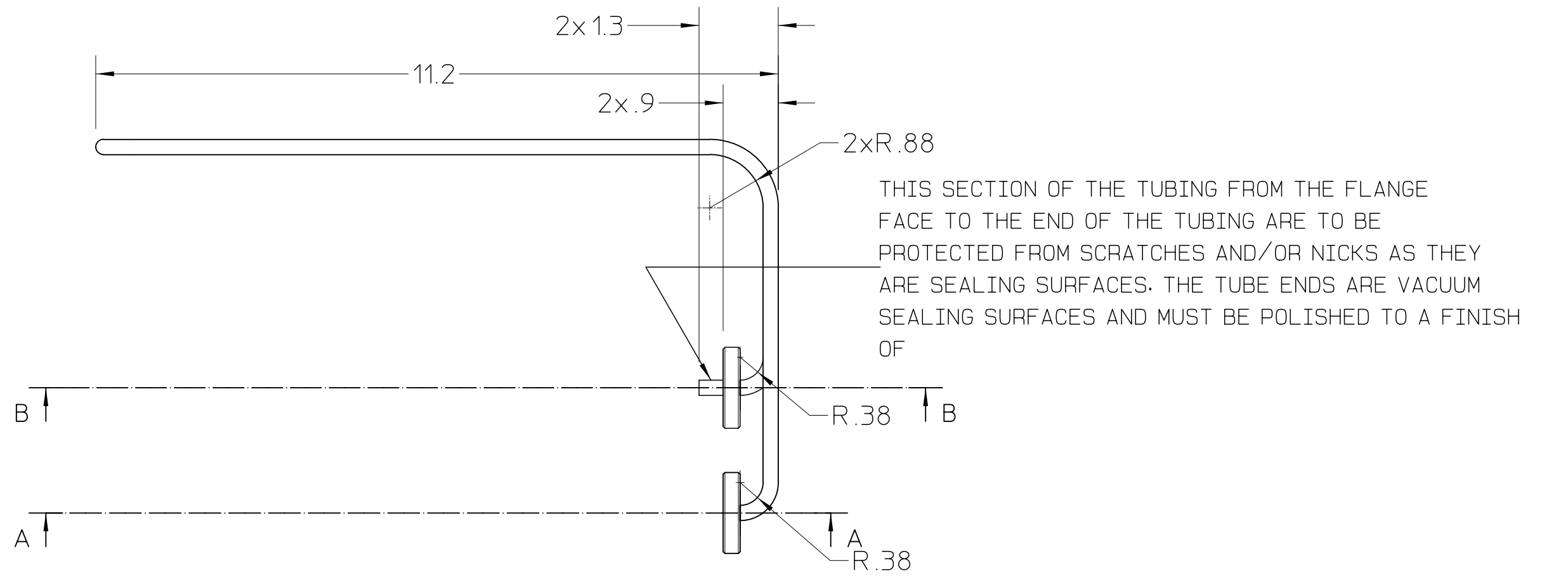

Officially Released to the LBNL Document Control Center  
Released: May 23rd, 2005 DCC Auth Key: C1TSYSBL48

REV	AUTHOR	APPROVER	DATE	CHANGE DESCRIPTION
B	wingert	wingert	05-23-05	ADDED DIMENSIONS AND NOTES
A	wingert	wingert	05-23-05	INITIAL REVISION

UNLESS OTHERWISE SPECIFIED		PROJECT NAME: ERNEST ORLANDO LAWRENCE BERKELEY NATIONAL LABORATORY UNIVERSITY OF CALIFORNIA	
TOLERANCES	.X ± .06 .XX ± .02 .XXX ± .005	PROJECT NUMBER:	ALS - INSERTION DEVICE BEAMLINES
	FRACTIONS: ± 1/64	SCALE: 1:2	BL 4.0.2 - MONOCHROMATOR
	ANGLES: ± 1°/INCH	CATEGORY CODE: AL4045	GRATING COOLING TUBING
	MACH. SURFS.: 125 ✓ OR BETTER	THIRD ANGLE PROJECTION	SHEET 1 OF 1
	REF: ASME Y14.5M-1994, THREADS ARE CLASS 2	DO NOT SCALE PRINT	SIZE: C
	BREAK EDGES .016 MAX. ON MACHINED WORK	REMOVE BURRS, WELD SPLATTER & LOOSE SCALE	DWG NO: 26B728
			REV B