

8

7

6

5

4

3

1

DWG. NO. 25M9214 SIZE REV. A 1

2	-	1	RETAINER PLATE -2	NEMA G-10
1	-	1	RETAINER PLATE -1	NEMA G-10
ITEM	PART NO	REQD	DESCRIPTION	MATERIAL

NOTES: UNLESS OTHERWISE SPECIFIED,

1. DIMENSIONS AND TOLERANCING PER ANSI Y14.5M-1982 UNITS ARE IN INCHES UNLESS OTHERWISE SPECIFIED.
2. USE OF SULFUR OR SILICONE BEARING OILS, LUBRICANTS, OR COOLANTS ARE STRICTLY PROHIBITED
3. USE OF RESIN OR RUBBER BONDED ADRASIVES UNDER POWER IS STRICTLY PROHIBITED. USE VITREOUS BONDED ABRASIVES ONLY.
4. THIS IS A HIGH VACUUM COMPONENT. CLEAN AFTER MACHINING USING A NON-ETCHING ALKALI BASED SOLUTION.
5. PROTECT FINISHED PART BY BAGGING OR SIMILAR METHOD TO PROTECT AND MAINTAIN CLEANLINES DURING SHIPMENT AND STORAGE.

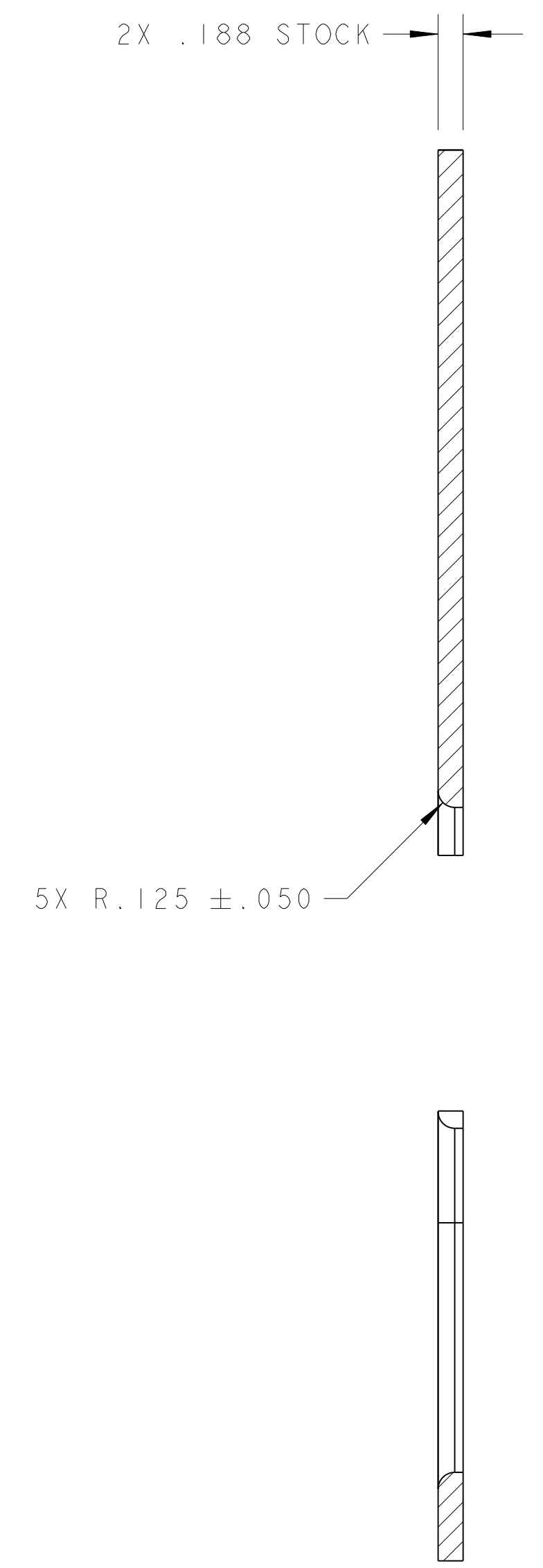
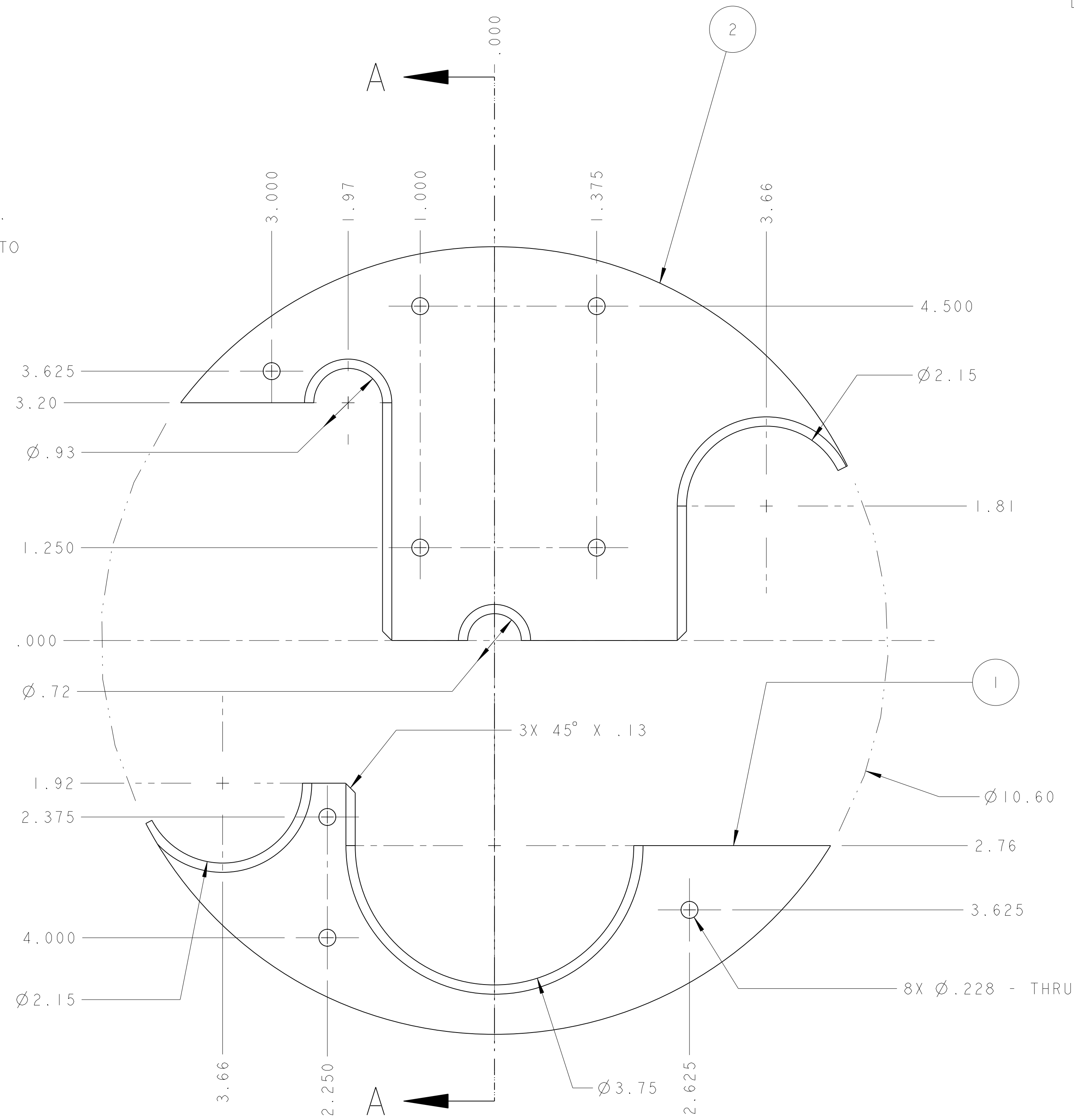

SECTION A - A

<p>UNLESS OTHERWISE SPECIFIED</p> <p>TOLERANCES X.X ± 0.1 FRAC. ± 1/64 X.XX ± 0.02 Angles ± 1.00° X.XXX ± 0.005 FINISH 125 \sqrt{Ra}</p> <p>DO NOT SCALE PRINT</p> <p>THREADS ARE CLASS 2</p> <p>CHAMFER ENDS OF ALL SCREW THREADS 30°</p> <p>CUT ROUNDS, 1.5 THREAD RELIEF ON MACHINED THREADS</p> <p>BREAK EDGES .016 MAX. ON MACHINED WORK</p> <p>REMOVE BURRS, WELD SPLATTER & LOOSE SCALE</p> <p>IN ACCORDANCE WITH ASME Y14.5M & B46.1</p>				<p>SHOP ORDERS</p> <p>ACCT. NO. NO. SER. NO. DATE</p> <p>DEL. TO REQD. ISSD DATE</p> <p>RECD. DATE</p> <p>SURFACE TREATMT</p> <p>IDENT. METHOD TAG</p> <p>PROJECT NUMBER N/A</p> <p>PROJECT NAME N/A</p> <p>DWG. BY R. LA MANTIA DATE 31-Oct-01</p> <p>CHK. BY Jon Zobasnik/S. Virostek DATE 15-Nov-02</p> <p>APP. BY Jon Zobasnik/D. Oshofz DATE 15-Nov-02</p>				<p>ERNEST ORLANDO LAWRENCE BERKELEY NATIONAL LABORATORY UNIVERSITY OF CALIFORNIA - BERKELEY</p> <p>LHC IR FEEDBOX CRYogenics RETAINER PLATE ASSEMBLY</p> <p>MICROFILMED: DWG. TYPE: ASSEM SHOWN ON: - SCALE: 1/1 DO NOT SCALE PRINTS</p> <p>PATENT CLEAR: DESIGN ACCT. NO.: Z5LCE3 CATEGORY CODE: LH2003</p> <p>DWG. NO. 25M9214 SIZE A REV. 1</p>				
REV	DWG	CHK	ZONE	DATE	INITIAL RELEASE				CHANGES			
A	ARH	SPV		11-15-02								

8

7

6

5

4

3

2

1

FILE: 25M9214.PLT