

8

7

6

5

4

3

DWG. NO. 2515864 SIZE REV. A 1

1

NOTES: (UNLESS OTHERWISE SPECIFIED)

- 1. THIS IS A CRYOGENIC VACUUM COMPONENT.
- 2. CLEANING PROCEDURE : PER VENDOR SPECIFICATION WITH LBNL APPROVAL.
- 3. PACKAGING AND STORAGE PROCEDURE OF THE COMPONENTS: PER VENDOR SPECIFICATION WITH LBNL APPROVAL.
- 4. DIMENSIONS AND TOLERANCING PER ANSI Y14.5M-1982. UNITS ARE IN INCHES UNLESS OTHERWISE SPECIFIED.
- 5. USE OF SULFUR OR SILICONE BEARING OILS, LUBRICANTS, OR COOLANTS ARE STRICTLY PROHIBITED.
- 6. USE OF RESIN OR RUBBER BONDED ABRASIVES UNDER POWER IS STRICTLY PROHIBITED. USE VITREOUS BONDED ABRASIVES ONLY.

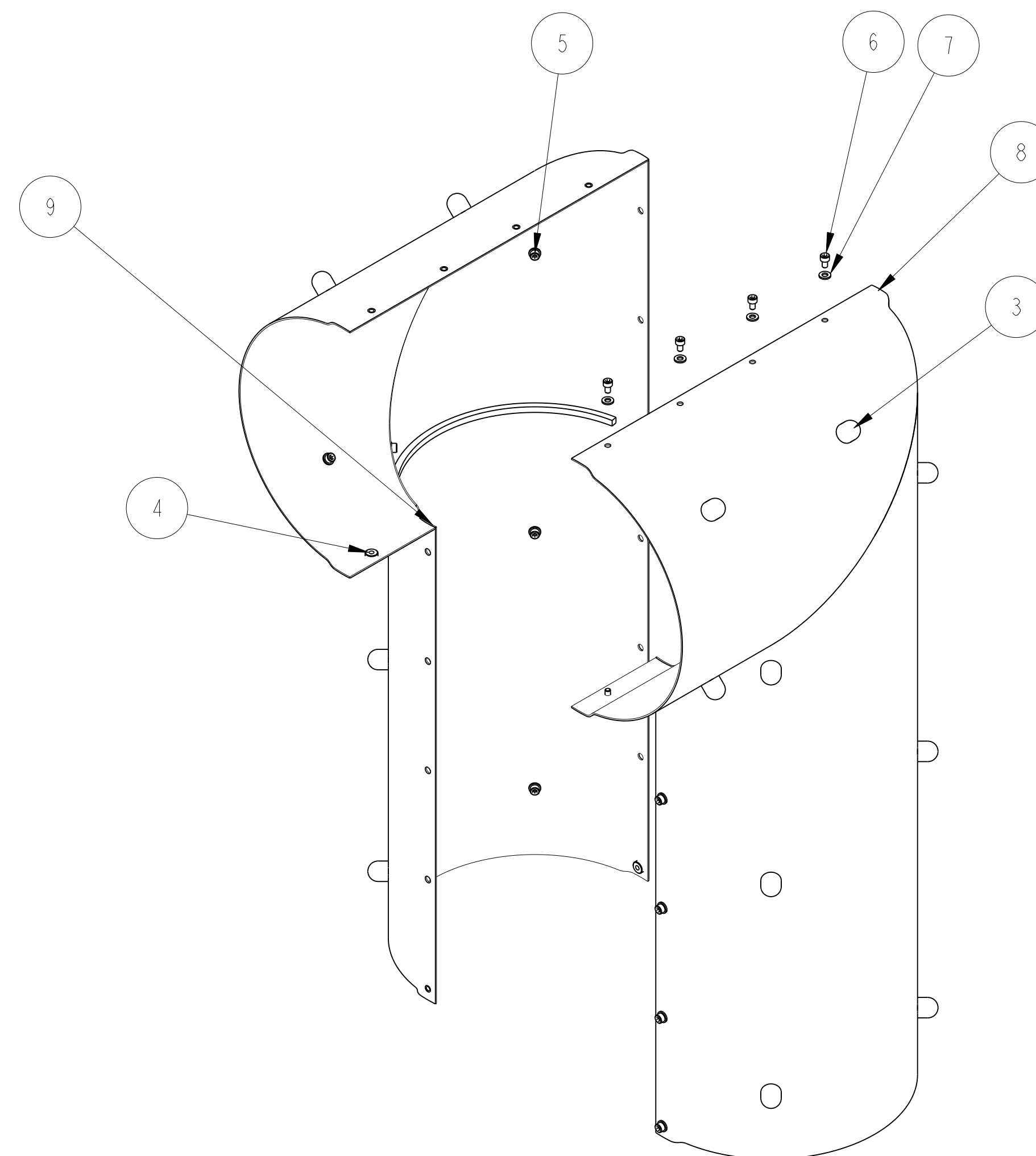
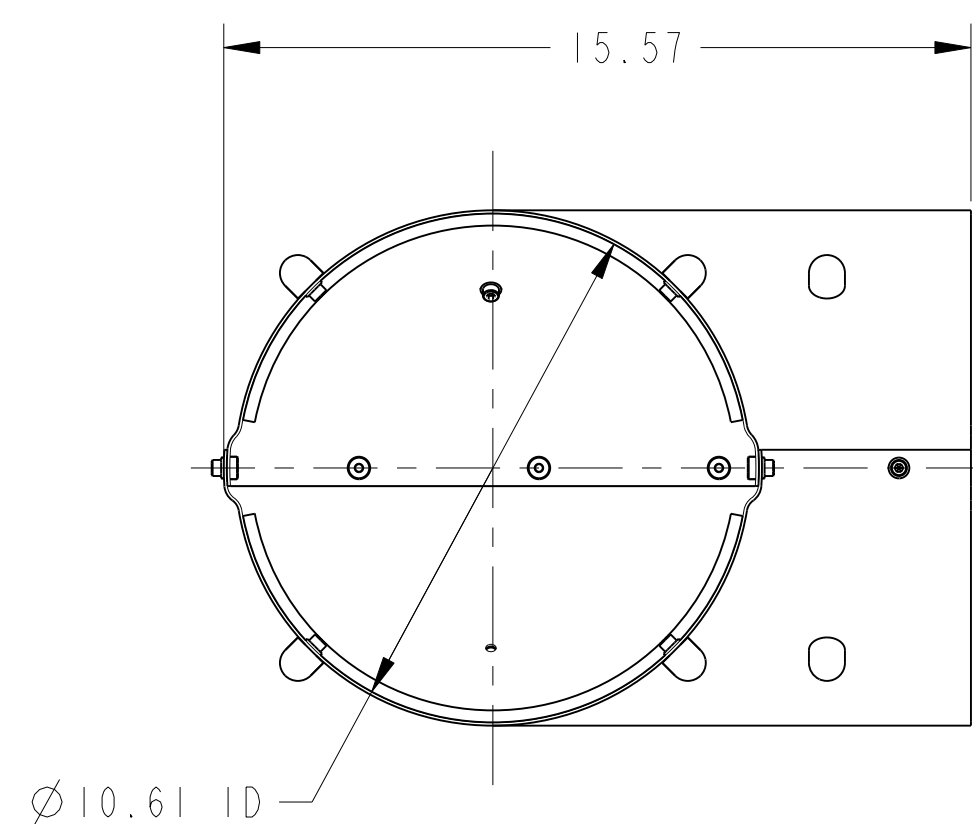
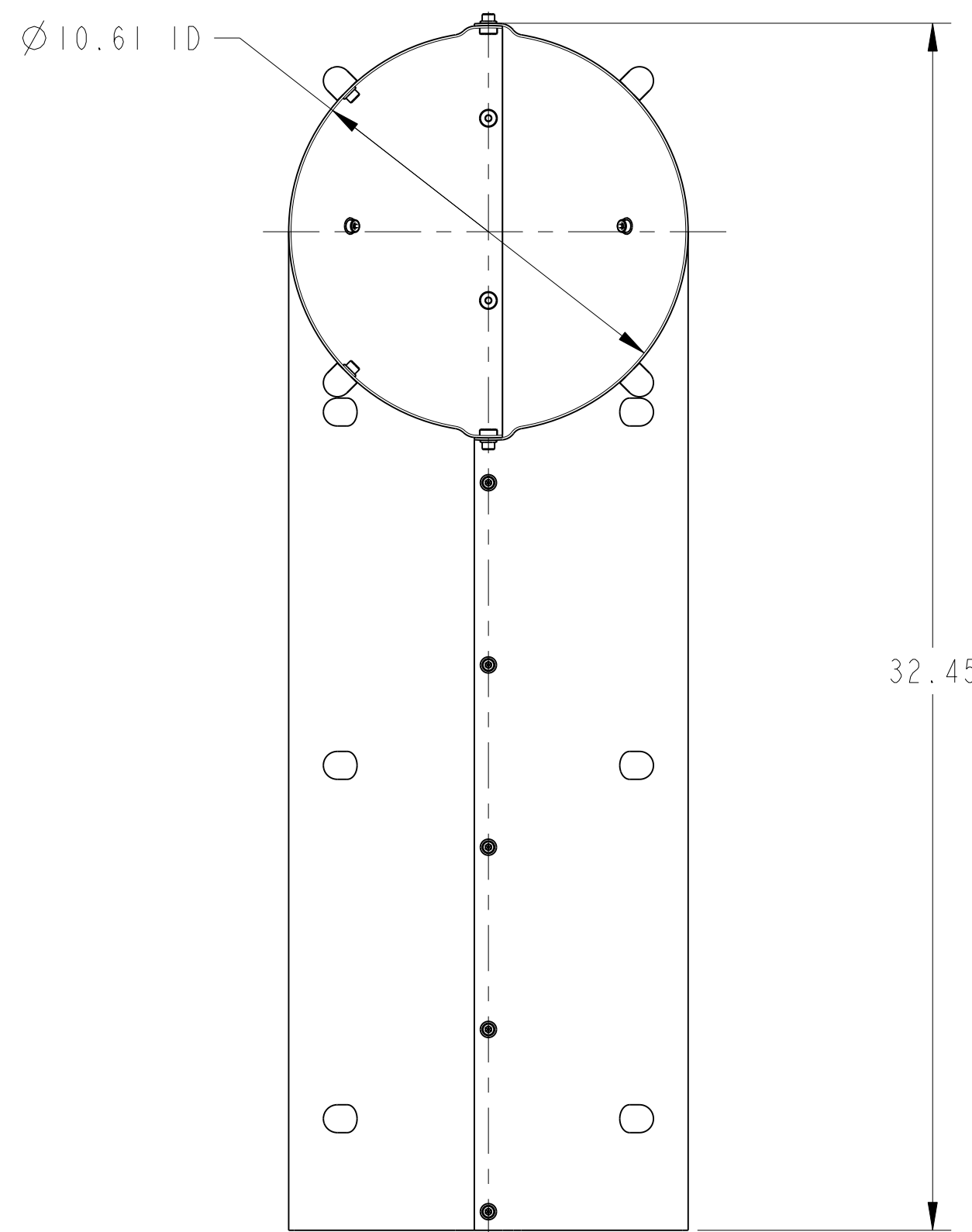
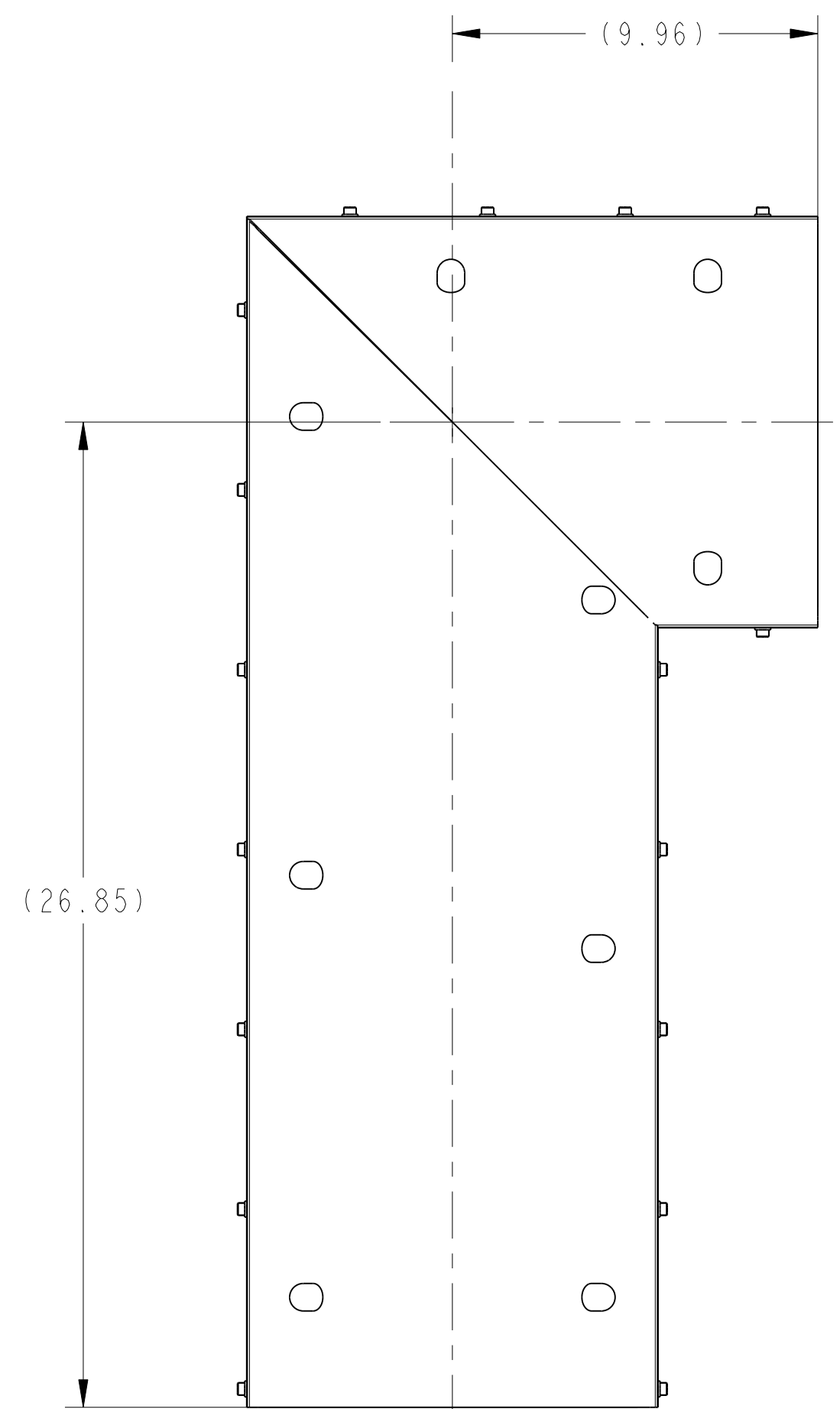

SCALE 0.250

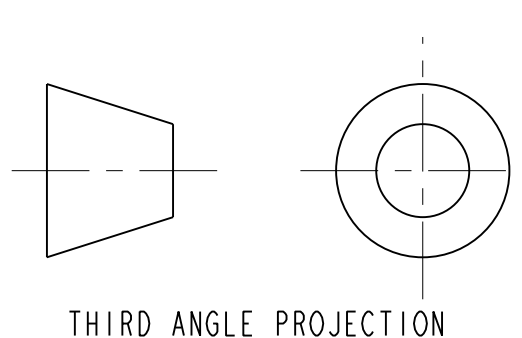

THIRD ANGLE PROJECTION

<p>UNLESS OTHERWISE SPECIFIED</p> <p>TOLERANCES: X.X ± 0.1 FRAC. ± 1/64 X.XX ± 0.03 Angles ± 1.00° X.XXX ± 0.010 FINISH 125$\sqrt{\text{Ra}}$</p> <p>DO NOT SCALE PRINT</p> <p>THREADS ARE CLASS 2</p> <p>CHAMFER ENDS OF ALL SCREW THREADS 30°</p> <p>CUT ROUND, 1.5 THREAD RELIEF ON MACHINED THREADS</p> <p>BREAK EDGES .016 MAX. ON MACHINED WORK</p> <p>REMOVE BURRS, WELD SPLATTER & LOOSE SCALE</p> <p>IN ACCORDANCE WITH ASME Y14.5M & B46.1</p>				<p>SHOP ORDERS</p> <p>ACCT. NO. NO. SER. NO. DATE</p> <p>DEL. TO ISSD RECD DATE</p> <p>SURFACE TREATMT</p> <p>IDENT. METHOD TAG</p> <p>PROJECT NUMBER N/A</p> <p>PROJECT NAME N/A</p> <p>DWG. DESIGNER: 35 DATE 26-Feb-02</p> <p>CHK. CHECKER: 35 DATE 21-Apr-02</p> <p>APP. BY: APPROVER: 35 DATE 21-Apr-02</p>				<p>ERNEST ORLANDO LAWRENCE BERKELEY NATIONAL LABORATORY UNIVERSITY OF CALIFORNIA - BERKELEY</p> <p>LHC IR FEEDBOX VACUUM THERMAL SHIELD JUMPER, JC2</p> <p>MICROFILMED: DWG. TYPE: ASSEM SHOWN ON: - SCALE: 0.250 DO NOT SCALE PRINTS</p> <p>PATENT CLEAR: DESIGN ACCT. NO. CATEGORY CODE DWG. NO. SIZE REV.</p> <p>Z5LC2 LH2002 2515864 A</p>				
REV	DWG	CHK	ZONE	DATE	INITIAL RELEASE				CHANGES			
A	JDR	DPO		11-06-02								

8

7

6

5

4

3

2

1