

ITEM	PART NO	RECD	DESCRIPTION	MATERIAL
9	251585	1	CLAM SHELL 2, OOSC	CDA 101
8	251584	1	CLAM SHELL 1, OOSC	CDA 101
7	-	27	WASHER, M5, SILVER PLATE	-
6	-	13	SCH, MSX.8, 8LG, SILVER PLATED	SS 18-8
5	-	14	SCH, MSX.8, 10LG, SILVER PLATED, VENTED	SS 18-8
4	-	13	M5 CAPTIVE NUT, PEM AC-M5-1-SF	SS
3	251262	14	SPACER, OOS	NEMA G10

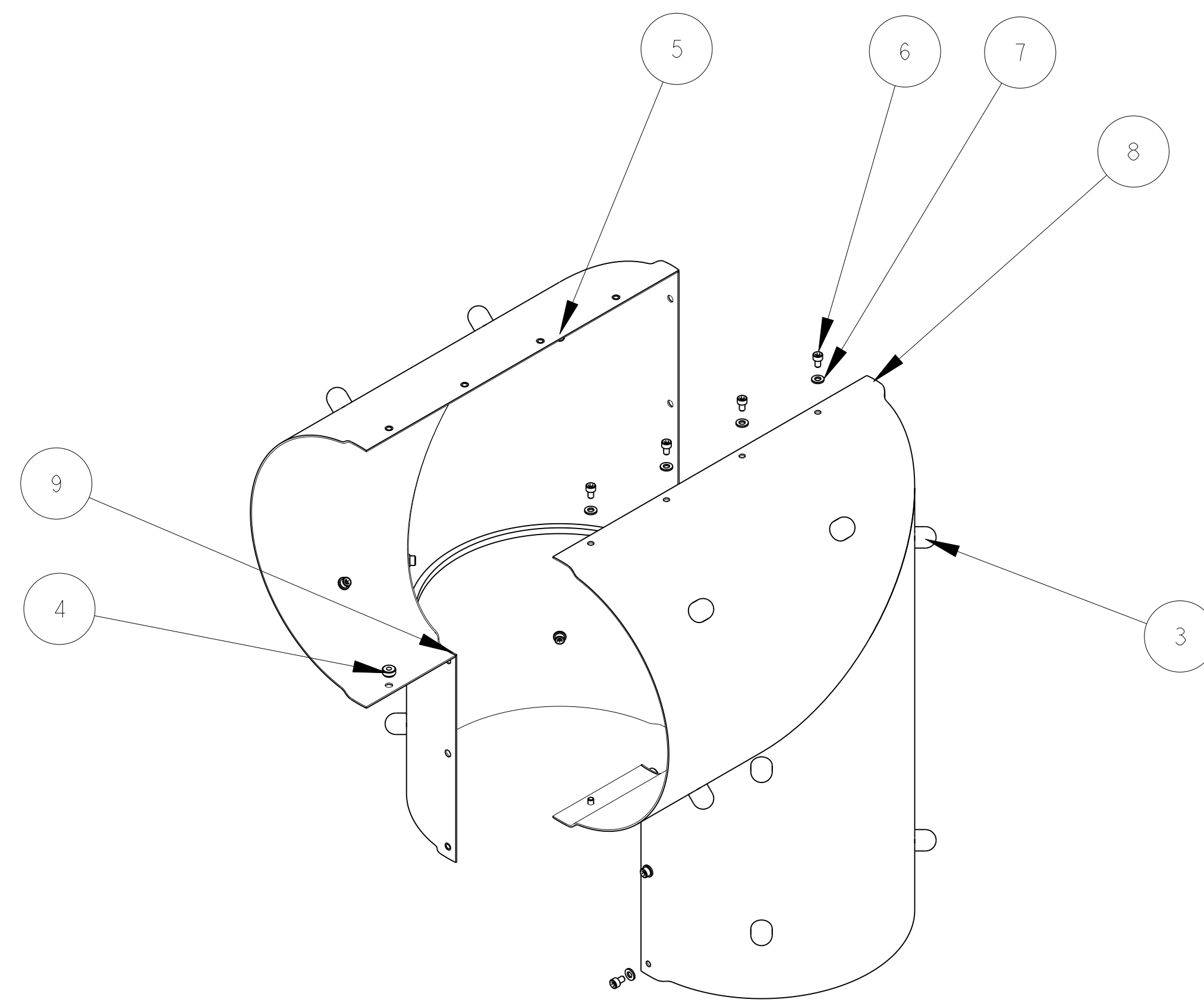

NOTES: (UNLESS OTHERWISE SPECIFIED)

- THIS IS A CRYOGENIC VACUUM COMPONENT.
- CLEANING PROCEDURE : PER VENDOR SPECIFICATION WITH LBNL APPROVAL.
- PACKAGING AND STORAGE PROCEDURE OF THE COMPONENTS: PER VENDOR SPECIFICATION WITH LBNL APPROVAL.
- DIMENSIONS AND TOLERANCING PER ANSI Y14.5M-1982. UNITS ARE IN INCHES UNLESS OTHERWISE SPECIFIED.
- USE OF SULFUR OR SILICONE BEARING OILS, LUBRICANTS, OR COOLANTS ARE STRICTLY PROHIBITED.
- USE OF RESIN OR RUBBER BONDED ABRASIVES UNDER POWER IS STRICTLY PROHIBITED. USE VITREOUS BONDED ABRASIVES ONLY.

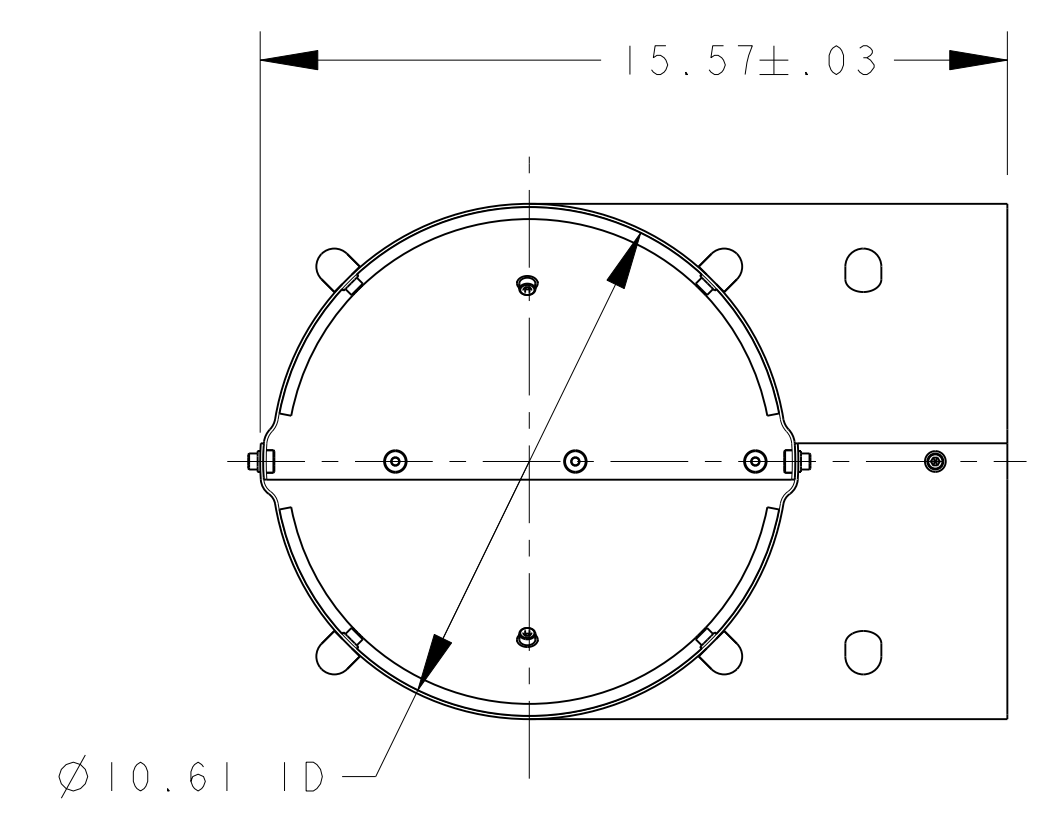
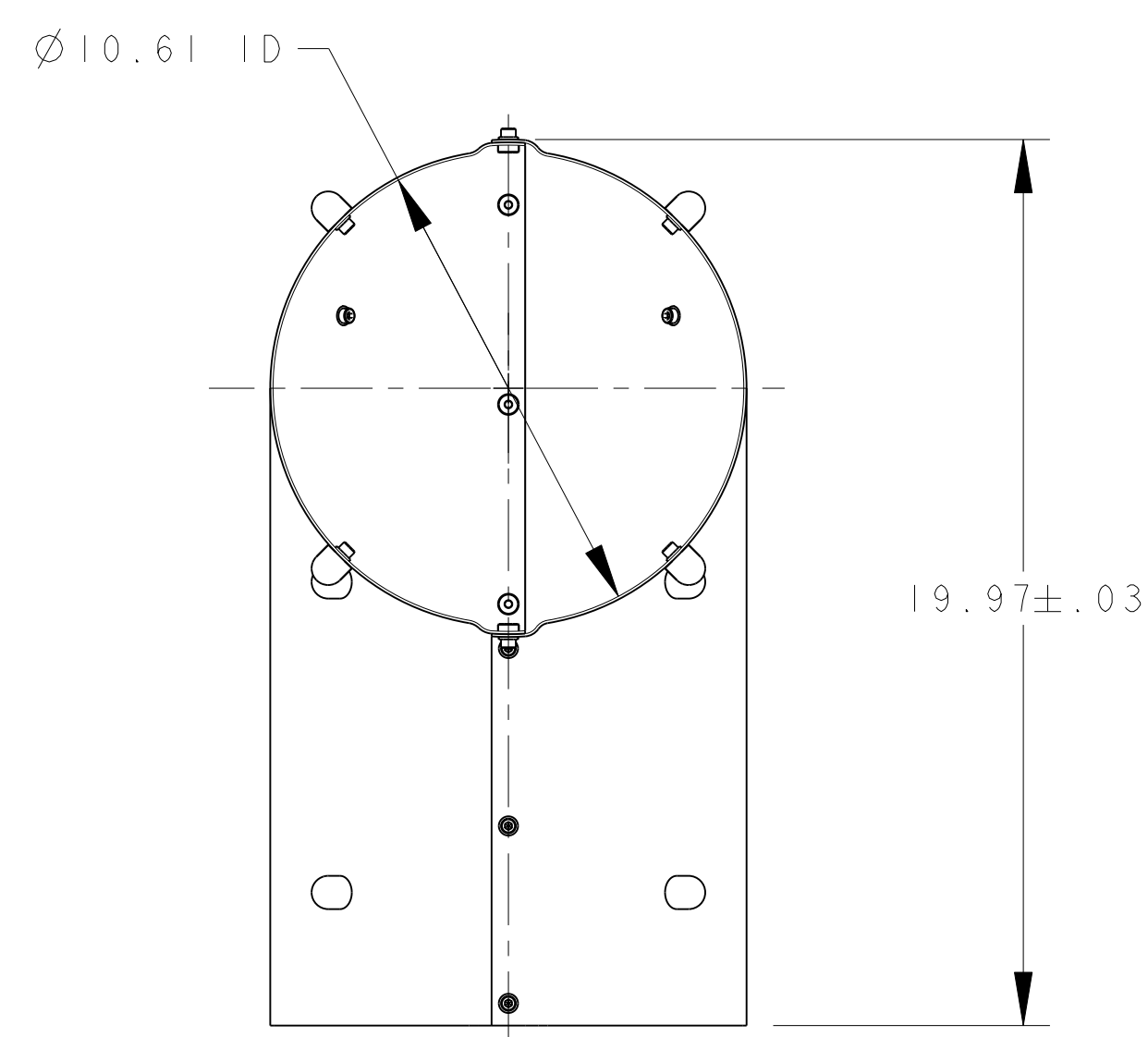
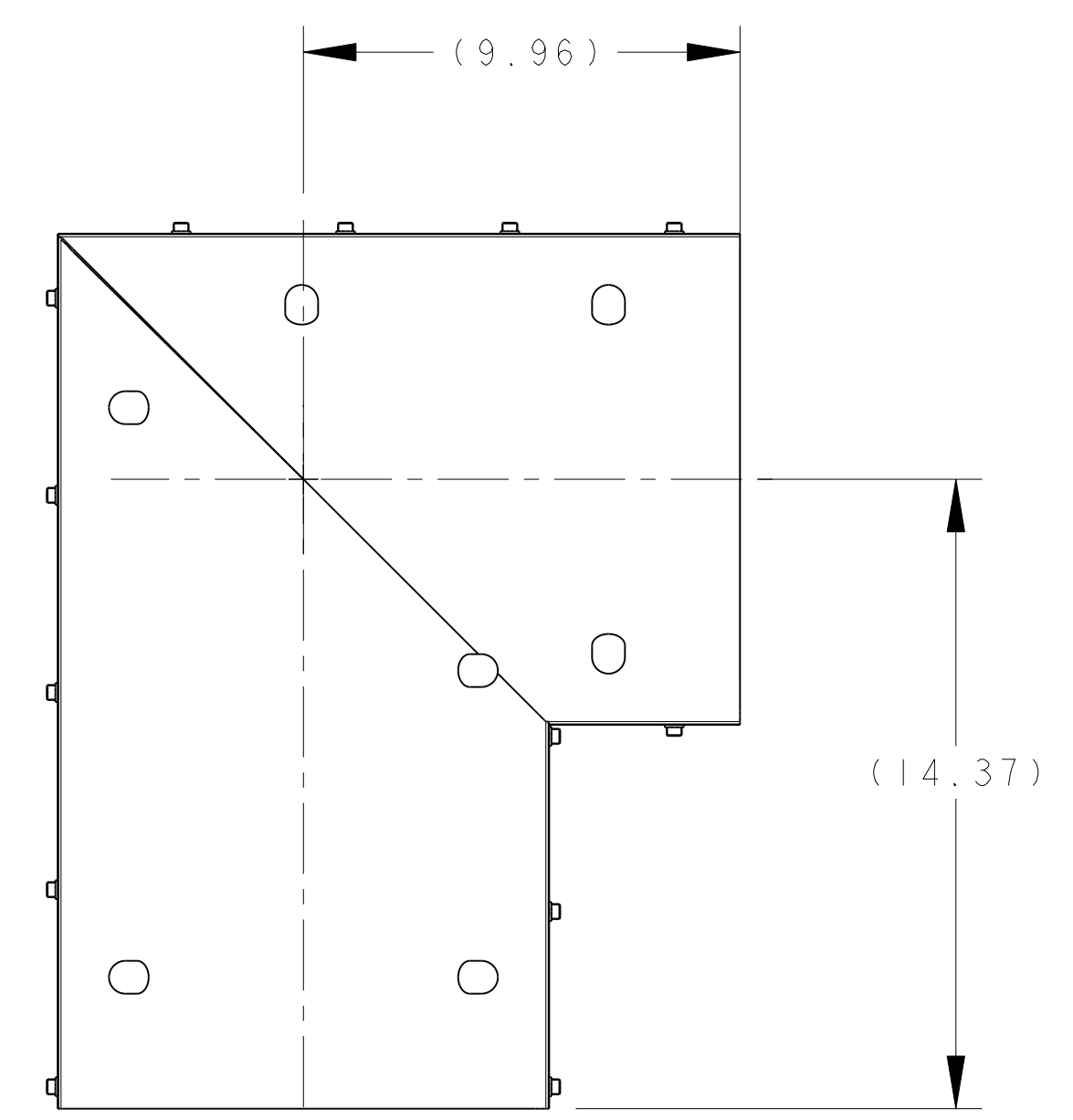
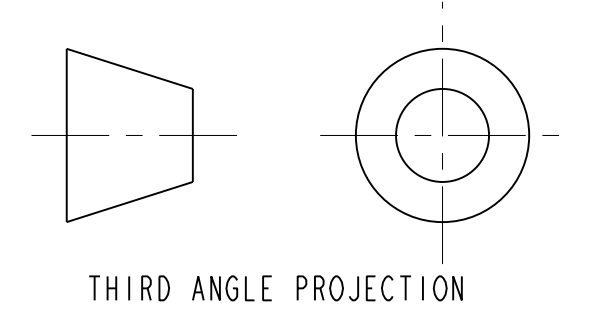

REV	DWG	CHK	ZONE	DATE	CHANGES
A	JDR	DPO		11-06-02	INITIAL RELEASE
					CHANGES

TOLERANCES		FRAC. ± 1/64		SHOP ORDERS	
X.X ± 0.1				ACCT NO.	NO.
X.XX ± 0.03				DATE ISSD	DATE RECD
X.XXX ± 0.010				DEL TO	DATE RECD
				SURFACE TREATMT	
				IDENT METHOD TAG	
				PROJECT NUMBER	
				PROJECT NAME	
				DWG BY: R LA MANTIA DATE: 26-Feb-02	
				CHK BY: Jon Zbasnik DATE: 21-Apr-02	
				APP BY: Jon Zbasnik DATE: 21-Apr-02	

**ERNEST ORLANDO LAWRENCE**  
**BERKELEY NATIONAL LABORATORY**  
 UNIVERSITY OF CALIFORNIA - BERKELEY

LHC IR FEEDBOX  
 CRYOGENICS  
 THERMAL SHIELD JUMPER, JCI

MICROFILMED: [ ] DWG. TYPE: ASSEM SHOWN ON: - SCALE: 1/4 DO NOT SCALE PRINTS: [ ]

PATENT CLEAR: [ ] DESIGN ACCT. NO.: Z5LCE2 CATEGORY CODE: LH2003 DWG. NO.: 2515834 SIZE: A REV.: 1

8 7 6 5 4 3 1

D  
C  
B  
A

D  
C  
B  
A

8 7 6 5 4 3 2 1