

ITEM	PART NO.	REQD.	DESCRIPTION	MATERIAL
2	-	-	PIPE, 12 NPS, SCHED 5 S, PER ASTM A312	SS 304L
1	-	-	PIPE, 12 NPS, SCHED 5 S, PER ASTM A312	SS 304L

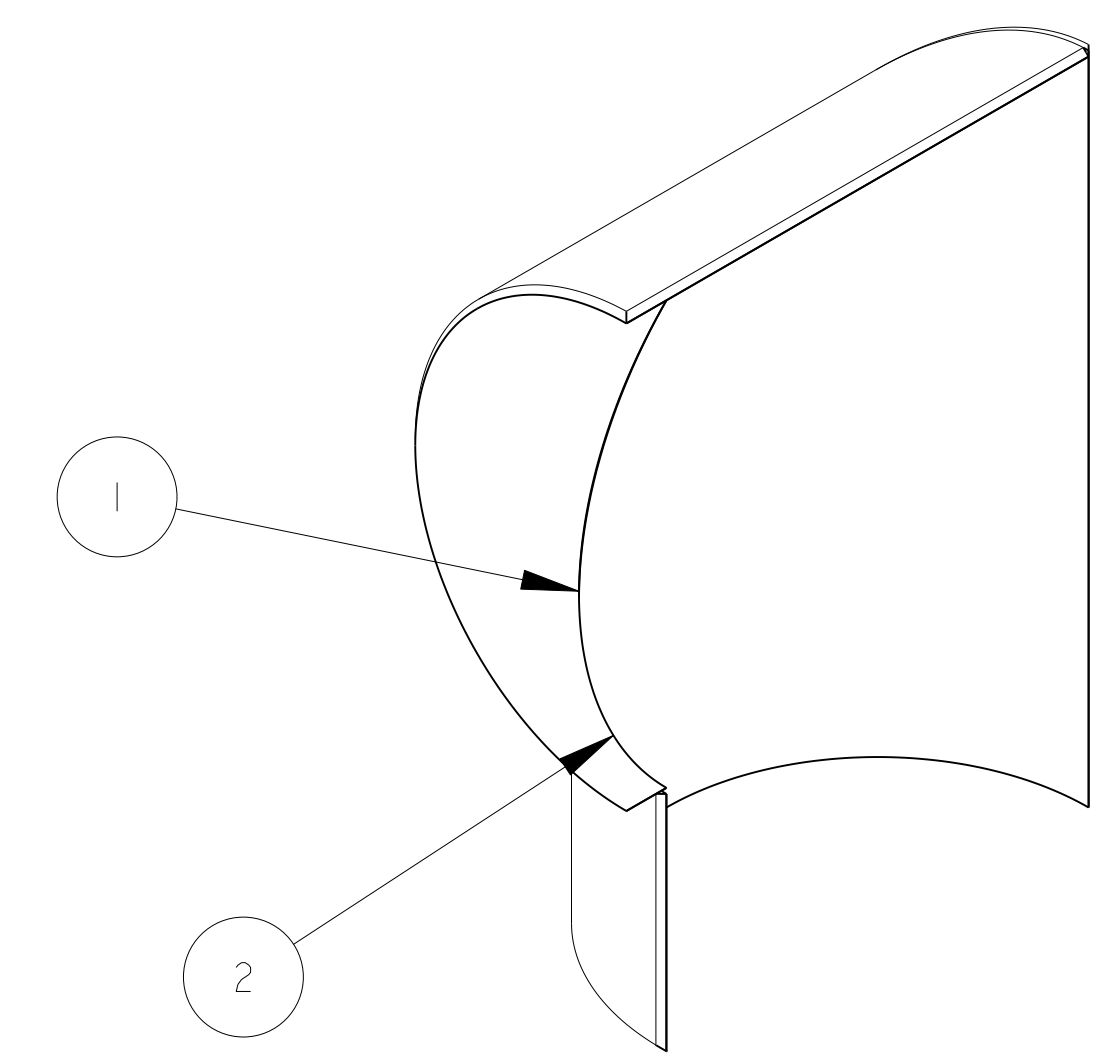

- NOTES: UNLESS OTHERWISE SPECIFIED,
- DIMENSIONS AND TOLERANCING PER ANSI Y14.5M-1982 UNITS ARE IN INCHES UNLESS OTHERWISE SPECIFIED.
  - USE OF SULFUR OR SILICONE BEARING OILS, LUBRICANTS, OR COOLANTS ARE STRICTLY PROHIBITED
  - USE OF RESIN OR RUBBER BONDED ADRASIVES UNDER POWER IS STRICTLY PROHIBITED. USE VITREOUS BONDED ABRASIVES ONLY.
  - CLEAN AFTER MACHINING PER VENDOR SPECIFICATION; SUBJECT TO LBNL APPROVAL.
  - VENDOR SUGGESTED CHANGES TO WELD PREPS; SUBJECT TO LBNL APPROVAL.
  - WELDS PER VENDOR PROCEDURES; SUBJECT TO LBNL APPROVAL.
  - PROTECT FINISHED PART BY BAGGING OR SIMILAR METHOD TO PROTECT AND MAINTAIN CLEANLINESS DURING SHIPMENT AND STORAGE.
  - VENDOR SUGGESTED CHANGES TO TOLERANCES TO FACILITATE ASSEMBLY; SUBJECT TO LBNL APPROVAL
  - ESTIMATED WEIGHT = 22 LBS

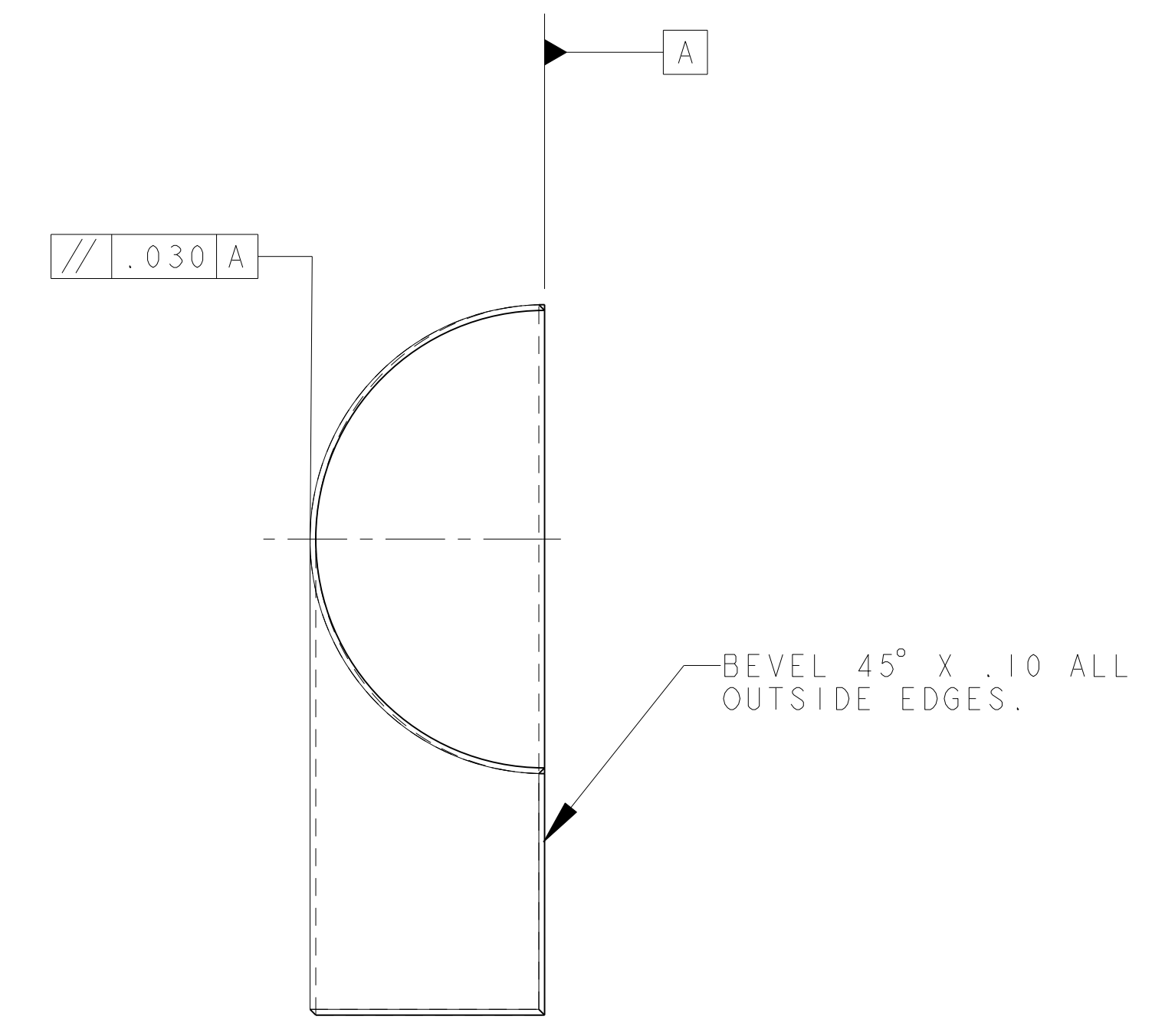
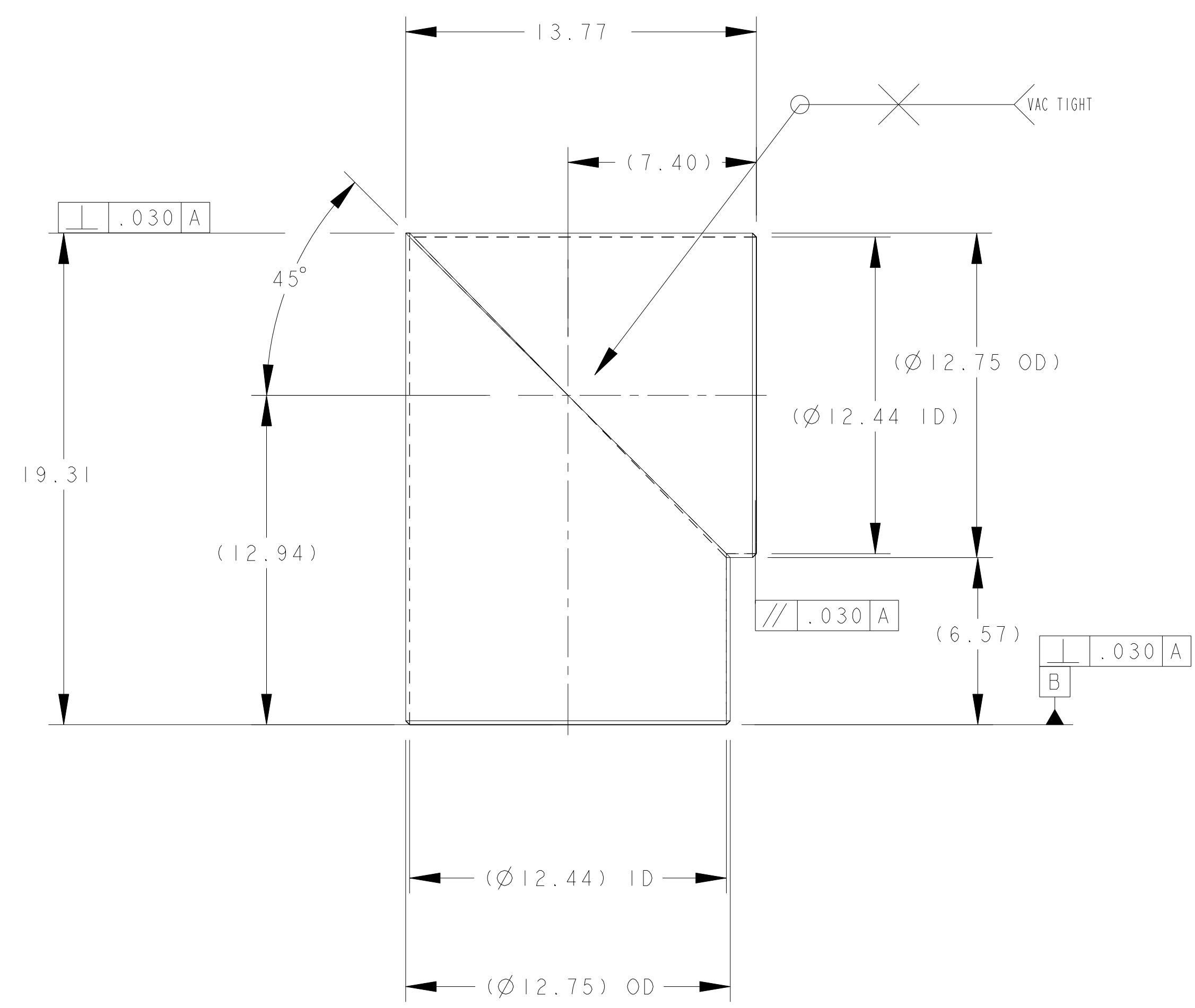
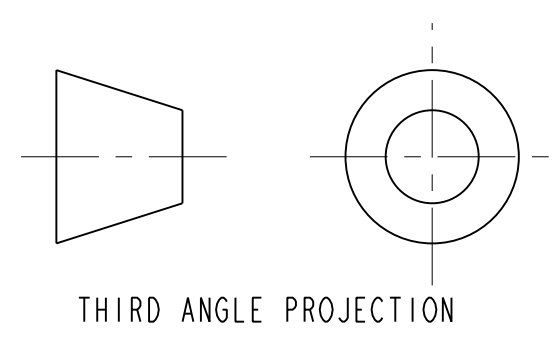

<p>UNLESS OTHERWISE SPECIFIED</p> <p>TOLERANCES X.X ± 0.1    FRAC. ± 1/64 X.XX ± 0.03    Angles ± 1.00° X.XXX ± 0.010    FINISH 125<sup>µ</sup>max</p> <p>DO NOT SCALE PRINT</p> <p>THREADS ARE CLASS 2</p> <p>CHAMFER ENDS OF ALL SCREW THREADS 30°</p> <p>CUT ROUND, 1.5 THREAD RELIEF ON MACHINED THREADS</p> <p>BREAK EDGES .016 MAX. ON MACHINED WORK</p> <p>REMOVE BURRS, WELD SPLATTER &amp; LOOSE SCALE</p> <p>IN ACCORDANCE WITH ASME Y14.5M &amp; B46.1</p>		<p>SHOP ORDERS</p> <p>ACCT. NO.    NO.    SER. NO.    DATE</p> <p>DEL. TO    DATE    RECD.    DATE</p> <p>SURFACE TREATMENT</p> <p>IDENT. METHOD    TAG</p> <p>PROJECT NUMBER    N/A</p> <p>PROJECT NAME    N/A</p> <p>DWG. BY    R. LA MANTIA    DATE    28-Nov-01</p> <p>CHK. BY    Jon Zbasnik    DATE    4/2/02</p> <p>APP. BY    Jon Zbasnik    DATE    4/2/02</p>		<p>ERNEST ORLANDO LAWRENCE BERKELEY NATIONAL LABORATORY UNIVERSITY OF CALIFORNIA - BERKELEY</p> <p>LHC IR FEEDBOX VACUUM ENCLOSURE CHIMNEY HALF 2, JCI</p> <p>MICROFILMED:    DWG. TYPE    SHOWN ON    SCALE: 1/4    DO NOT SCALE PRINTS</p> <p>ASSEM    -    SHEET 1 OF 1</p> <p>PATENT CLEAR:    DESIGN ACCT. NO.    CATEGORY CODE    DWG. NO.    SIZE    REV.</p> <p>Z5LCE2    LH2002    2515824    A</p>					
REV	DWG	CHK	ZONE	DATE	INITIAL RELEASE	CHANGES			
A	JDR	DPO		11/206/02					