

ITEM	PART NO.	RECD	DESCRIPTION	MATERIAL
2	-	-	PIPE, 12NPS, SCHED 5S, PER ASTM A312	304L
1	-	-	PIPE, 12NPS, SCHED 5S, PER ASTM A312	304L

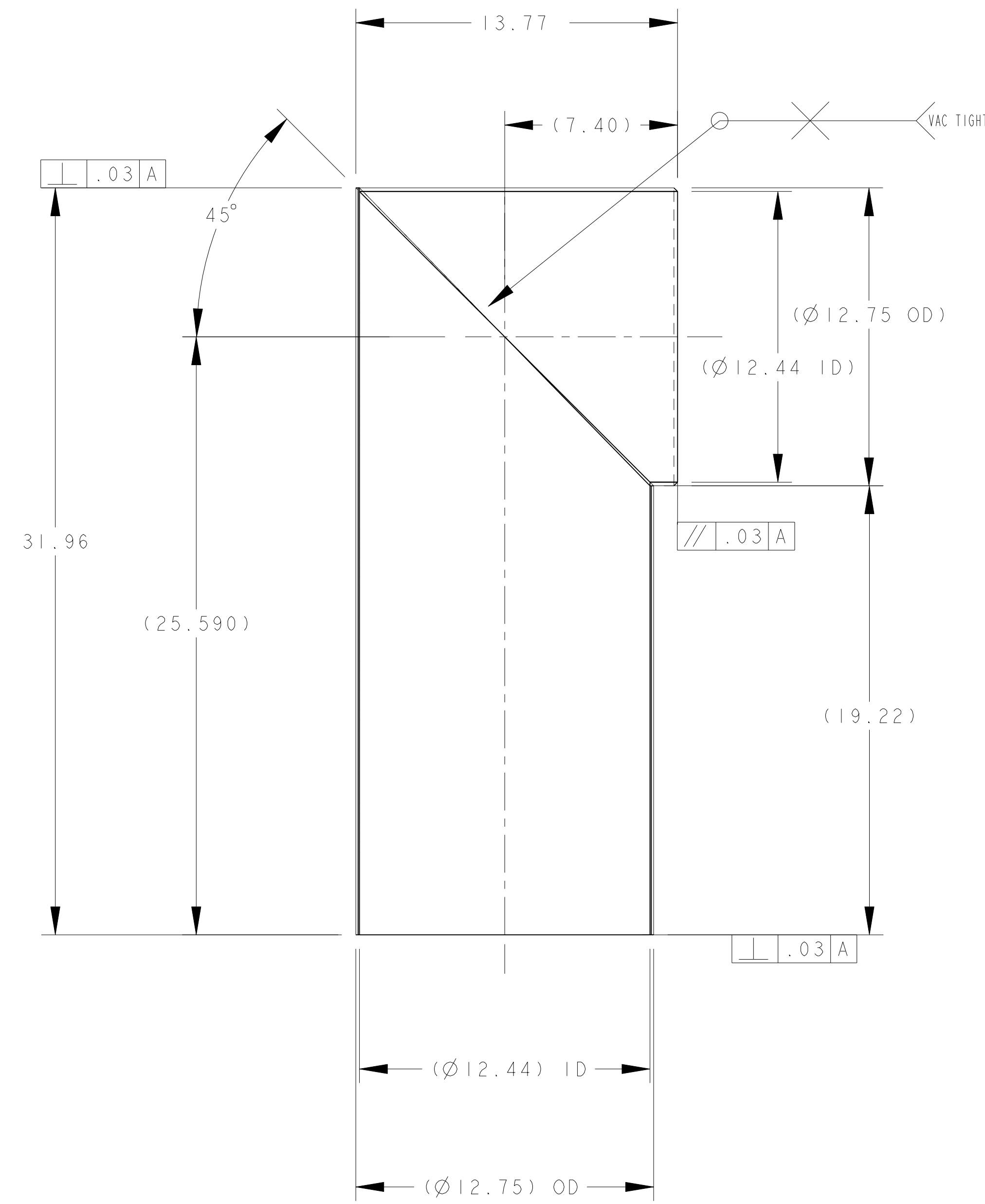

VAC TIGHT

BEVEL 45° X .10 ALL OUTSIDE EDGES

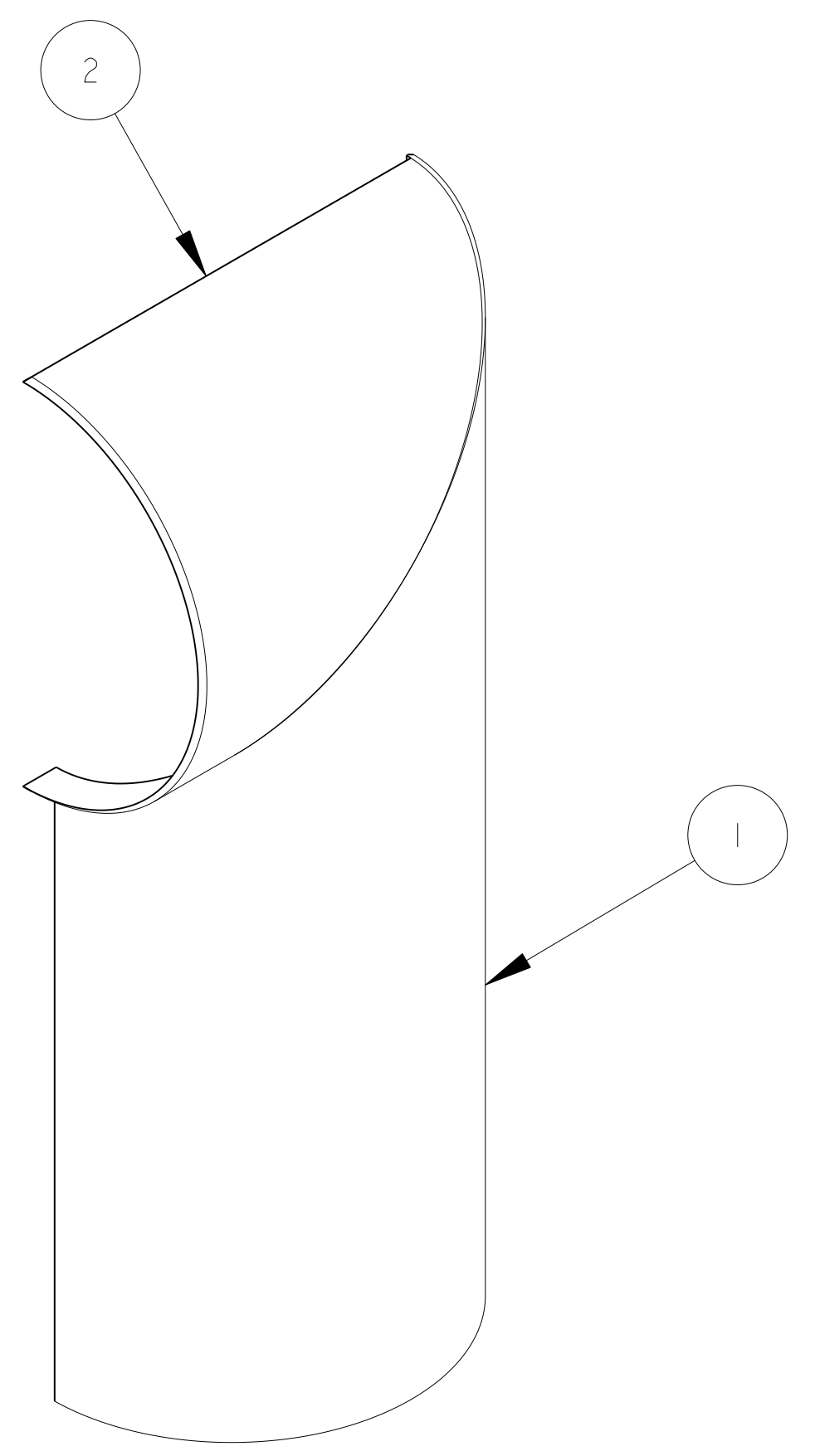

- NOTES: UNLESS OTHERWISE SPECIFIED,
- DIMENSIONS AND TOLERANCING PER ANSI Y14.5M-1982 UNITS ARE IN INCHES UNLESS OTHERWISE SPECIFIED.
 - USE OF SULFUR OR SILICONE BEARING OILS, LUBRICANTS, OR COOLANTS ARE STRICTLY PROHIBITED
 - USE OF RESIN OR RUBBER BONDED ABRASIVES UNDER POWER IS STRICTLY PROHIBITED. USE VITREOUS BONDED ABRASIVES ONLY.
 - CLEAN AFTER MACHINING PER VENDOR SPECIFICATION; SUBJECT TO LBNL APPROVAL.
 - VENDOR SUGGESTED CHANGES TO WELD PREPS; SUBJECT TO LBNL APPROVAL.
 - WELDS PER VENDOR PROCEDURES; SUBJECT TO LBNL APPROVAL.
 - PROTECT FINISHED PART BY BAGGING OR SIMILAR METHOD TO PROTECT AND MAINTAIN CLEANLINESS DURING SHIPMENT AND STORAGE.
 - VENDOR SUGGESTED CHANGES TO TOLERANCES TO FACILITATE ASSEMBLY; SUBJECT TO LBNL APPROVAL
 - ESTIMATED WEIGHT = 33 LBS

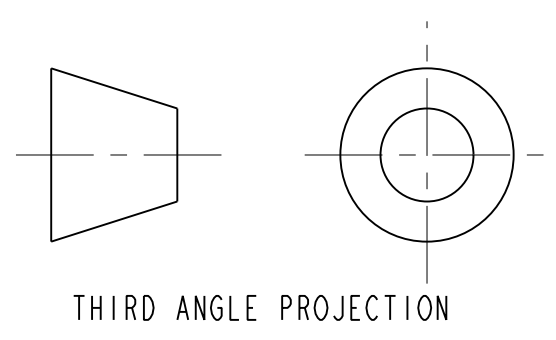

TOLERANCES		UNLESS OTHERWISE SPECIFIED		SHOP ORDERS		SER. NO. -		ERNEST ORLANDO LAWRENCE		
X.X ± 0.1	FRAC. ± 1/64	X.X ± 0.1	FRAC. ± 1/64	ACCT. NO.	NO.	NO.	DATE	BERKELEY NATIONAL LABORATORY		
X.XX ± 0.03	Angles ± 1.00°	X.XX ± 0.03	Angles ± 1.00°	DEL. TO	ISSD	ISSD	DATE	UNIVERSITY OF CALIFORNIA - BERKELEY		
X.XXX ± 0.010	FINISH 125 \sqrt{Ra}	X.XXX ± 0.010	FINISH 125 \sqrt{Ra}	SURFACE TREATMT	RECD	RECD	DATE	LHC IR FEEDBOX		
DO NOT SCALE PRINT				PROJECT TAG		PROJECT NUMBER		VACUUM		
THREADS ARE CLASS 2				IDENT. METHOD		PROJECT NAME		ENCLOSURE CHIMNEY HALF 1, JC2		
CHAMFER ENDS OF ALL SCREW TREADS 30°				PROJECT NUMBER		PROJECT NAME		MICROFILMED: ASSEM VARIOUS		
CUT ROUND, 1.5 THREAD RELIEF ON MACHINED THREADS				DWG. BY A. Zachoszcz		DATE 28-Nov-01		SCALE: 1/4		
BREAK EDGES .016 MAX. ON MACHINED WORK				CHK. BY Jon Zbasnik		DATE 4/2/02		DO NOT SCALE PRINTS		
REMOVE BURRS, WELD SPLATTER & LOOSE SCALE				APR. BY Jon Zbasnik		DATE 4/2/02		SHEET 1 OF 1		
IN ACCORDANCE WITH ASME Y14.5M & B46.1				REV. DWG		CHG. ZONE		DATE		
A		JDR	DPO	11/06/02	INITIAL RELEASE					DWG. NO. 2515784
A		CHG. ZONE		DATE		CHANGES		REV. A		