

NAME: ARHARRIS OBJECT: 251551 DATE: 25-Nov-02 14:30:36

NOTES: (UNLESS OTHERWISE SPECIFIED)

1. THIS IS A CRYOGENIC VACUUM COMPONENT.
2. WELDING PROCEDURE: PER VENDOR SPECIFICATION WITH LBNL APPROVAL.
3. CLEANING PROCEDURE : PER VENDOR SPECIFICATION WITH LBNL APPROVAL.
4. PACKAGING AND STORAGE PROCEDURE OF THE COMPONENTS: PER VENDOR SPECIFICATION WITH LBNL APPROVAL.
5. DIMENSIONS AND TOLERANCING PER ANSI Y14.5M-1982. UNITS ARE IN INCHES UNLESS OTHERWISE SPECIFIED.
6. USE OF SULFUR OR SILICONE BEARING OILS, LUBRICANTS, OR COOLANTS ARE STRICTLY PROHIBITED.
7. USE OF RESIN OR RUBBER BONDED ABRASIVES UNDER POWER IS STRICTLY PROHIBITED. USE VITREOUS BONDED ABRASIVES ONLY.
8. VENDOR SUGGESTED CHANGES TO WELD PREPS; SUBECT TO LBNL APPROVAL.
9. ELBOWS MAY BE USED ON THE TUBE BENDS AS NEEDED.
10. COMPOUND BENDS MAY BE MADE TO TWO SEPARATE BENDS UPON LBNL APPROVAL.
11. VENDOR SUGGESTED CHANGES TO TOLERANCES TO FACILITATE FABRICATION OR ASSEMBLY; SUBECT TO LBNL APPROVAL.
12. REMOVE ALL THE BURRS AND REAM THE ENDS FOR CIRCULARITY AND CLEAN ENDS.
13. TUBE END SURFACE MUST BE PERPENDICULAR TO THE TUBE AXIS WITHIN +/- .010.

DESCRIPTION	MATERIAL	MAT. LOCATION
TUBE, PER ASTM A269	SS 304L	-

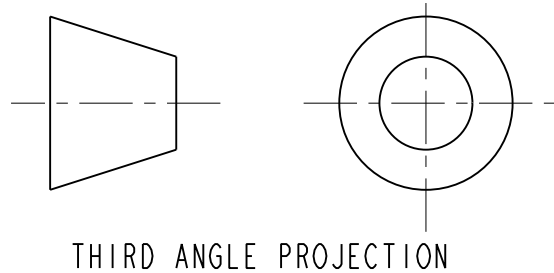
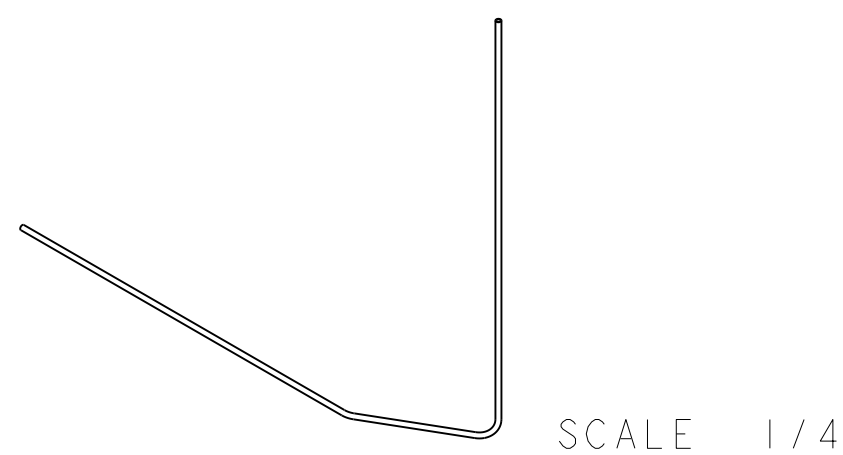
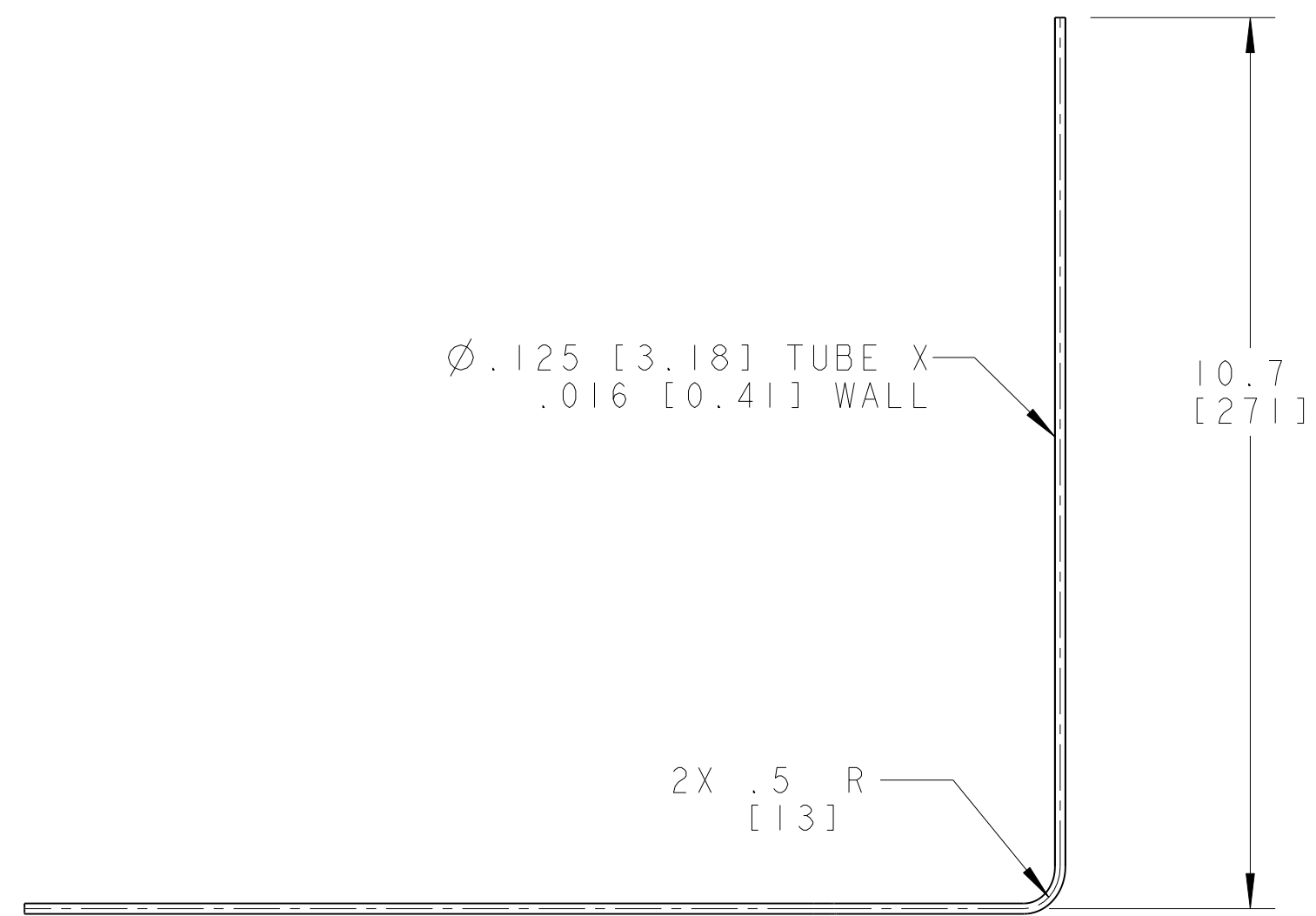
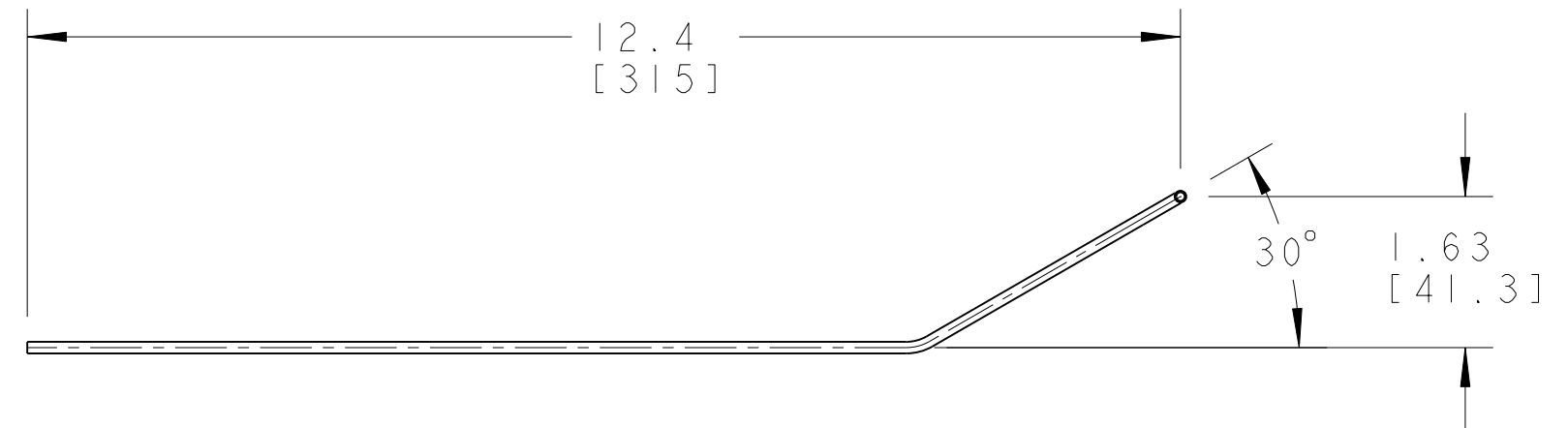

TOLERANCES				UNLESS OTHERWISE SPECIFIED		SHOP ORDERS		SER NO.
X.X ± 0.1	FRAC. ± 1/64	ACCT NO.		NO. RECD	DATE ISSD			
X.XX ± 0.03	Angles ± 1.00°	DEL TO		DATE RECD				
X.XXX ± 0.010	FINISH $\sqrt{25}$ (µin)	SURFACE TREATMT						
DO NOT SCALE PRINT				IDENT METHOD	TAG			
THREADS ARE CLASS 2				PROJECT NUMBER				
CHAMFER ENDS OF ALL SCREW THREADS 30°				PROJECT NAME	KILSBY ROBERTS			
CUT ROUND, 1.5 THREAD RELIEF ON MACHINED THREADS				DWG BY	KNOLLS	DATE	04-Nov-02	
BREAK EDGES .016 MAX. ON MACHINED WORK				CHK BY	Jon Zbasnik/S.Virostek	DATE	06-Nov-02	
REMOVE BURRS, WELD SPLATTER & LOOSE SCALE				APR BY	Jon Zbasnik/D.Oshatz	DATE	06-Nov-02	
IN ACCORDANCE WITH ASME Y14.5M & B46.1								

ERNEST ORLANDO LAWRENCE BERKELEY NATIONAL LABORATORY
UNIVERSITY OF CALIFORNIA - BERKELEY

LHC IR FEEDBOX
CRYOGENICS
TRANSDUCER TUBING

MICROFILMED:	DWG. TYPE	SHOWN ON	SCALE: 1/2	DO NOT SCALE PRINTS
	PART	-		
PATENT CLEAR:	DESIGN ACCT. NO.	CATEGORY CODE	DWG. NO.	SIZE
	Z5LCE2	LHC2003	2515513	A

REV	DWG	CHK	ZONE	DATE	CHANGES
A	ARH	SPV		11-06-02	INITIAL RELEASE

DWG. NO. 2515513 REV. A 1