

DESCRIPTION	MATERIAL	MAT. LOCATION
PIPE, HALVED	NEMA G10	

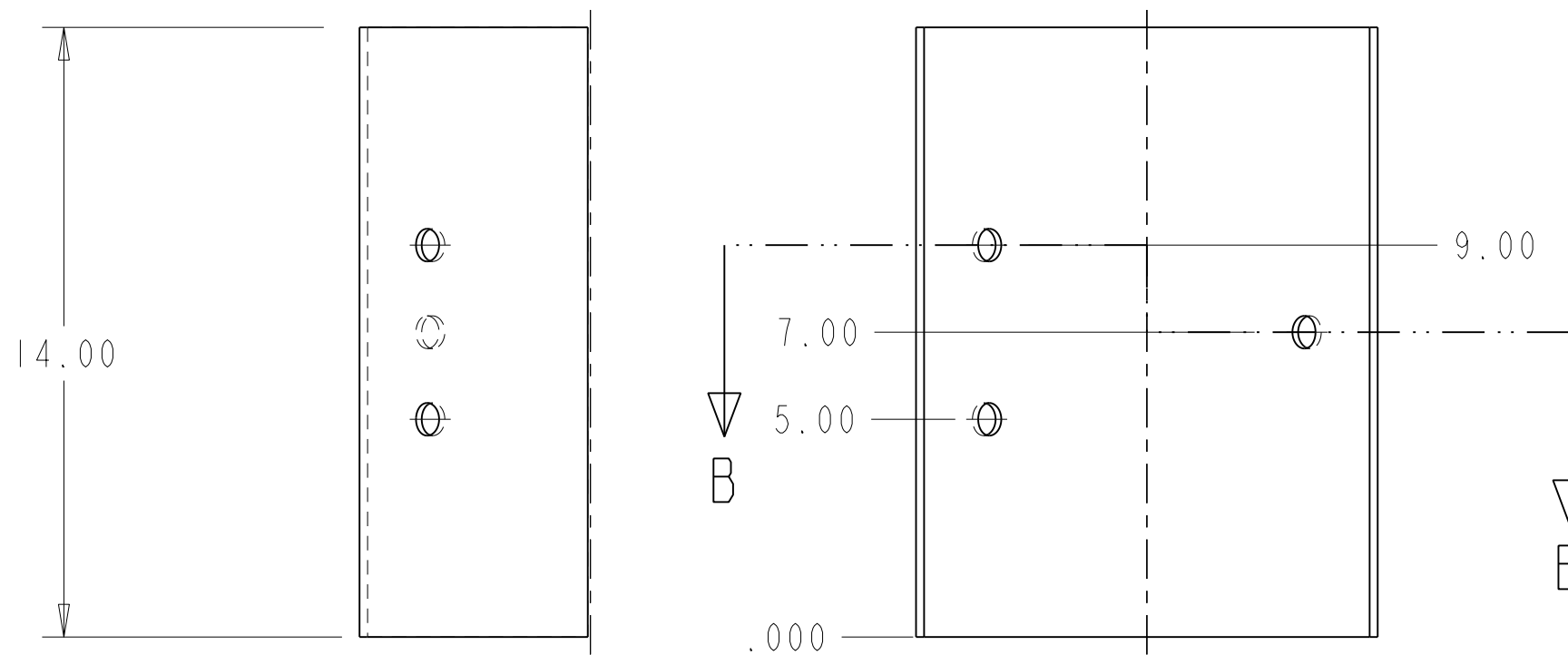

NOTES: (UNLESS OTHERWISE SPECIFIED)

- THIS IS A CRYOGENIC VACUUM COMPONENT.
- CLEANING PROCEDURE : PER VENDOR SPECIFICATION WITH LBNL APPROVAL.
- PACKAGING AND STORAGE PROCEDURE OF THE COMPONENTS: PER VENDOR SPECIFICATION WITH LBNL APPROVAL.
- DIMENSIONS AND TOLERANCING PER ANSI Y14.5M-1982. UNITS ARE IN INCHES UNLESS OTHERWISE SPECIFIED.
- USE OF SULFUR OR SILICONE BEARING OILS, LUBRICANTS, OR COOLANTS ARE STRICTLY PROHIBITED.
- USE OF RESIN OR RUBBER BONDED ABRASIVES UNDER POWER IS STRICTLY PROHIBITED. USE VITREOUS BONDED ABRASIVES ONLY.

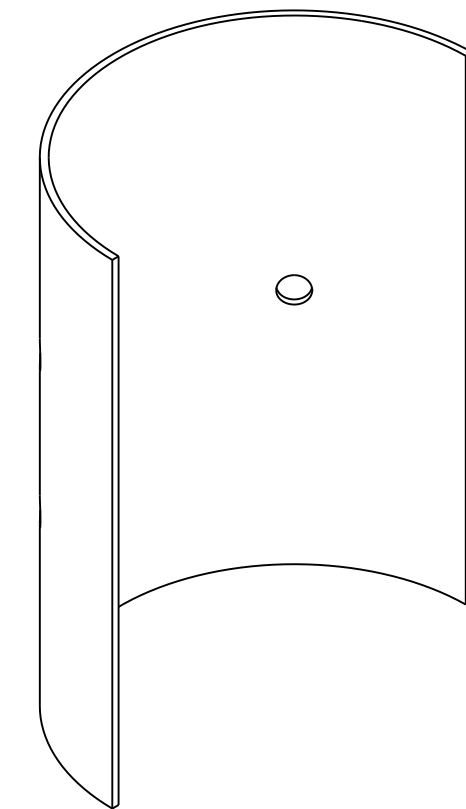
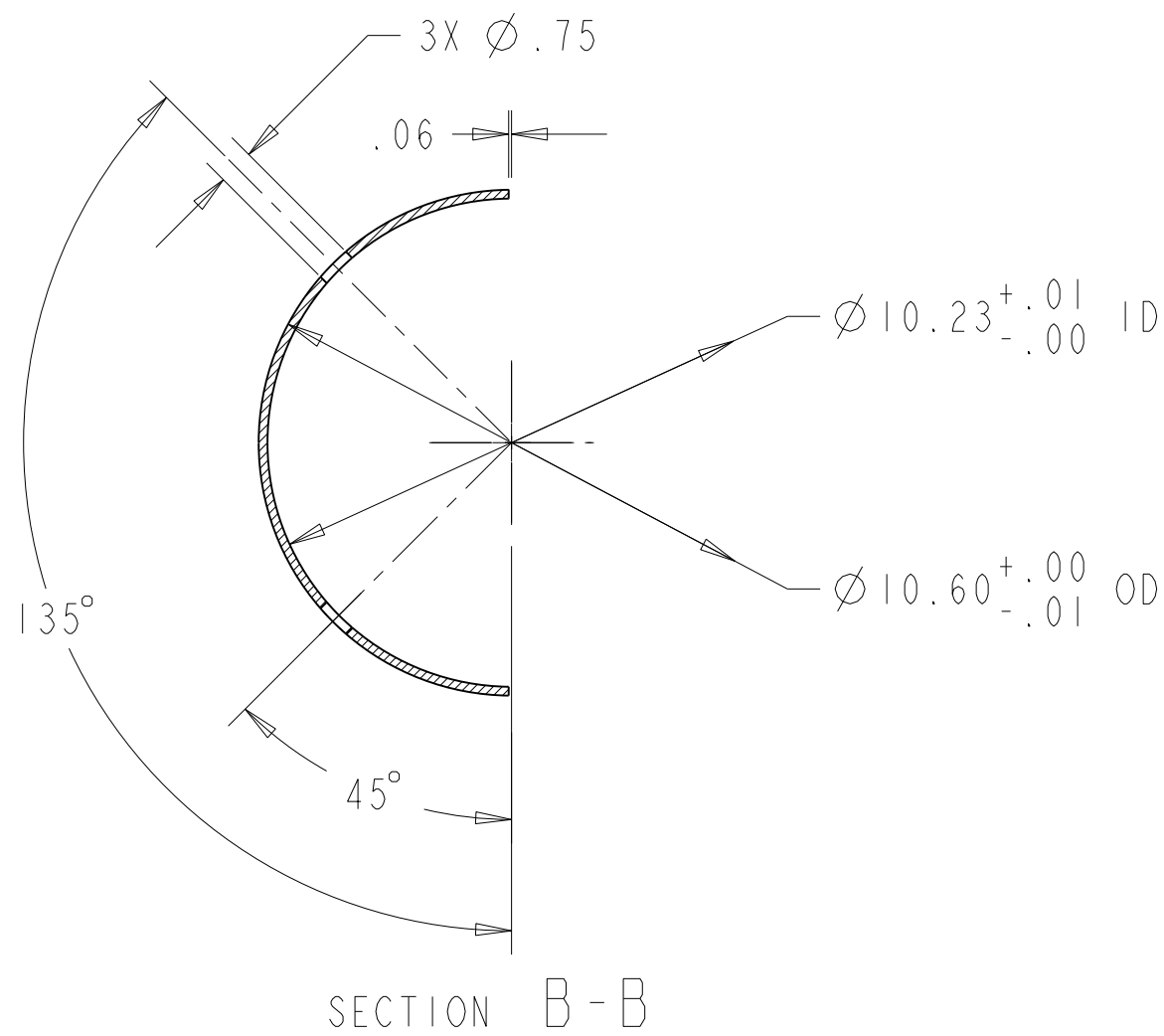
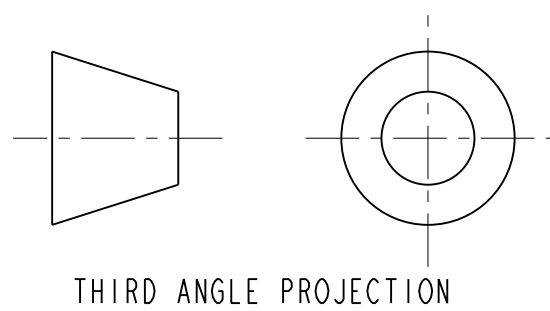

					UNLESS OTHERWISE SPECIFIED		SHOP ORDERS		SER. NO. -	
					TOLERANCES	X.X ± 0.1	FRAC. ± 1/64	ACCT. NO.	NO. RECD	DATE ISSD
						X.XX ± 0.03	Angles ± 1.00°	DEL TO		DATE RECD
						X.XXX ± 0.010	FINISH $\sqrt{25}$ (µin)	SURFACE TREATMT		
					DO NOT SCALE PRINT					
					THREADS ARE CLASS 2					
					CHAMFER ENDS OF ALL SCREW TREADS 30°					
					CUT ROUND, 1.5 THREAD RELIEF ON MACHINED THREADS					
					BREAK EDGES .016 MAX. ON MACHINED WORK					
					REMOVE BURRS, WELD SPLATTER & LOOSE SCALE					
					IN ACCORDANCE WITH ASME Y14.5M & B46.1					
					DWG BY R LA MANTIA		DATE 24-Jul-02		Mfg (Logo)	
					CHK BY S.Virostek		DATE 15-Nov-02		PATENT CLEAR:	
					APR BY OSHATZ		DATE 19-Sep-02		DESIGN ACCT. NO. Z5LCE3	
					PROJECT NAME N/A		PROJECT NUMBER N/A		CATEGORY CODE LH2003	
					PROJECT NUMBER N/A		PROJECT NAME N/A		SCALE: 0.250	
					PROJECT NAME N/A		PROJECT NUMBER N/A		DO NOT SCALE PRINTS	
					PROJECT NAME N/A		PROJECT NUMBER N/A		SHEET 1 OF 1	
					PROJECT NAME N/A		PROJECT NUMBER N/A		DWG. NO. 2514513	
					PROJECT NAME N/A		PROJECT NUMBER N/A		REV. A	

REV	DWG	CHK	ZONE	DATE	INITIAL RELEASE
A	RLM	SPV		11-15-02	CHANGES

ERNEST ORLANDO LAWRENCE BERKELEY NATIONAL LABORATORY
UNIVERSITY OF CALIFORNIA - BERKELEY

LHC IR FEEDBOX
CRYOGENICS
ORL ENCLOSURE, LONG, IP 5

MICROFILMED:	DWG. TYPE	SHOWN ON	SCALE: 0.250	DO NOT SCALE PRINTS
	PART	-		
PATENT CLEAR:	DESIGN ACCT. NO.	CATEGORY CODE	DWG. NO.	SIZE
	Z5LCE3	LH2003	2514513	A

DWG. NO. 2514513 REV. A 1

REV. 11/21/02 J. L. OSHATZ