

8

7

6

5

4

3

1

DWG. NO. 2513944 SIZE REV. SH. A 1

| ITEM | PART NO. | RECD | DESCRIPTION | MATERIAL |
|------|----------|------|-------------------|----------|
| 2 | - | - | RETAINER PLATE -2 | NEMA G10 |
| 1 | - | - | RETAINER PLATE -1 | NEMA G10 |

NOTES: UNLESS OTHERWISE SPECIFIED,

- DIMENSIONS AND TOLERANCING PER ANSI Y14.5M-1982 UNITS ARE IN INCHES UNLESS OTHERWISE SPECIFIED.
- USE OF SULFUR OR SILICONE BEARING OILS, LUBRICANTS, OR COOLANTS ARE STRICTLY PROHIBITED
- USE OF RESIN OR RUBBER BONDED ADRASIVES UNDER POWER IS STRICTLY PROHIBITED. USE VITREOUS BONDED ABRASIVES ONLY.
- THIS IS A HIGH VACUUM COMPONENT. CLEAN AFTER MACHINING USING A NON-ETCHING ALKALI BASED SOLUTION.
- PROTECT FINISHED PART BY BAGGING OR SIMILAR METHOD TO PROTECT AND MAINTAIN CLEANLINESS DURING SHIPMENT AND STORAGE.

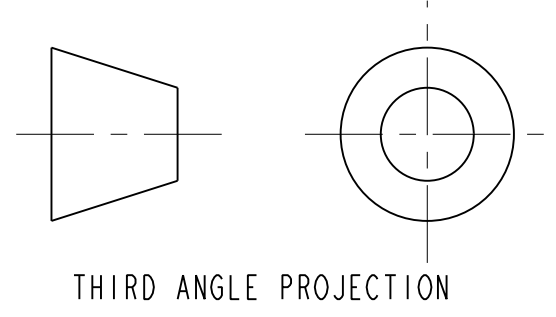
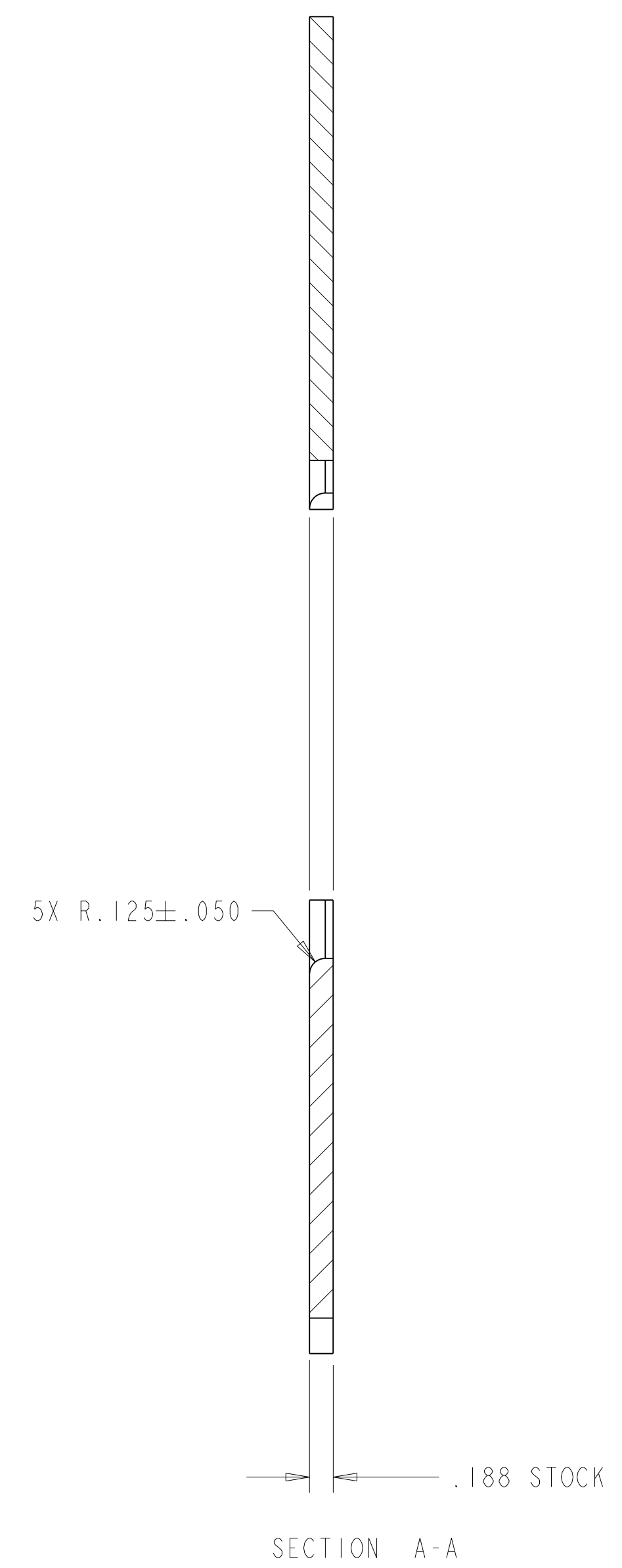
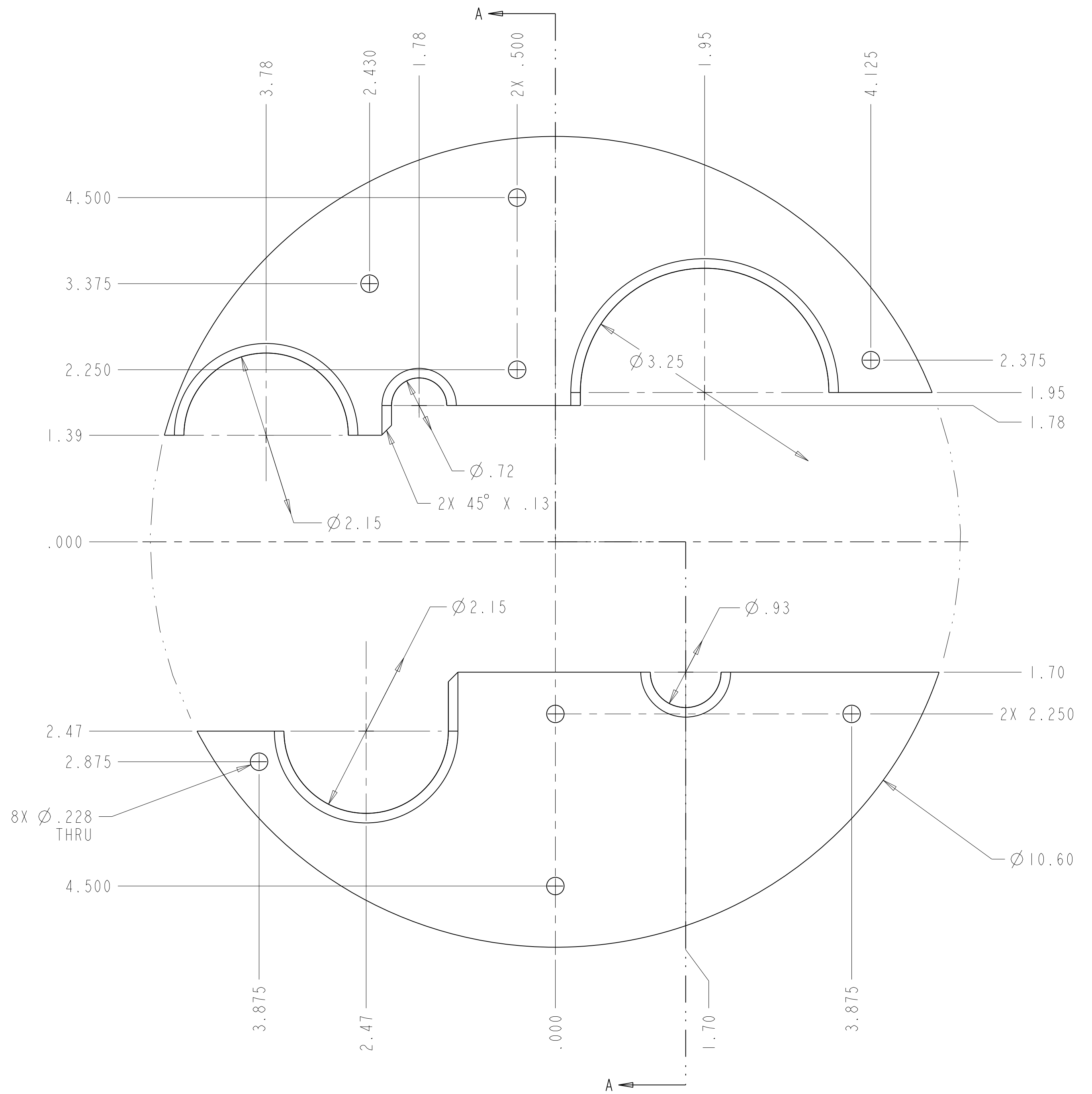

| REV | DWG | CHK | ZONE | DATE | INITIAL RELEASE | CHANGES |
|-----|-----|-----|------|----------|-----------------|---------|
| A | RLM | SPV | | 11-18-02 | | |

| TOLERANCES | | SHOP ORDERS | |
|---------------|------------------------|-------------|-----------|
| X.X ± 0.1 | FRAC. ± 1/64 | ACCT NO. | SER. NO. |
| X.XX ± 0.02 | Angles ± 1.00° | NO. RECD | DATE ISSD |
| X.XXX ± 0.005 | FINISH 125 \sqrt{Ra} | DEL TO | DATE RECD |

ERNEST ORLANDO LAWRENCE
BERKELEY NATIONAL LABORATORY
 UNIVERSITY OF CALIFORNIA - BERKELEY

LHC IR FEEDBOX
 CRYOGENICS
 RETAINER PLATE ASSEMBLY

MICROFILMED: [] DWG. TYPE: ASSEM SHOWN ON: 251201 SCALE: 1.000 DO NOT SCALE PRINTS

PATENT CLEAR: [] DESIGN ACCT. NO.: Z5LCE3 CATEGORY CODE: LH2003

DWG. NO. 2513944 SIZE REV. A

8

7

6

5

4

3

2

1