

NOTES: UNLESS OTHERWISE SPECIFIED,

1. DIMENSIONS AND TOLERANCING PER ANSI Y14.5M-1982 UNITS ARE IN INCHES UNLESS OTHERWISE SPECIFIED.
2. USE OF SULFUR OR SILICONE BEARING OILS, LUBRICANTS, OR COOLANTS ARE STRICTLY PROHIBITED
3. USE OF RESIN OR RUBBER BONDED ABRASIVES UNDER POWER IS STRICTLY PROHIBITED. USE VITREOUS BONDED ABRASIVES ONLY.
4. THIS IS A HIGH VACUUM COMPONENT. CLEAN AFTER MACHINING USING A NON-ETCHING ALKALI BASED SOLUTION.
5. PROTECT FINISHED PART BY BAGGING OR SIMILAR METHOD TO PROTECT AND MAINTAIN CLEANLINESS DURING SHIPMENT AND STORAGE.

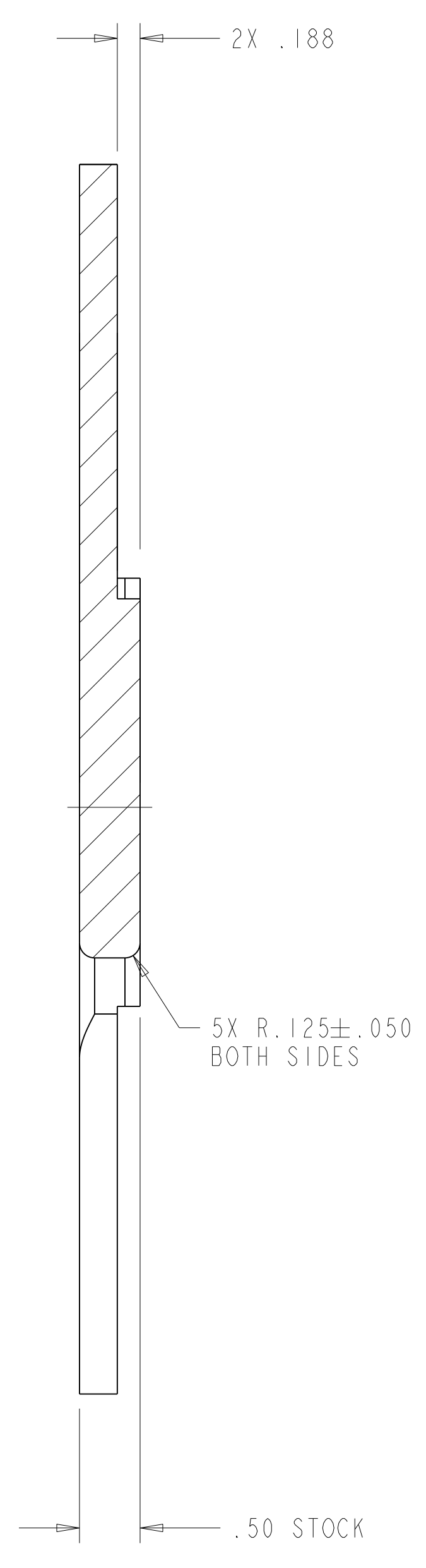

SECTION A-A

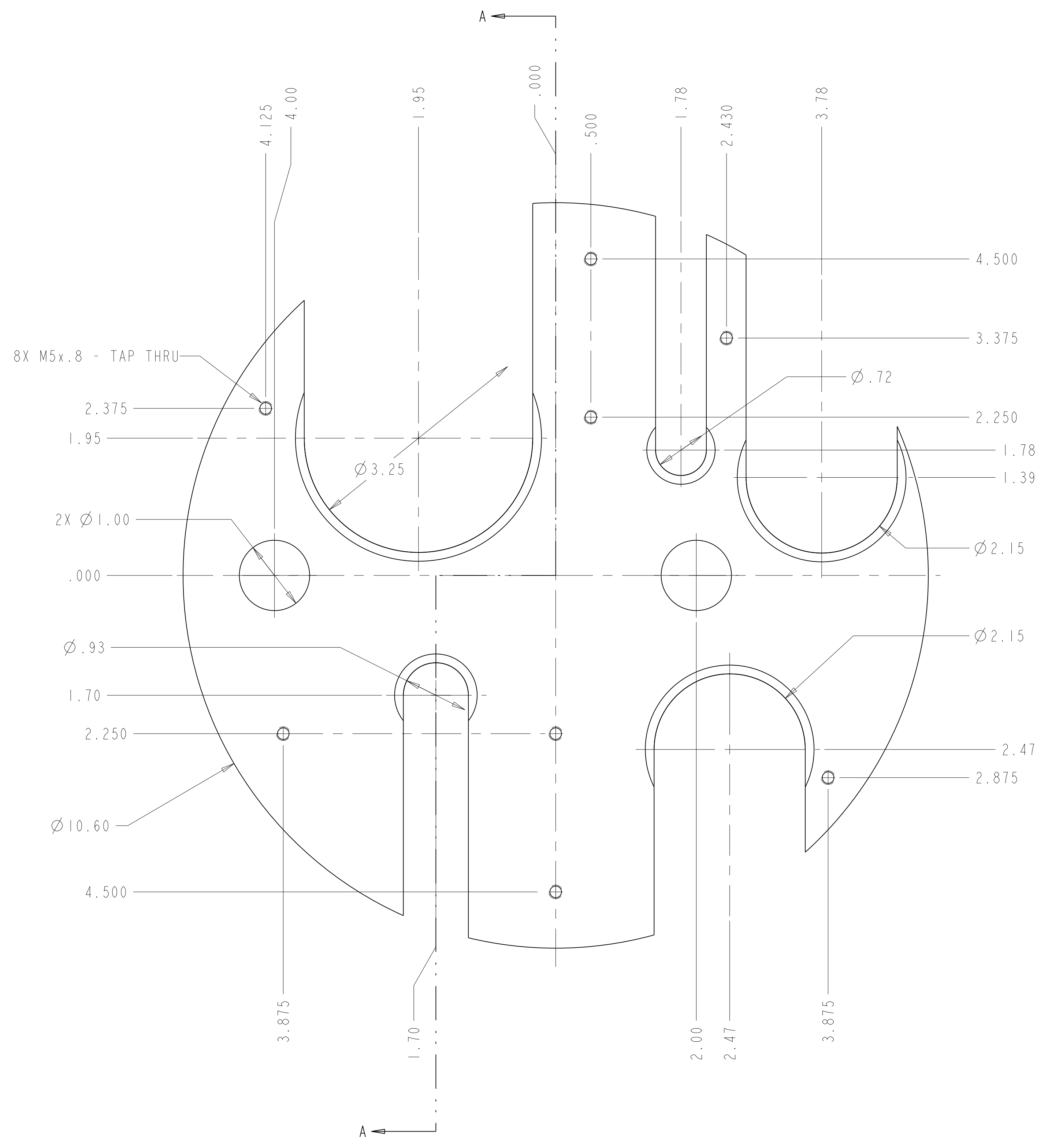
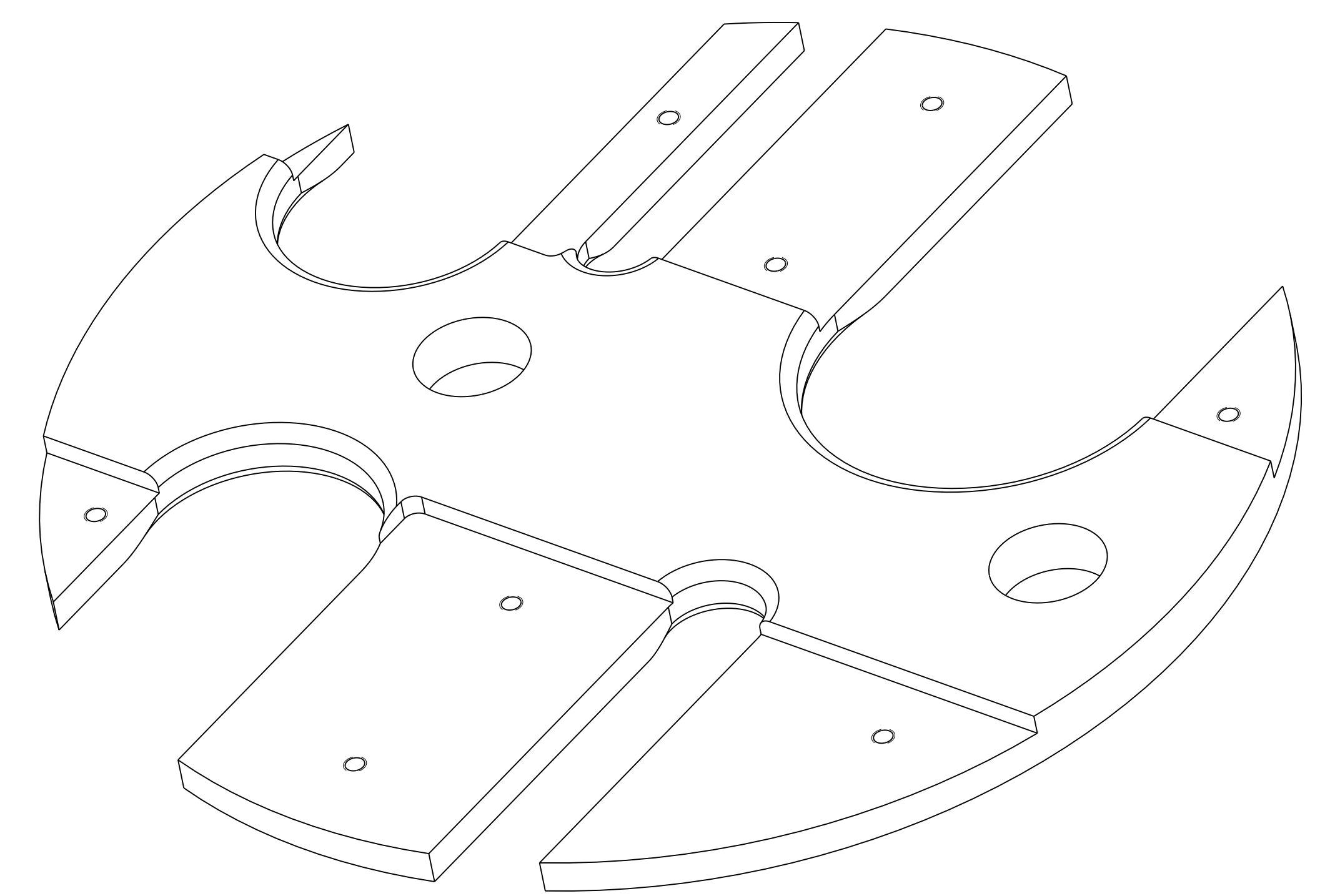
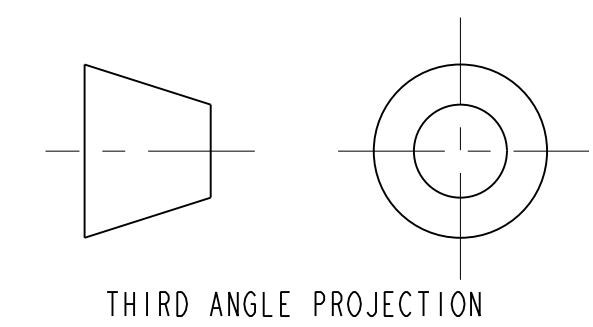
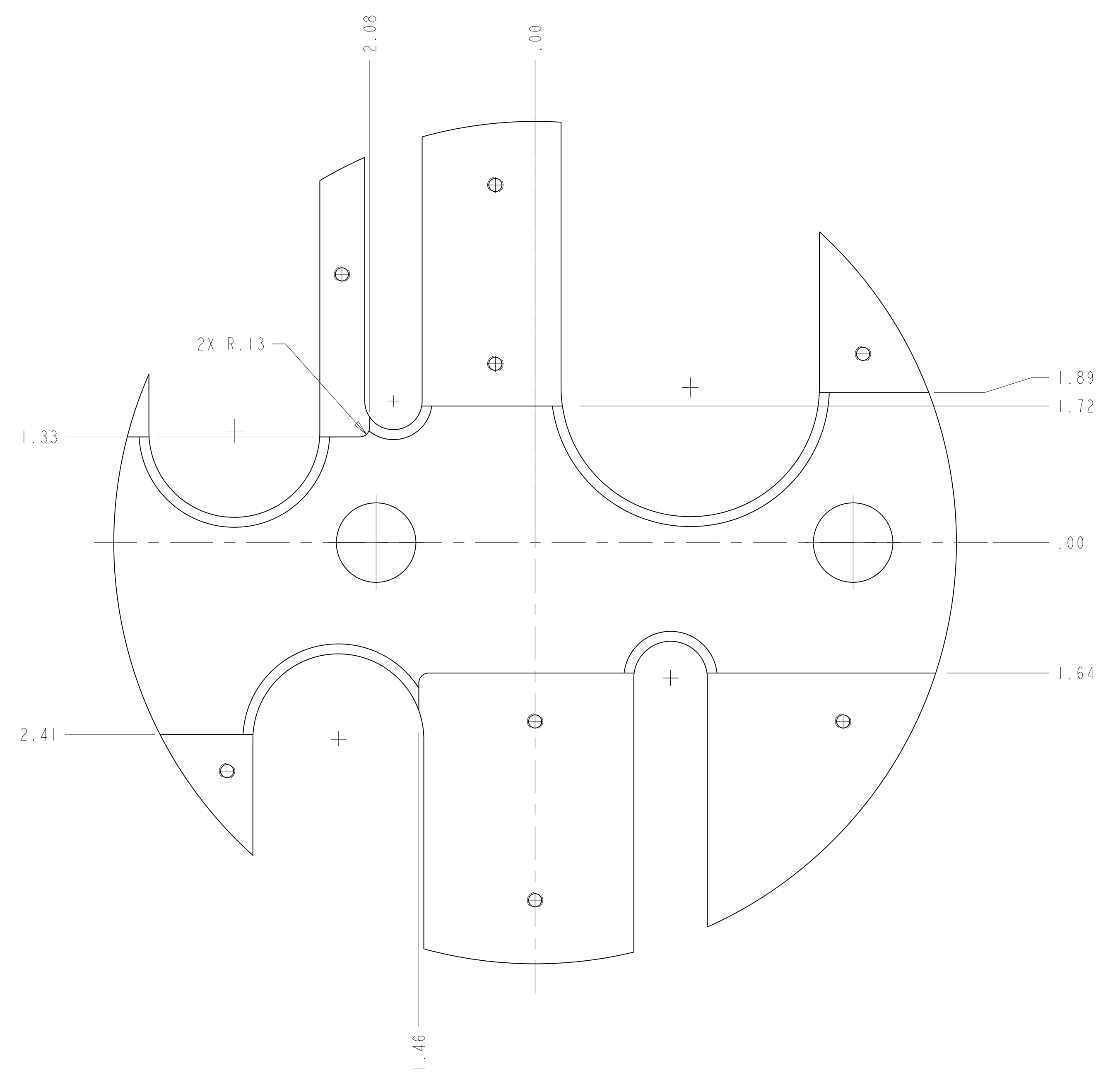

UNLESS OTHERWISE SPECIFIED		SHOP ORDERS		MATERIAL		MAT. LOCATION	
TOLERANCES	X.X ± 0.1	FRACTION	± 1/64	NO.			
	X.XX ± 0.03	ANGLE	± 1.00°	DATE			
	X.XXX ± 0.010	FINISH	125 μm	REQD.			
DO NOT SCALE PRINT		SURFACE TREATMENT					
THREADS ARE CLASS 2		IDENT. TAG					
CHAMFER ENDS OF ALL SCREW THREADS 30°		PROJECT					
CUT ROUNDS, 1.5 THREAD RELIEF ON MACHINED THREADS		NO.					
BREAK EDGES .015 MAX. ON MACHINED WORK		DATE	15-Nov-02				
REMOVE BURRS, WELD SPATTER & LOOSE SCALE		DATE	18-Nov-02				
IN ACCORDANCE WITH ADAP 114.5M 1 ENCL 1		DATE	18-Nov-02				

REV	DWG	CHK	ZONE	DATE	INITIAL RELEASE	CHANGES
A	RLM	SPV		11-18-02		

DESCRIPTION	MATERIAL	MAT. LOCATION
PLATE	NEMA G10	

ERNEST ORLANDO LAWRENCE		UNIVERSITY OF CALIFORNIA - BERKELEY	
LHC IR FEEDBOX	CRYOGENICS	SUPPORT PLATE	
MICROFILMED:	DWG. TYPE	SHOWN ON	SCALE: 1.000
PART	251201		
PATENT CLEAR:	DESIGN ACCT. NO.	CATEGORY CODE	DWG. NO.
ZSLCE3	LH2003		2513936

2513936 A 1  
 SHEET 1 OF 1  
 ERNEST ORLANDO LAWRENCE UNIVERSITY OF CALIFORNIA - BERKELEY