

NOTES: UNLESS OTHERWISE SPECIFIED,

1. DIMENSIONS AND TOLERANCING PER ANSI Y14.5M-1982 UNITS ARE IN INCHES UNLESS OTHERWISE SPECIFIED.
2. USE OF SULFUR OR SILICONE BEARING OILS, LUBRICANTS, OR COOLANTS ARE STRICTLY PROHIBITED.
3. USE OF RESIN OR RUBBER BONDED ADRASIVES UNDER POWER IS STRICTLY PROHIBITED. USE VITREOUS BONDED ABRASIVES ONLY.
4. THIS IS A HIGH VACUUM COMPONENT. CLEAN AFTER MACHINING USING A NON-ETCHING ALKALI BASED SOLUTION.
5. PROTECT FINISHED PART BY BAGGING OR SIMILAR METHOD TO PROTECT AND MAINTAIN CLEANLINESS DURING SHIPMENT AND STORAGE.

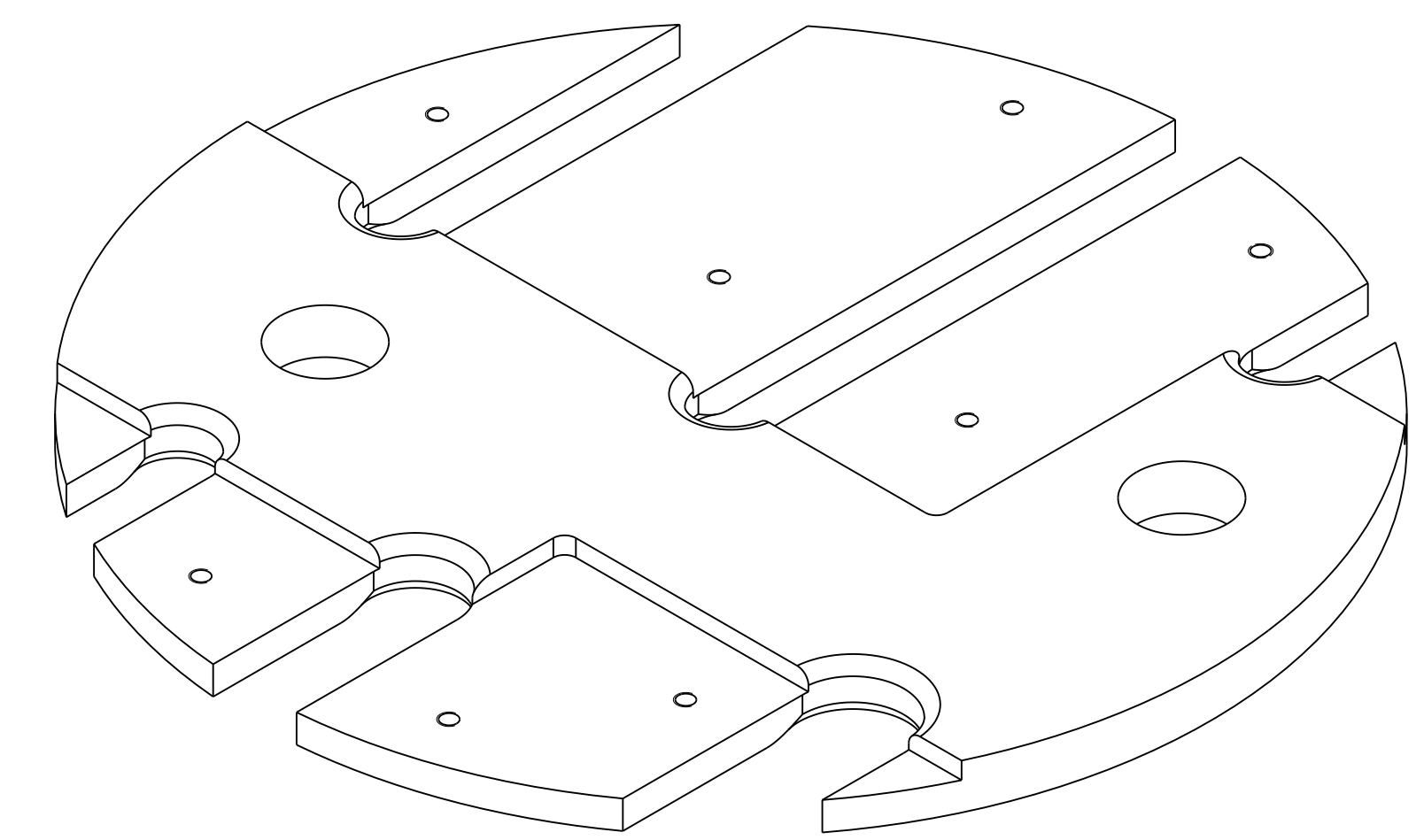

SCALE 3/4

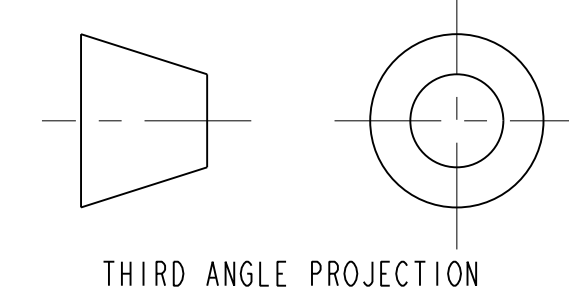
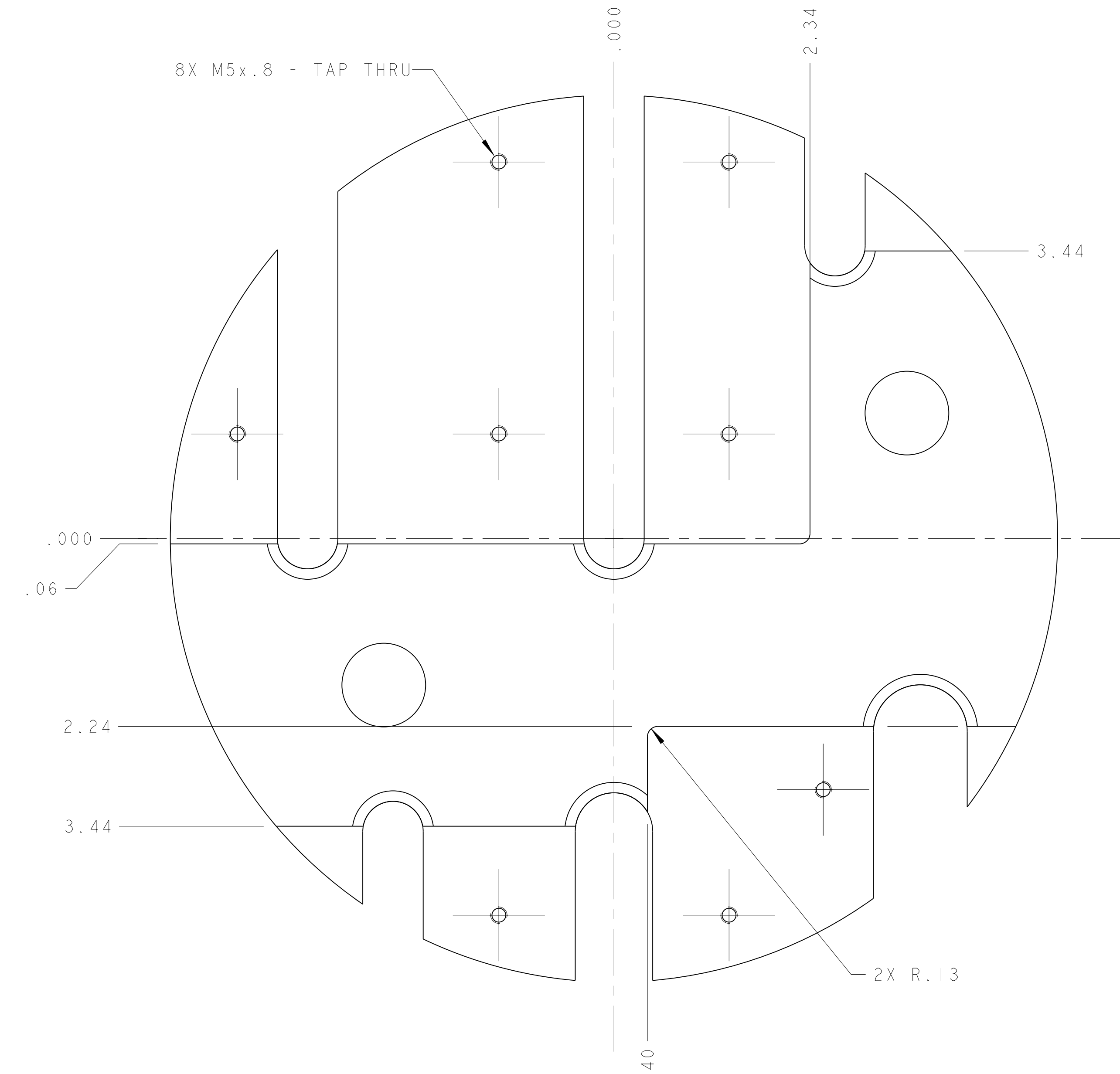
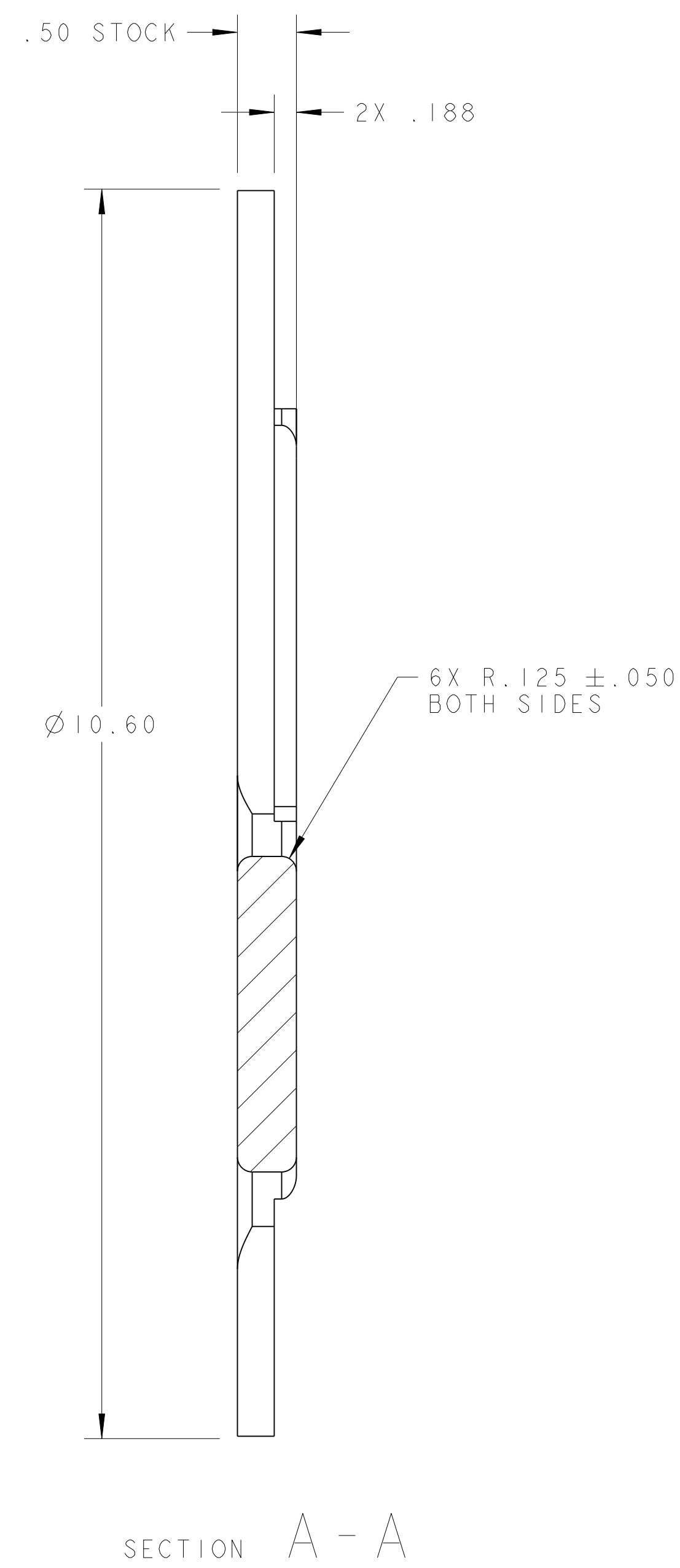
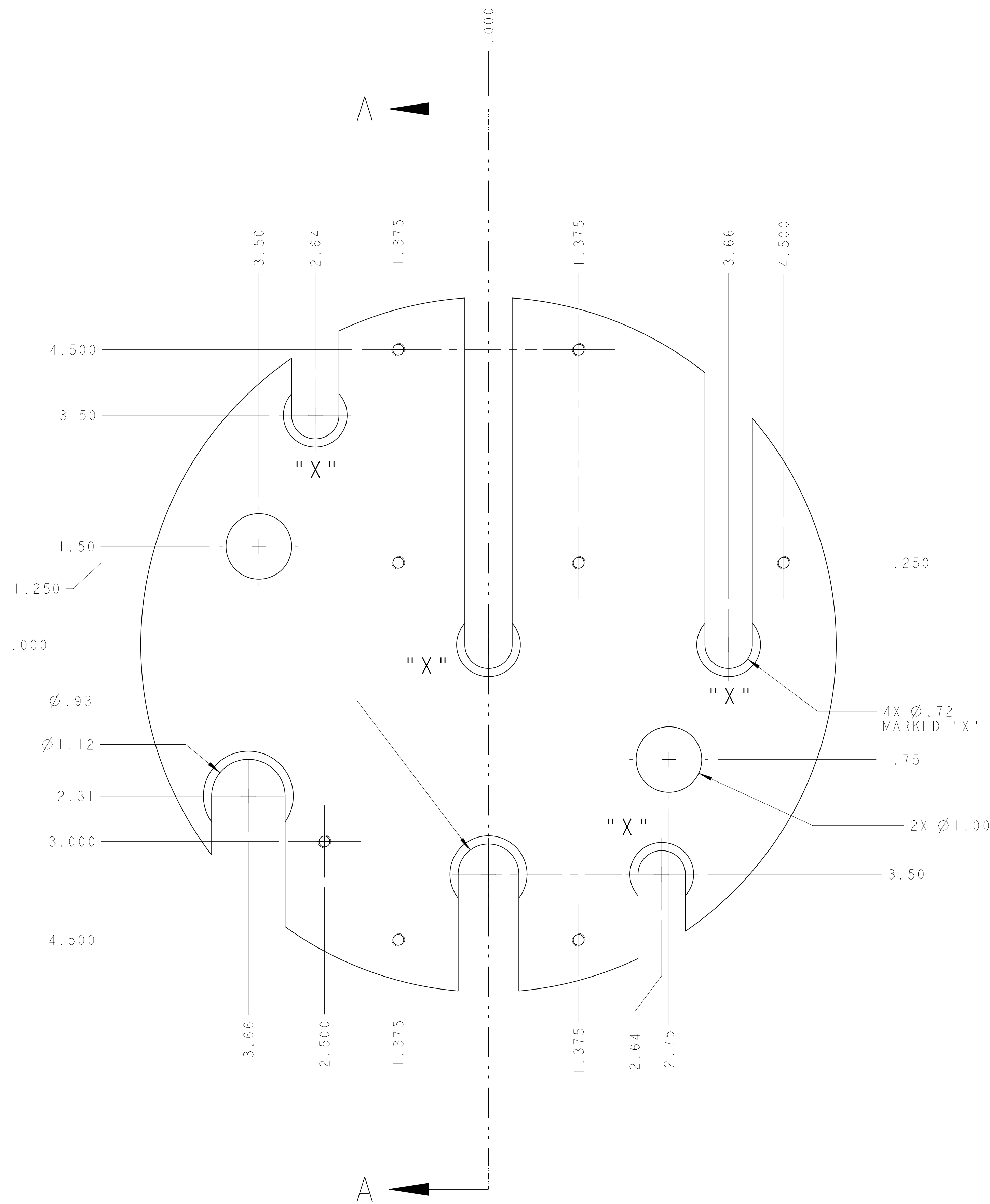

THIRD ANGLE PROJECTION

SUPPORT PLATE		NEMA 610		-	
DESCRIPTION		MATERIAL		MAT. LOCATION	
ERNEST ORLANDO LAWRENCE BERKELEY NATIONAL LABORATORY UNIVERSITY OF CALIFORNIA - BERKELEY					
LHC IR FEEDBOX		CRYOGENICS		SUPPORT PLATE	
REV	DWG	CHK	ZONE	DATE	CHANGES
A	ARH	SPV		11-14-02	INITIAL RELEASE
CHANGES					
UNLESS OTHERWISE SPECIFIED		SHOP ORDERS		SEA	
TOLERANCES		X.X ± 0.1 FRACTION		NO	
X.XX ± 0.02 ANGLES		± 1.00°		NO	
X.XXX ± 0.005 FINISH		125		NO	
DO NOT SCALE PRINT		SURFACE TREATMENT		NO	
THREADS ARE CLASS 2		IDENTIFY TAG		NO	
CHAMFER ENDS OF ALL SCREW THREADS 30°		PROJECT		NO	
CUT ROUNDS, 1.5 THREAD BELLETS ON MACHINED THREADS		DATE		NOV-01	
BREAK EDGES .015 MAX. ON MACHINED WORK		DATE		NOV-02	
REMOVE BURRS, WELD SPATTER & LOOSE SCALE		DATE		NOV-02	
IN ACCORDANCE WITH ADME 114.5M 1 ENG. 1		DATE		NOV-02	
MICROFILMED:		DWG. TYPE:		SCALE: 1/1	
PART		PART		SHEET 1 OF 1	
DESIGN ACCT. NO. ZSLCE2		CATEGORY CODE LH2003		DWG. NO. 2513916	
REV		REV		REV	
A		A		A	

2513916 A 1
 SHEET 1 OF 1
 ERNEST ORLANDO LAWRENCE
 UNIVERSITY OF CALIFORNIA - BERKELEY