

NOTES: UNLESS OTHERWISE SPECIFIED,

1. DIMENSIONS AND TOLERANCING PER ANSI Y14.5M-1982 UNITS ARE IN INCHES UNLESS OTHERWISE SPECIFIED.
2. USE OF SULFUR OR SILICONE BEARING OILS, LUBRICANTS, OR COOLANTS ARE STRICTLY PROHIBITED
3. USE OF RESIN OR RUBBER BONDED ADRASIVES UNDER POWER IS STRICTLY PROHIBITED. USE VITREOUS BONDED ABRASIVES ONLY.
4. THIS IS A HIGH VACUUM COMPONENT. CLEAN AFTER MACHINING USING A NON-ETCHING ALKALI BASED SOLUTION.
6. PROTECT FINISHED PART BY BAGGING OR SIMILAR METHOD TO PROTECT AND MAINTAIN CLEANLINESS DURING SHIPMENT AND STORAGE.

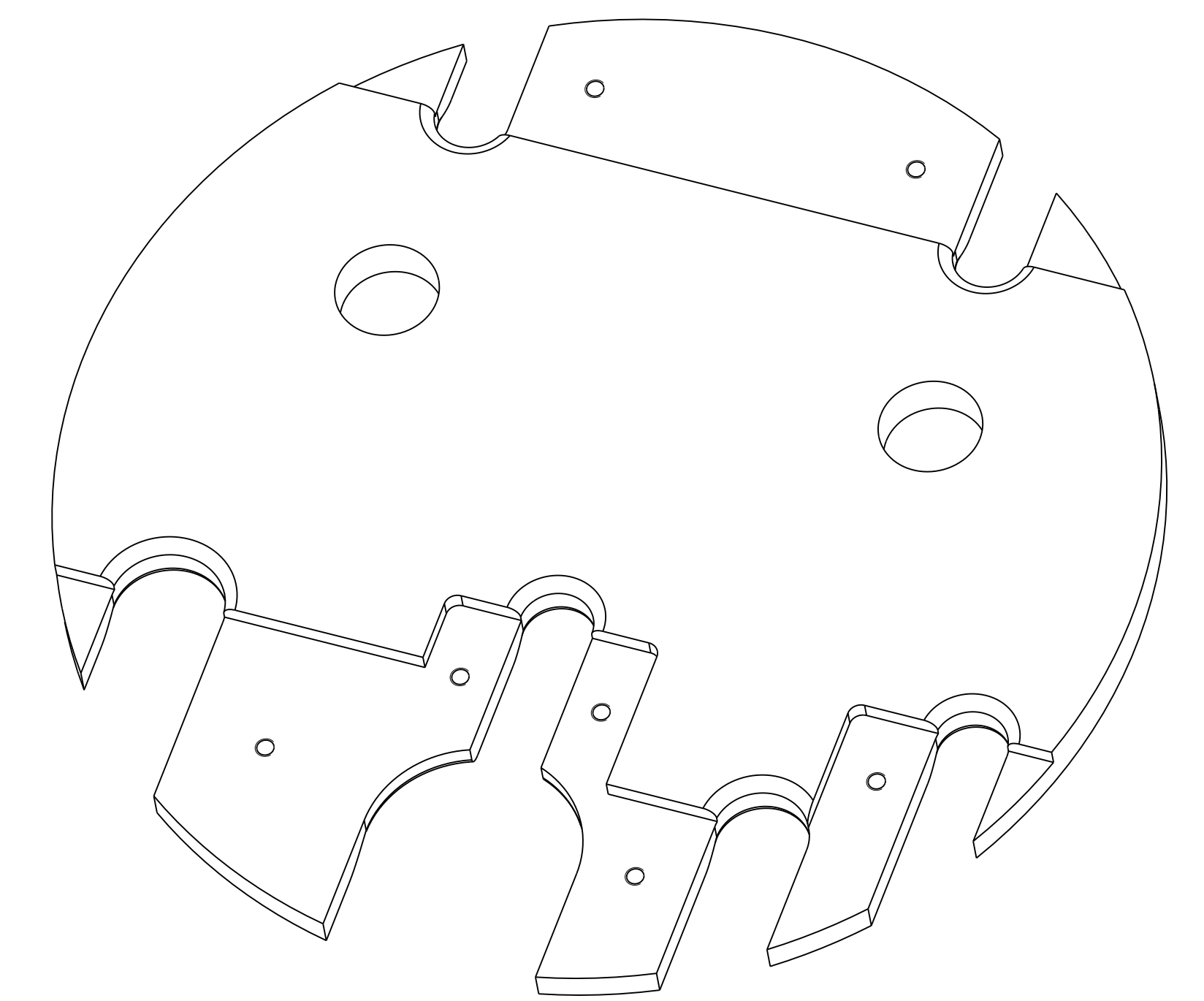

SCALE 3/4

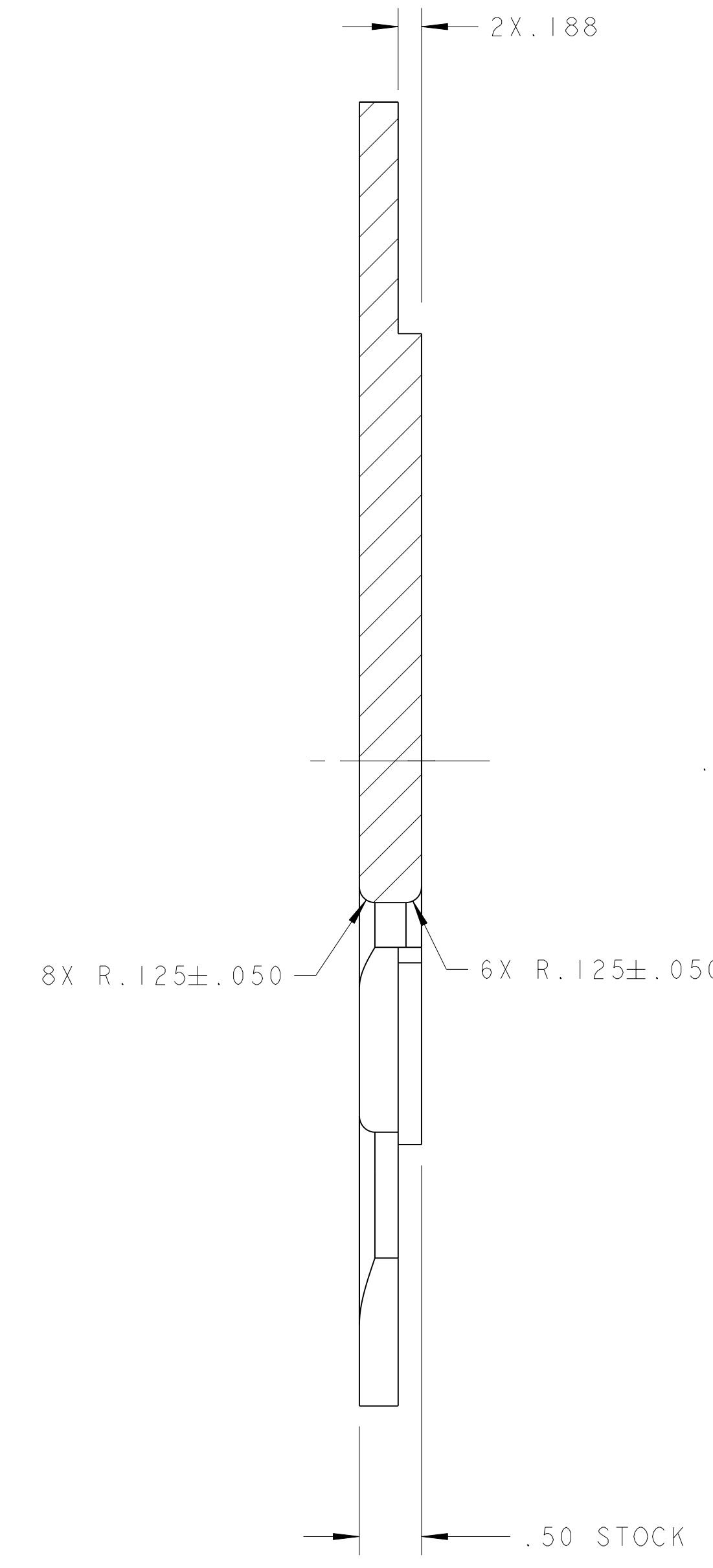
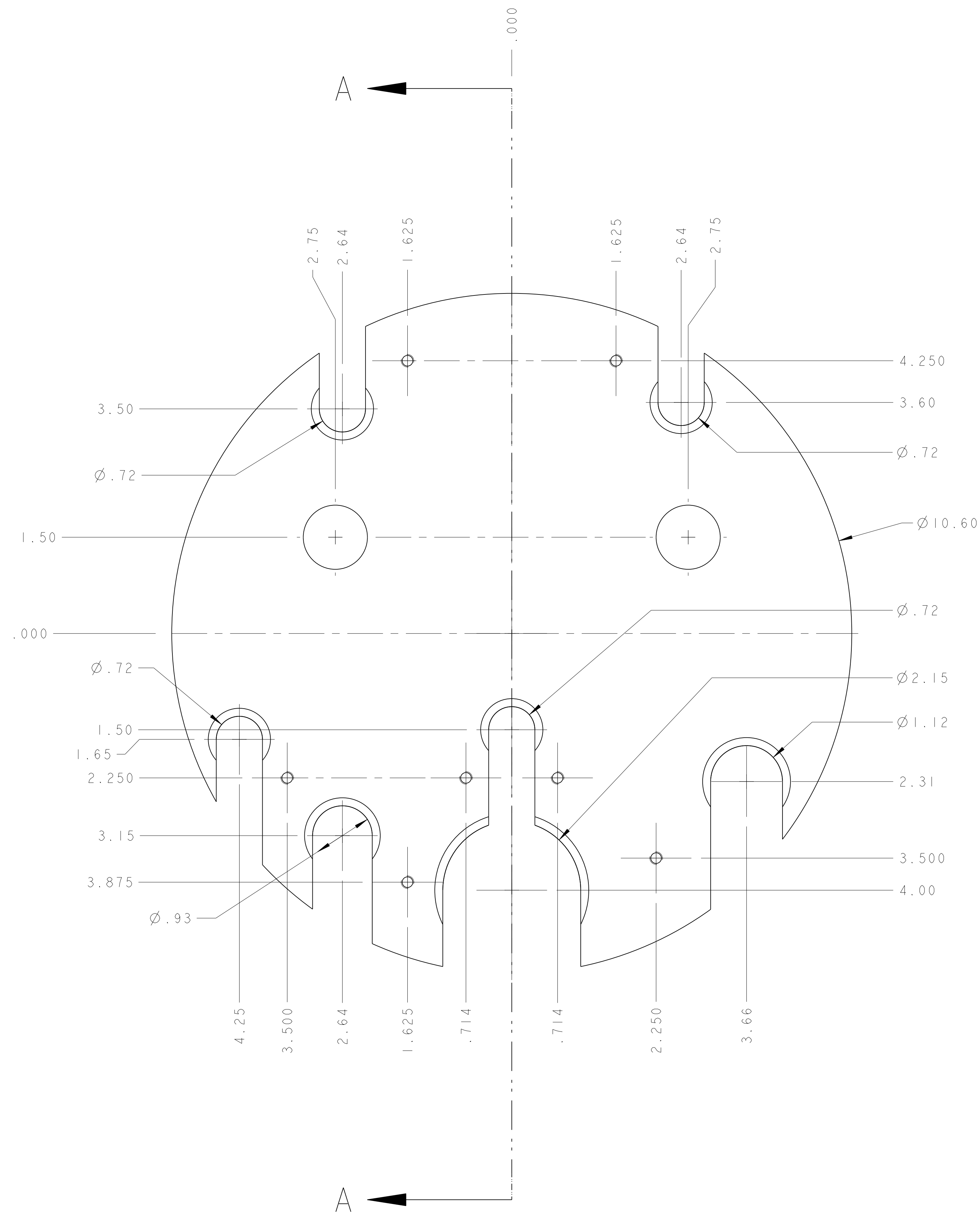

SECTION A - A

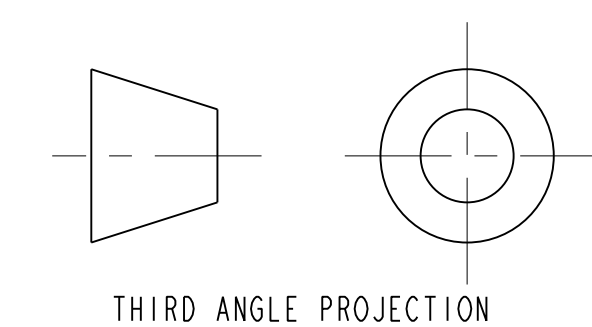
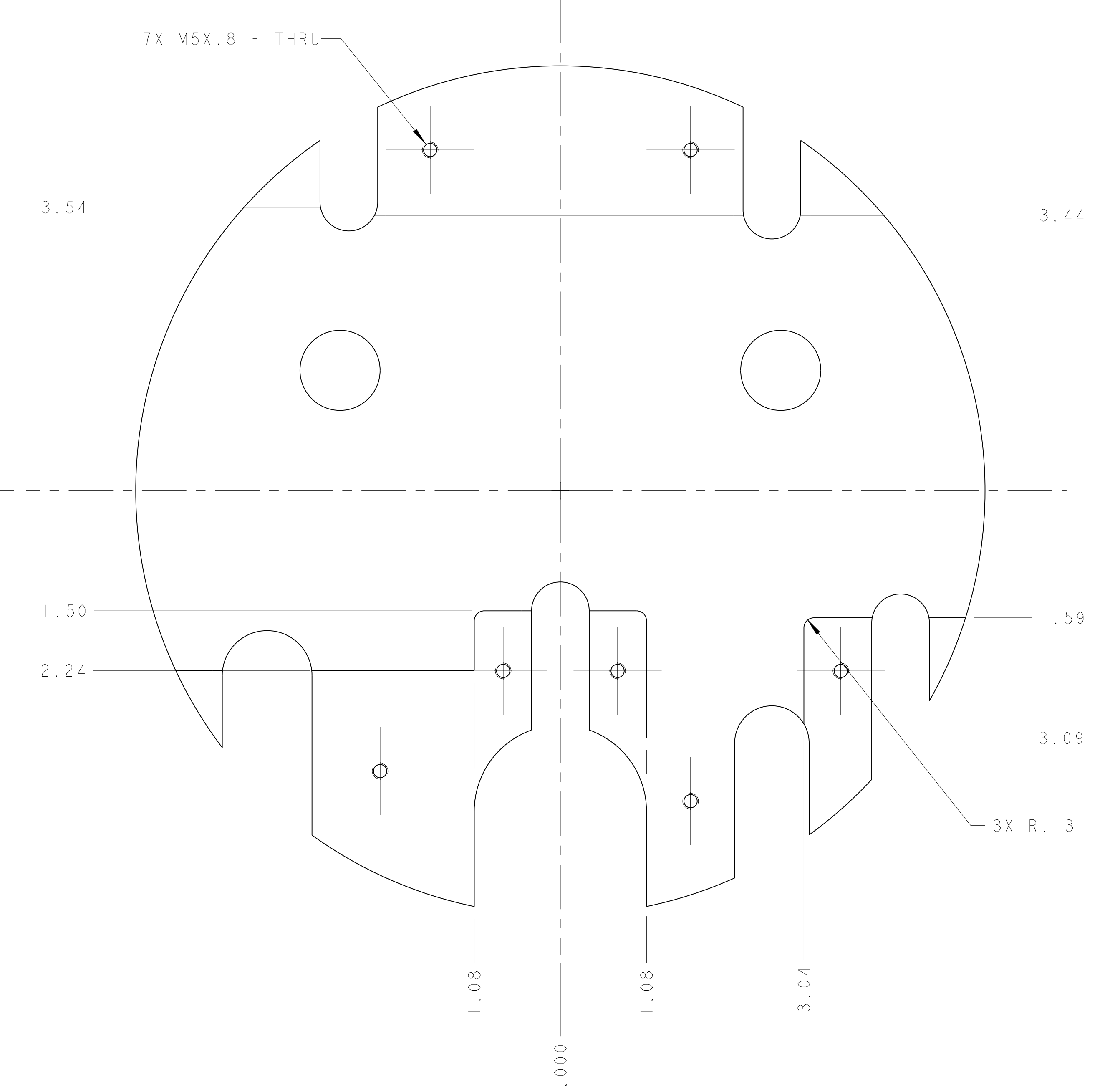

THIRD ANGLE PROJECTION

REV	DWG	CHK	ZONE	DATE	CHANGES
A	RLMSPV			11-20-02	INITIAL RELEASE

UNLESS OTHERWISE SPECIFIED		SHOP ORDERS	SEA	NO	NO
TOLERANCES	X.X ± 0.1	NO	NO	NO	NO
	FRACTIONS ± 1/64	NO	NO	NO	NO
	X.XX ± 0.02	NO	NO	NO	NO
	ANGLES ± 1.00°	NO	NO	NO	NO
	X.XXX ± 0.005	FINISH	145	145	145
	THREADS	AS PER	AS PER	AS PER	AS PER
	CHAMFER ENDS OF ALL SCREW THREADS 30°	NO	NO	NO	NO
	CUT ROUNDS, 1.5 THREAD BELLETS ON MACHINED THREADS	NO	NO	NO	NO
	BREAK EDGES .016 MAX. ON MACHINED WORK	NO	NO	NO	NO
	REMOVE BURRS, WELD SPATTER & LOOSE SCALE	NO	NO	NO	NO
	IN ACCORDANCE WITH ADME 114.5M 1 ENG. 1	NO	NO	NO	NO

DESCRIPTION		MATERIAL	MAT. LOCATION
SUPPORT PLATE		NEMA GIO	
ERNEST ORLANDO LAWRENCE BERKELEY NATIONAL LABORATORY UNIVERSITY OF CALIFORNIA - BERKELEY			
LHC IR FEEDBOX			
CRYOGENICS			
SUPPORT PLATE			
MICROFILMED:	DWG. TYPE	SHOWN ON	SCALE: 1/1
	PART		
PATENT CLEAR:	DESIGN ACCT. NO.	CATEGORY CODE	DWG. NO.
	ZSLCE2	LH2003	2513876
SHEET 1 OF 1		SIZE	REV. A