

2	-	1	RETAINER PLATE -2	NEMA G10
1	-	1	RETAINER PLATE -1	NEMA G10
ITEM	PART NO	REQD	DESCRIPTION	MATERIAL

NOTES: UNLESS OTHERWISE SPECIFIED,

- DIMENSIONS AND TOLERANCING PER ANSI Y14.5M-1982 UNITS ARE IN INCHES UNLESS OTHERWISE SPECIFIED.
- USE OF SULFUR OR SILICONE BEARING OILS, LUBRICANTS, OR COOLANTS ARE STRICTLY PROHIBITED
- USE OF RESIN OR RUBBER BONDED ADRASIVES UNDER POWER IS STRICTLY PROHIBITED. USE VITREOUS BONDED ABRASIVES ONLY.
- THIS IS A HIGH VACUUM COMPONENT. CLEAN AFTER MACHINING USING A NON-ETCHING ALKALI BASED SOLUTION.
- PROTECT FINISHED PART BY BAGGING OR SIMILAR METHOD TO PROTECT AND MAINTAIN CLEANLINESS DURING SHIPMENT AND STORAGE.

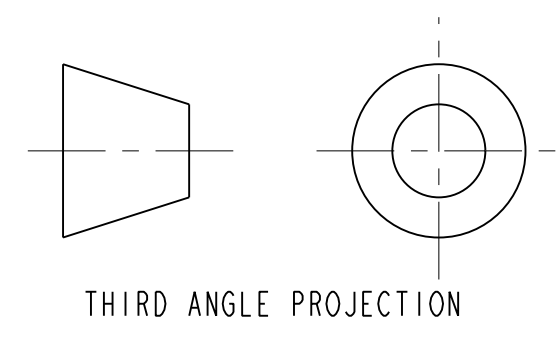
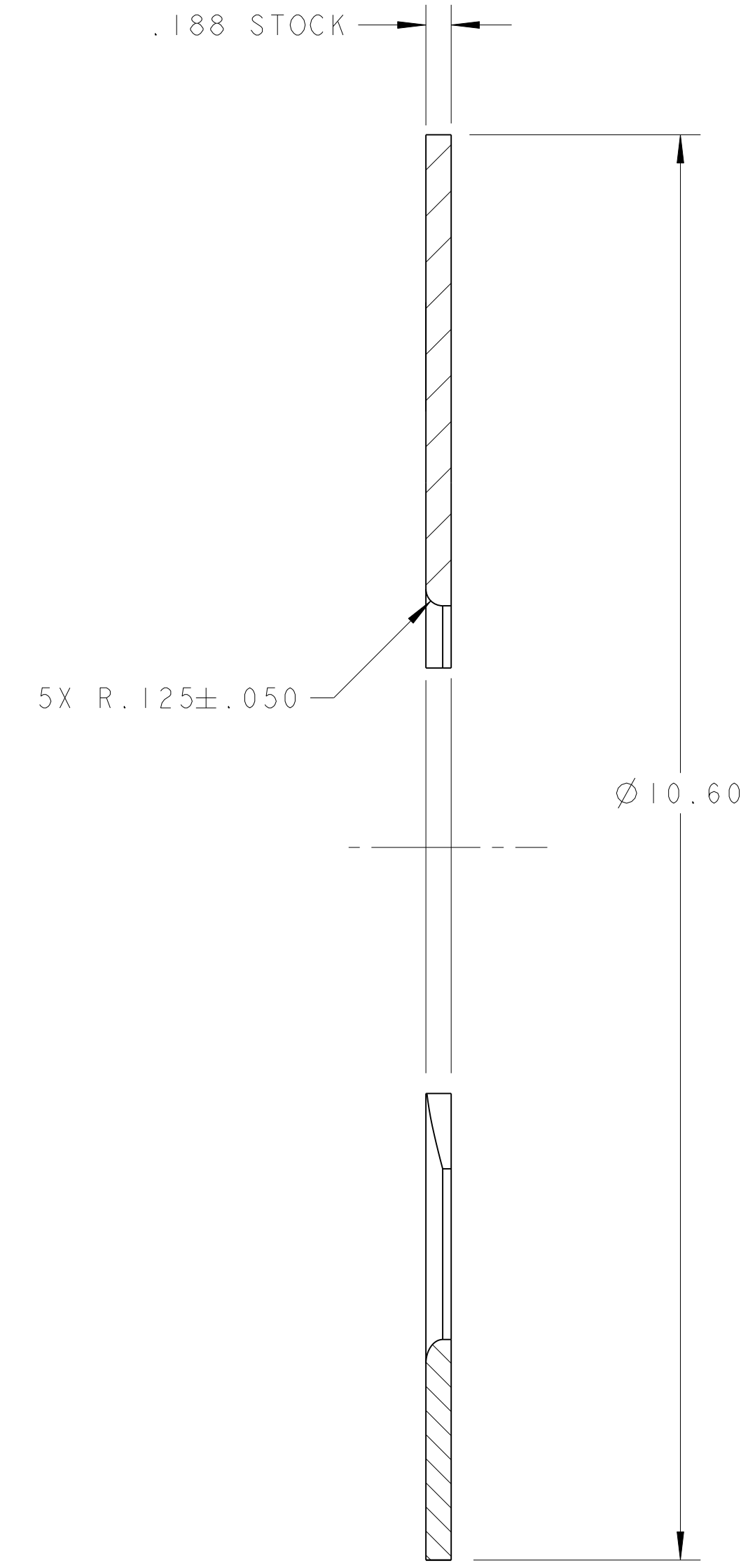
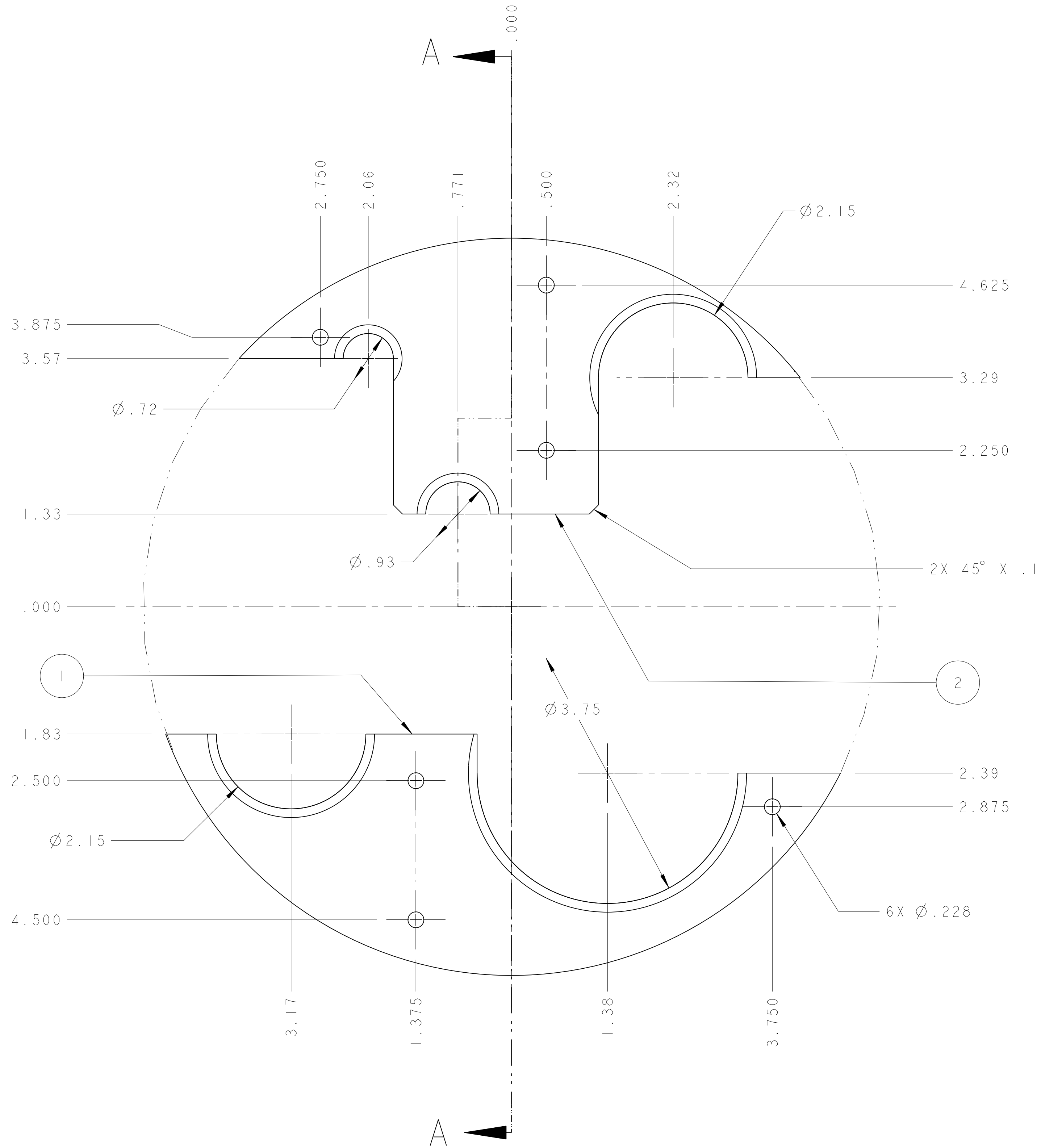

REV	DWG	CHK	ZONE	DATE	INITIAL RELEASE
A	ARH	SPV		11-15-02	CHANGES

UNLESS OTHERWISE SPECIFIED		SHOP ORDERS	
X.X ± 0.1	FRAC. ± 1/64	ACCT NO.	SER. NO.
X.XX ± 0.02	Angles ± 1.00°	NO. REQD.	DATE ISSD.
X.XXX ± 0.005	FINISH 125 $\sqrt{\mu\text{m}}$	DEL. DATE REQD.	DATE REQD.
DO NOT SCALE PRINT		SURFACE TREATMT	
THREADS ARE CLASS 2		IDENT. METHOD	
CHAMFER ENDS OF ALL SCREW THREADS 30°		PROJECT TAG	
CUT ROUND, 1.5 THREAD RELIEF ON MACHINED THREADS		PROJECT NUMBER	
BREAK EDGES .016 MAX. ON MACHINED WORK		PROJECT NAME	
REMOVE BURRS, WELD SPLATTER & LOOSE SCALE		DWG. BY R. LA MANTIA	
IN ACCORDANCE WITH ASME Y14.5M & B46.1		DATE 31-Oct-01	
		CHK BY Jon Zbasnik/S.Virostek	
		DATE 15-Nov-02	
		APR BY Jon Zbasnik/D.Oshatz	
		DATE 15-Nov-02	

**ERNEST ORLANDO LAWRENCE**  
**BERKELEY NATIONAL LABORATORY**  
 UNIVERSITY OF CALIFORNIA - BERKELEY

LHC IR FEEDBOX  
 CRYOGENICS  
 RETAINER PLATE ASSEMBLY

MICROFILMED:	DWG. TYPE	SHOWN ON	SCALE: 1/1	DO NOT SCALE PRINTS
	ASSEM	251097		
PATENT CLEAR:	DESIGN ACCT. NO.	CATEGORY CODE	DWG. NO.	SIZE
	Z5LCE2	LH2003	25i3864	REV. A

SHEET 1 OF 1