

8 7 6 5 4 3 2 1

NOTES: UNLESS OTHERWISE SPECIFIED,

- 1. DIMENSIONS AND TOLERANCING PER ANSI Y14.5M-1982 UNITS ARE IN INCHES UNLESS OTHERWISE SPECIFIED.
- 2. USE OF SULFUR OR SILICONE BEARING OILS, LUBRICANTS, OR COOLANTS ARE STRICTLY PROHIBITED
- 3. USE OF RESIN OR RUBBER BONDED ADRASIVES UNDER POWER IS STRICTLY PROHIBITED. USE VITREOUS BONDED ABRASIVES ONLY.
- 4. THIS IS A HIGH VACUUM COMPONENT. CLEAN AFTER MACHINING USING A NON-ETCHING ALKALI BASED SOLUTION.
- 6. PROTECT FINISHED PART BY BAGGING OR SIMILAR METHOD TO PROTECT AND MAINTAIN CLEANLINES DURING SHIPMENT AND STORAGE.

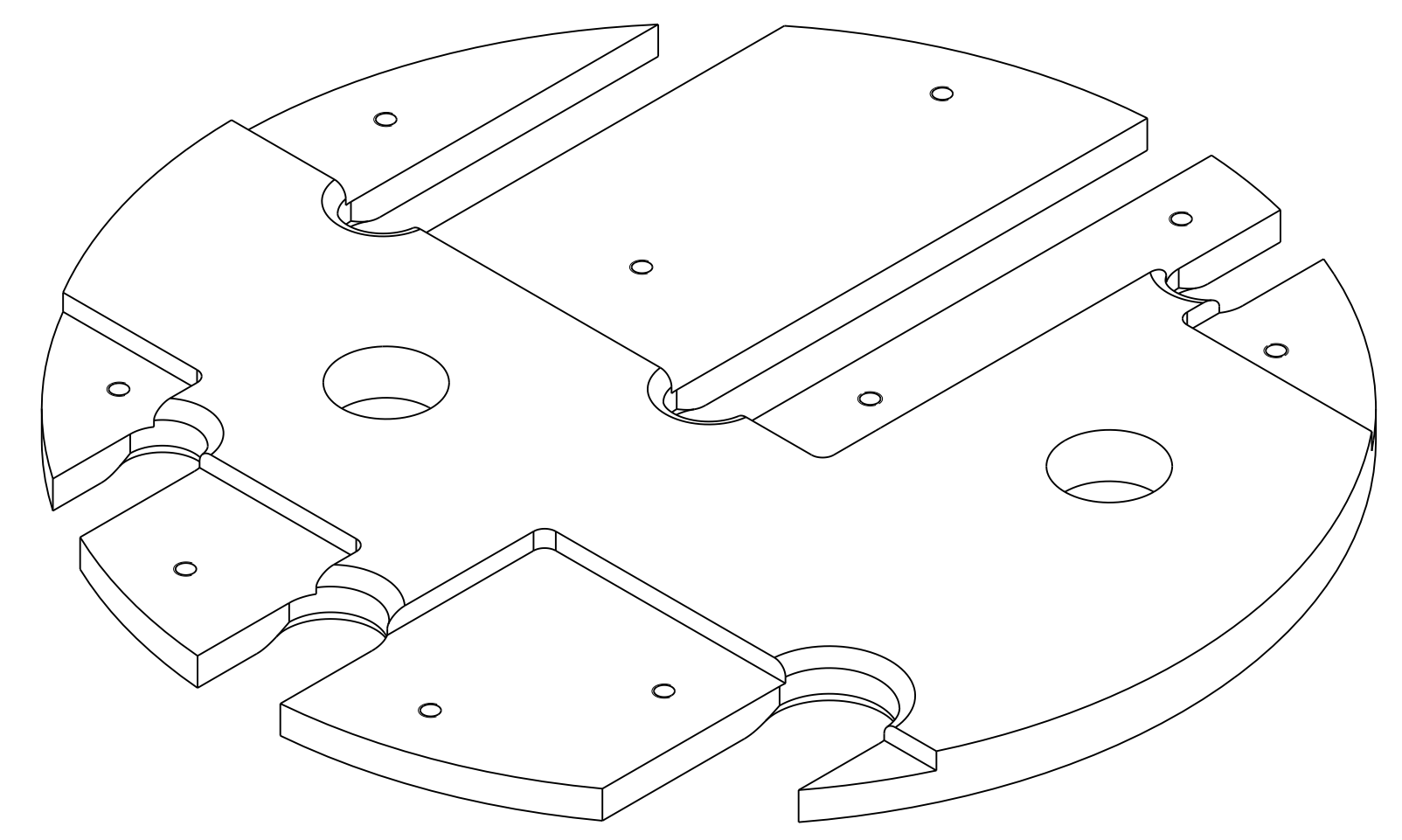

SCALE 3/4

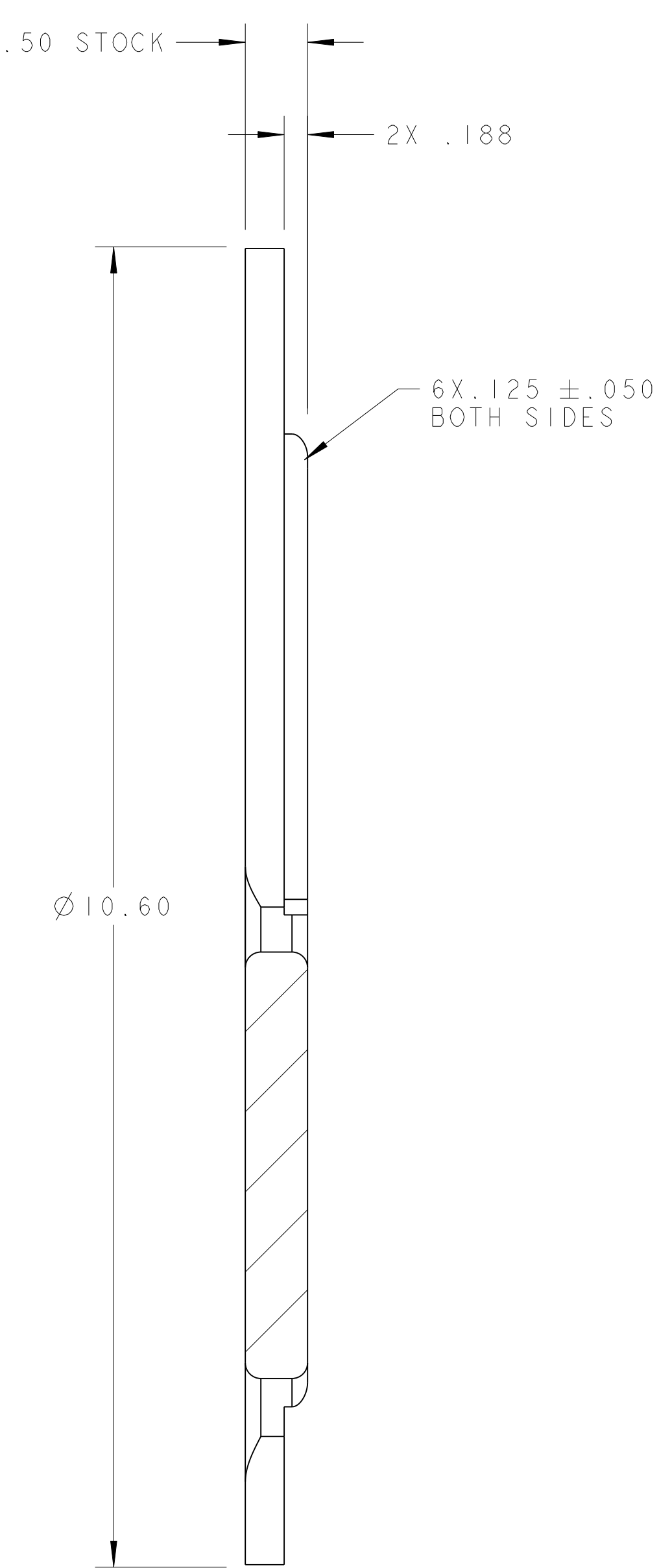
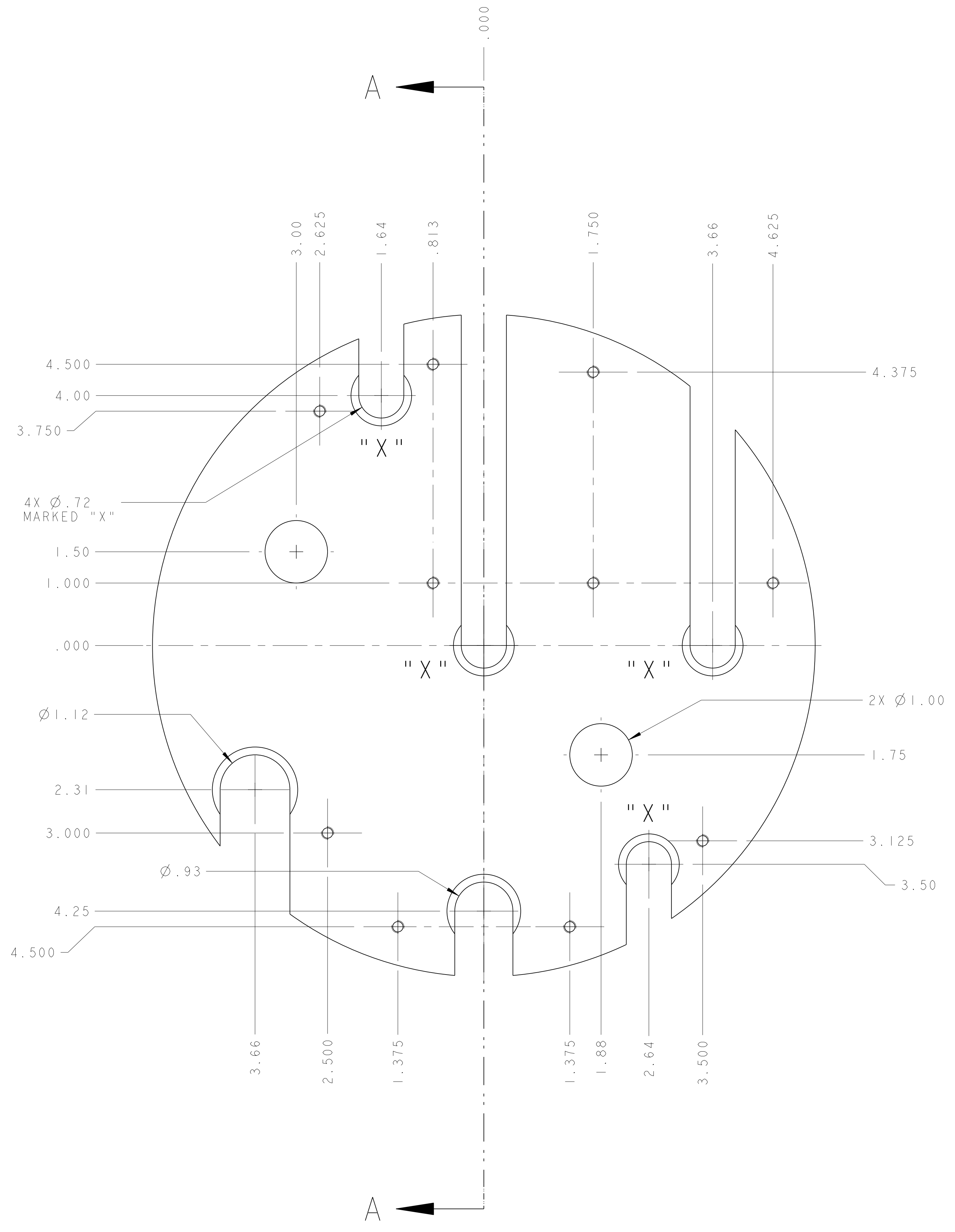

SECTION A-A

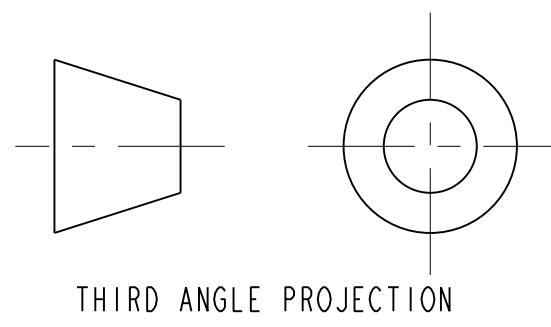
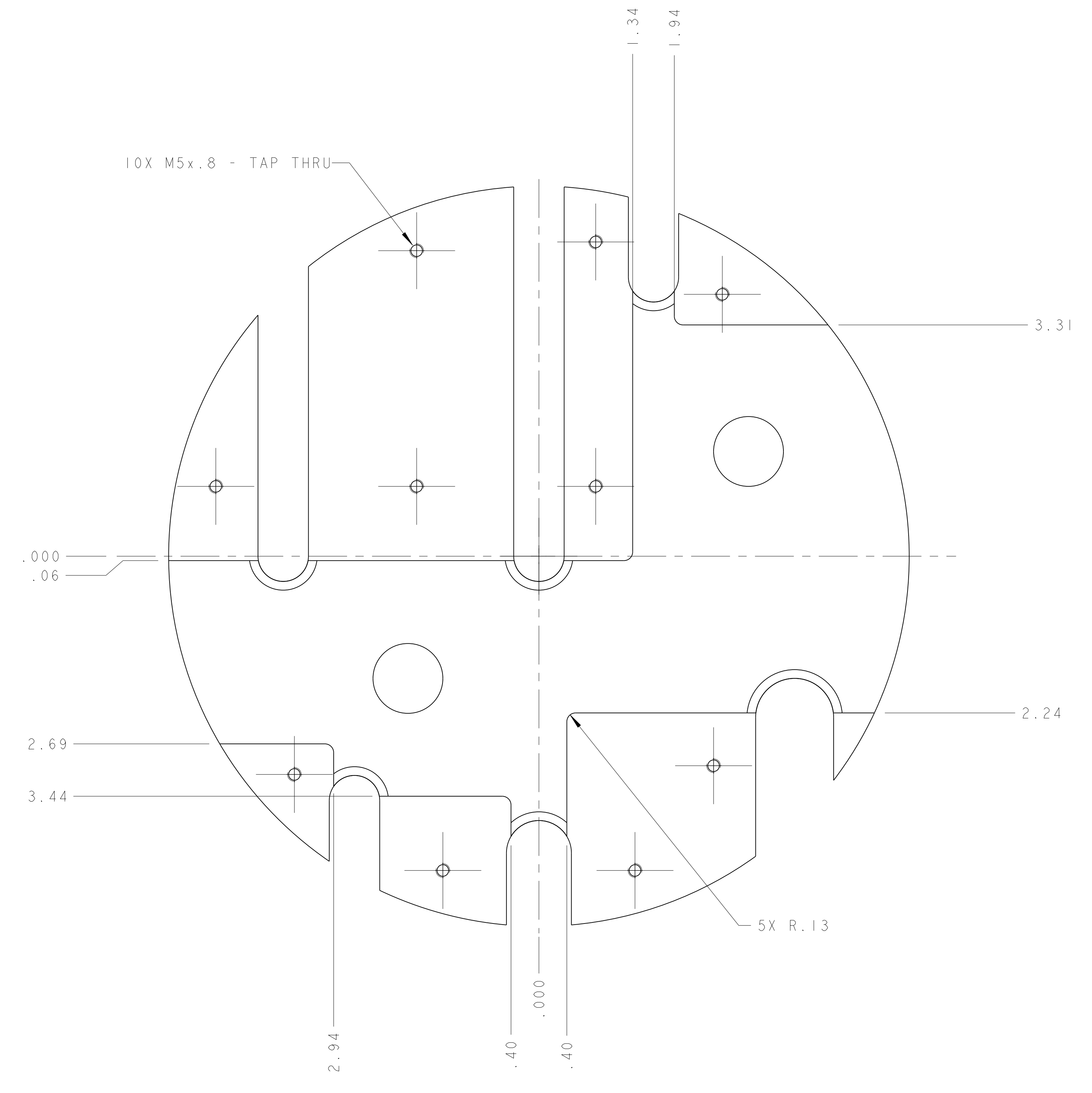

REV	DWG	CHK	ZONE	DATE	CHANGES
A	ARH	SPV		11-13-02	INITIAL RELEASE

UNLESS OTHERWISE SPECIFIED  
 X.X ± 0.1 FRACTION ± 1/64  
 X.XX ± 0.02 ANGLES ± 1.0°  
 X.XXX ± 0.005 FINISH 125 μm  
 DO NOT SCALE PRINT  
 TOLERANCES: SURFACE TREATMENT  
 TAPED ANGLES: TAG  
 BREAK ENDS OF ALL SCREW THREADS 3/4"  
 CUT ROUNDS, 1.5 THREAD BELLETS ON MACHINED THREADS  
 BREAK EDGES .015 MAX. ON MACHINED WORK  
 REMOVE BURRS, WELD SPATTER AND LOOSE SCALE  
 IN ACCORDANCE WITH ASME Y14.5M-1982

SHOP ORDERS		SEA	NO	NO	NO	NO	NO	NO	NO
NO	DATE	NO	DATE	NO	DATE	NO	DATE	NO	DATE

SUPPORT PLATE		NEMA 610		-	
DESCRIPTION		MATERIAL		MAT. LOCATION	
ERNEST ORLANDO LAWRENCE					
UNIVERSITY OF CALIFORNIA - BERKELEY					
LHC IR FEEDBOX					
CRYOGENICS					
SUPPORT PLATE					
MICROFILMED:	DWG. TYPE	SHOWN ON	SCALE:	1/1	DO NOT SCALE PRINTS
	PART				
PATENT CLEAR:	DESIGN ACCT. NO.	CATEGORY CODE	DWG. NO.	SHEET 1 OF 1	
	ZSLCE2	LH2003	2513796	A	

8 7 6 5 4 3 2 1

SCALE: 1/1 SHEET 1 OF 1