

ITEM	PART NO.	RECD	DESCRIPTION	MATERIAL
3	-	I	RETAINER PLATE -3	NEMA G10
2	-	I	RETAINER PLATE -2	NEMA G10
1	-	I	RETAINER PLATE -1	NEMA G10

NOTES: UNLESS OTHERWISE SPECIFIED,

- DIMENSIONS AND TOLERANCING PER ANSI Y14.5M-1982 UNITS ARE IN INCHES UNLESS OTHERWISE SPECIFIED.
- USE OF SULFUR OR SILICONE BEARING OILS, LUBRICANTS, OR COOLANTS ARE STRICTLY PROHIBITED
- USE OF RESIN OR RUBBER BONDED ABRASIVES UNDER POWER IS STRICTLY PROHIBITED. USE VITREOUS BONDED ABRASIVES ONLY.
- THIS IS A HIGH VACUUM COMPONENT. CLEAN AFTER MACHINING USING A NON-ETCHING ALKALI BASED SOLUTION.
- PROTECT FINISHED PART BY BAGGING OR SIMILAR METHOD TO PROTECT AND MAINTAIN CLEANLINESS DURING SHIPMENT AND STORAGE.

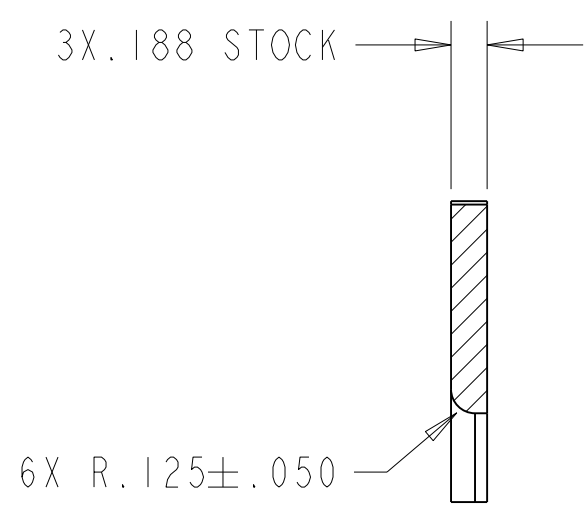
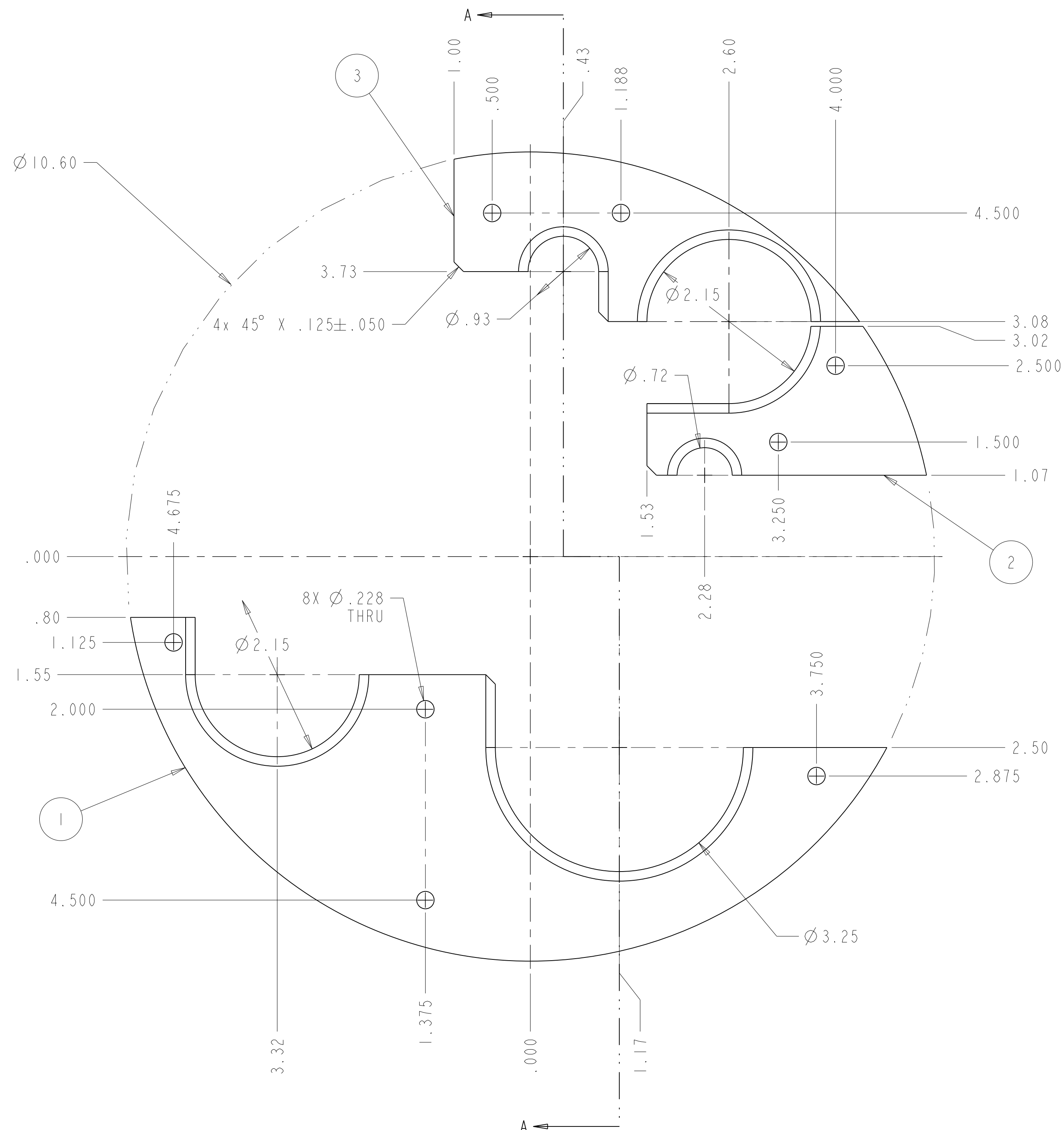

SECTION A-A

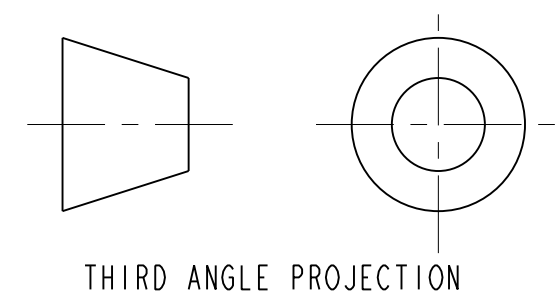

TOLERANCES				UNLESS OTHERWISE SPECIFIED				SHOP ORDERS				ERNEST ORLANDO LAWRENCE BERKELEY NATIONAL LABORATORY UNIVERSITY OF CALIFORNIA - BERKELEY					
X.X ± 0.1	FRAC. ± 1/64	ACCT NO.	NO. RECD	X.X ± 0.02	Angles ± 1.00°	DEL TO	DATE ISSD	SURFACE TREATMT	TAG	IDENT METHOD	PROJECT NUMBER	SCALE: 1.000	DO NOT SCALE PRINTS	LHC IR FEEDBOX CRYogenics			
X.XXX ± 0.005	FINISH $125 \sqrt{Ra}$	PROJECT NAME	DATE RECD	DO NOT SCALE PRINT				PROJECT TAG	N/A	PROJECT NUMBER N/A		SCALE: 1.000		CRYogenics			
CHAMFER ENDS OF ALL SCREW THREADS 30°				THREADS ARE CLASS 2				CUT ROUND, 1.5 THREAD RELIEF ON MACHINED THREADS				MICROFILMED: ASSEM 251093				RETAINER PLATE ASSEMBLY	
BREAK EDGES .016 MAX. ON MACHINED WORK				REMOVE BURRS, WELD SPLATTER & LOOSE SCALE				IN ACCORDANCE WITH ASME Y14.5M & B46.1				PATENT CLEAR: Z5LCE3 LH2003				SHEET 1 OF 1	
REV DWG CHK ZONE DATE				INITIAL RELEASE CHANGES				BY R. LA MANTIA DATE 14-Nov-02				DWG. NO. 2513784				REV. A	
BY S VIROSTEK DATE 18-Nov-02				BY D OSHATZ DATE 18-Nov-02				PROJECT NAME				DWG. NO. 2513784				REV. A	