

ITEM	PART NO.	RECD	DESCRIPTION	MATERIAL
2	-	-	PIPE, 12 NPS, SCHED 5 S, PER ASTM A312	SS 304L
1	-	-	PIPE, 12 NPS, SCHED 5 S, PER ASTM A312	SS 304L

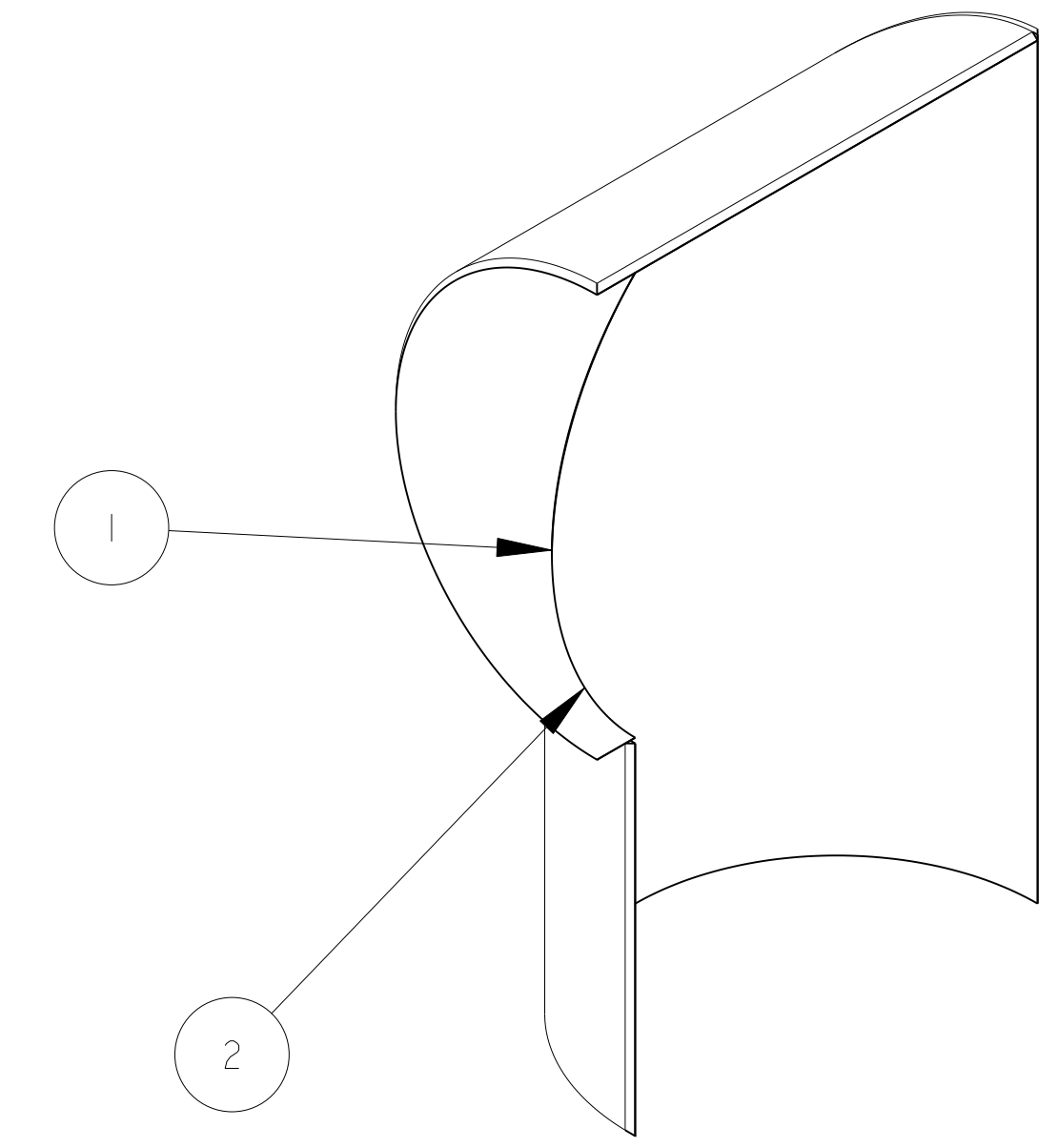

- NOTES: UNLESS OTHERWISE SPECIFIED,
- DIMENSIONS AND TOLERANCING PER ANSI Y14.5M-1982 UNITS ARE IN INCHES UNLESS OTHERWISE SPECIFIED.
  - USE OF SULFUR OR SILICONE BEARING OILS, LUBRICANTS, OR COOLANTS ARE STRICTLY PROHIBITED
  - USE OF RESIN OR RUBBER BONDED ADRASIVES UNDER POWER IS STRICTLY PROHIBITED. USE VITREOUS BONDED ABRASIVES ONLY.
  - CLEAN AFTER MACHINING PER VENDOR SPECIFICATION; SUBJECT TO LBNL APPROVAL.
  - VENDOR SUGGESTED CHANGES TO WELD PREPS; SUBJECT TO LBNL APPROVAL.
  - WELDS PER VENDOR PROCEDURES; SUBJECT TO LBNL APPROVAL.
  - PROTECT FINISHED PART BY BAGGING OR SIMILAR METHOD TO PROTECT AND MAINTAIN CLEANLINESS DURING SHIPMENT AND STORAGE.
  - VENDOR SUGGESTED CHANGES TO TOLERANCES TO FACILITATE ASSEMBLY; SUBJECT TO LBNL APPROVAL
  - ESTIMATED WEIGHT = 22 LBS

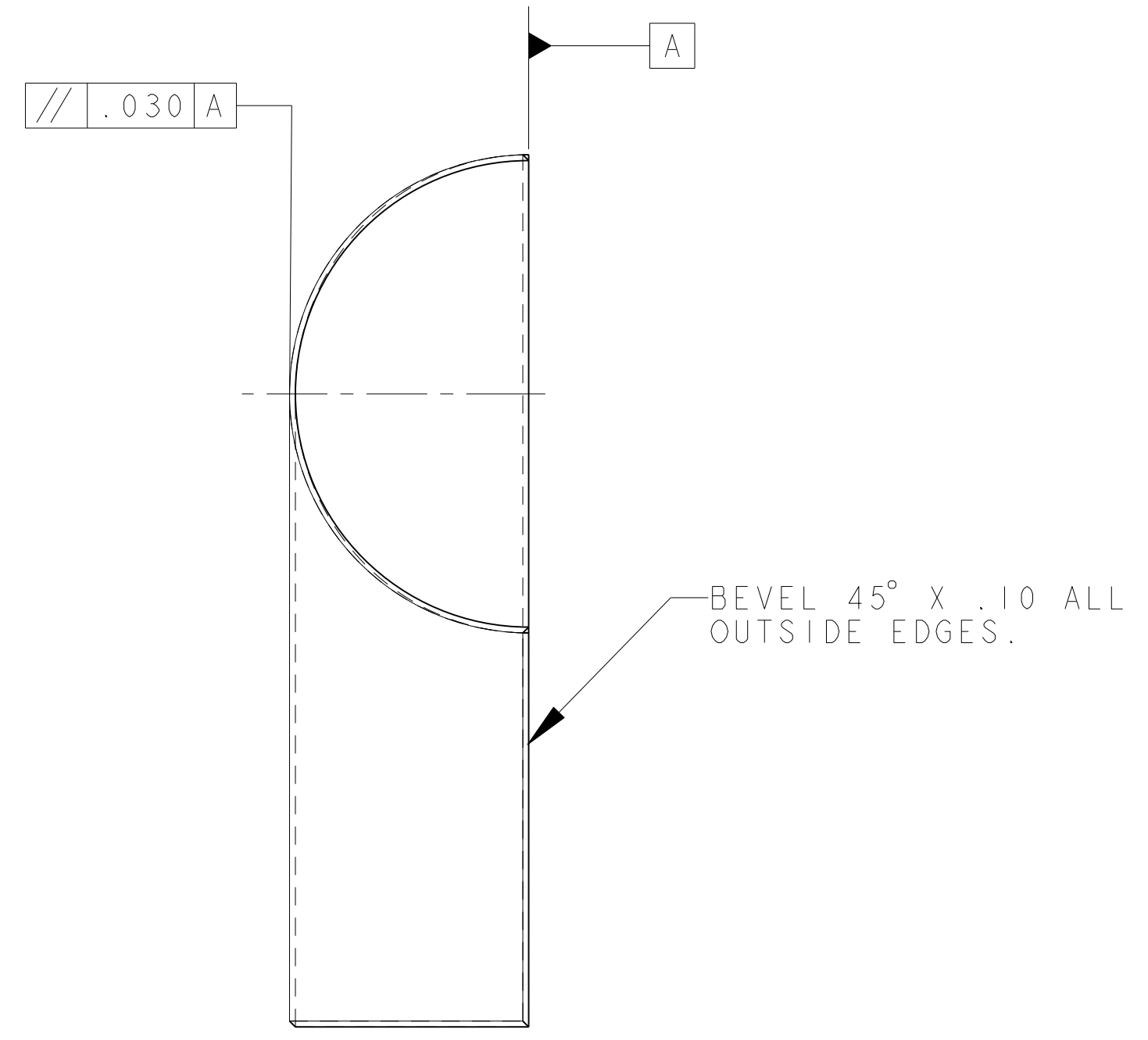
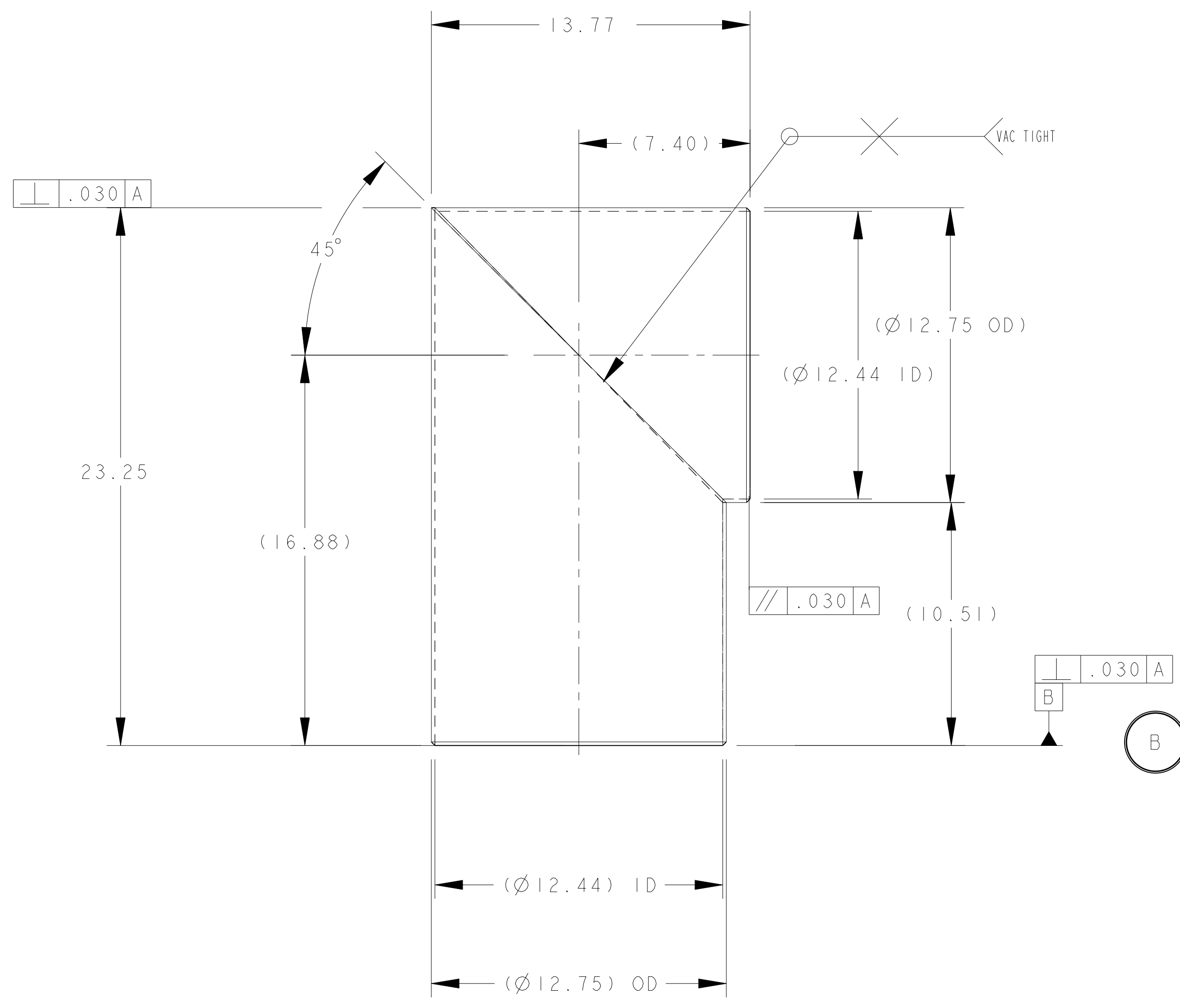
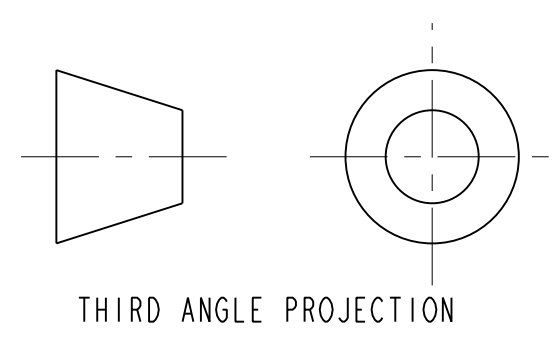

TOLERANCES				UNLESS OTHERWISE SPECIFIED				SHOP ORDERS				ERNEST ORLANDO LAWRENCE BERKELEY NATIONAL LABORATORY UNIVERSITY OF CALIFORNIA - BERKELEY			
X.X ± 0.1	FRAC. ± 1/64	ACCT NO.	NO. RECD	SER. NO.	DATE ISSD	LHC IR FEEDBOX VACUUM ENCLOSURE CHIMNEY HALF 2, JCI									
X.XX ± 0.03	Angles ± 1.00°	DEL TO	DATE RECD	IDENT	METHOD	MICROFILMED: DWG. TYPE SHOWN ON SCALE: 1/4 DO NOT SCALE PRINTS									
X.XXX ± 0.010	FINISH 125 $\sqrt{\mu\text{m}}$	DO NOT SCALE PRINT		PROJECT NUMBER	TAG	SHEET 1 OF 1									
THREADS ARE CLASS 2				CHAMFER ENDS OF ALL SCREW TREADS 30°				PROJECT NAME							
BREAK EDGES .016 MAX. ON MACHINED WORK				CUT ROUND, 1.5 THREAD RELIEF ON MACHINED THREAD				DWG. BY R LA MANTIA DATE 28-Nov-01							
REMOVE BURRS, WELD SPLATTER & LOOSE SCALE				BREAK EDGES .016 MAX. ON MACHINED WORK				CHK BY Jon Zbasnik DATE 4/2/02							
IN ACCORDANCE WITH ASME Y14.5M & B46.1				REMOVE BURRS, WELD SPLATTER & LOOSE SCALE				APR BY Jon Zbasnik DATE 4/2/02							
REV	DWG	CHK	ZONE	DATE	CHANGES				DESIGN ACCT. NO.	CATEGORY CODE	DWG. NO.	SIZE	REV.		
B	JDR	DPO		11/06/02	ADDED PERPENDICULARITY TOLERANCE				Z5LCE2	LH2002	2513254	B			
A	MJK	DPO		9/11/02	INITIAL RELEASE										