

8

7

6

5

4

3

DWG. NO. 2512024
SIZE A
REV. 1

1

ITEM	PART NO	QTY	DESCRIPTION	MATERIAL
5	-	12	WASHER, M5, SILVER PLATE	SS 18-8
4	-	12	SCH, M5X.8, 15LG, SILVER PLATED	SS 18-8
3	251395	2	SUPPORT PLATE	NEMA G10
2	251396	2	RETAINER PLATE ASSEMBLY	NEMA G10
1	251451	2	ORL ENCLOSURE, LONG, 1P 5	NEMA G10

D

D

C

C

B

B

A

A

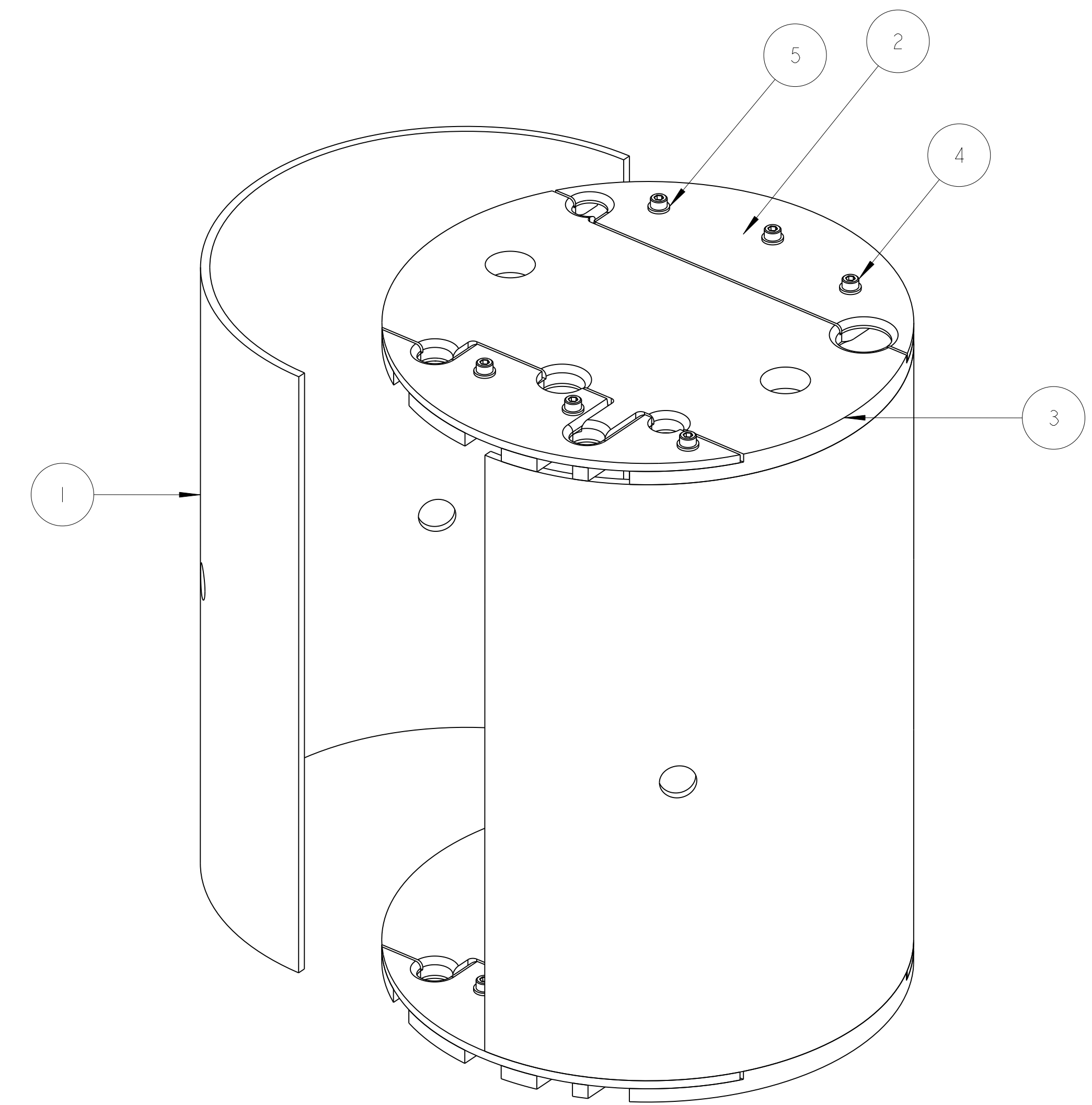
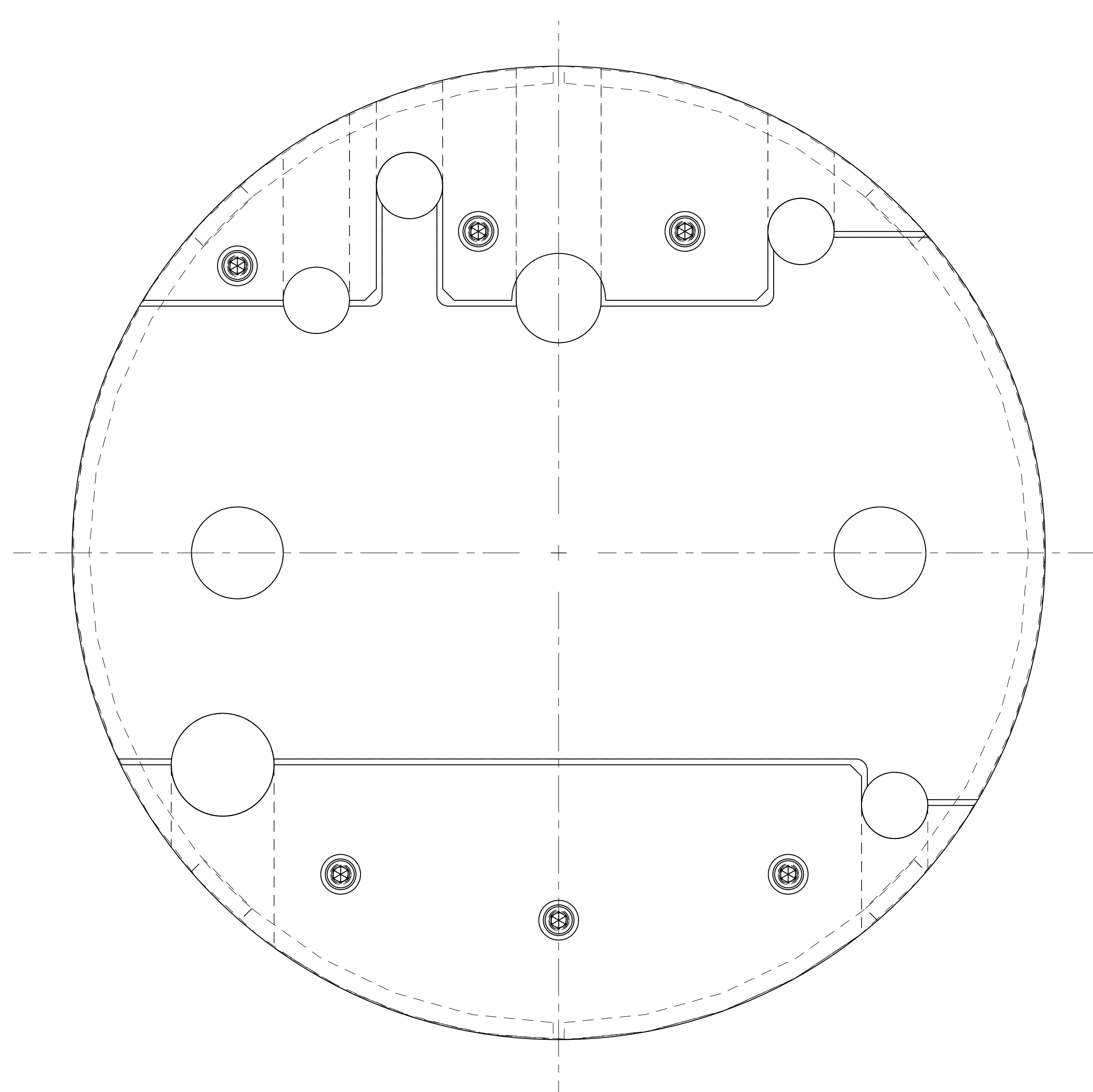

SCALE 1/2

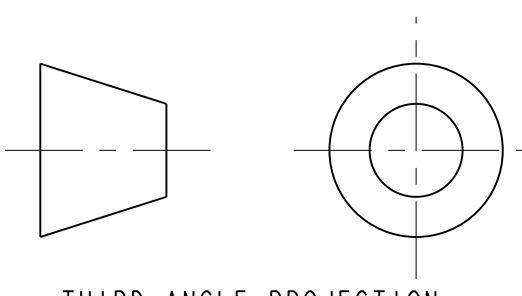

THIRD ANGLE PROJECTION

<table border="1"> <tr> <td>REV</td> <td>DWG</td> <td>CHK</td> <td>ZONE</td> <td>DATE</td> <td>INITIAL RELEASE</td> </tr> <tr> <td>A</td> <td>ARH</td> <td>SPV</td> <td></td> <td>11-15-02</td> <td>CHANGES</td> </tr> </table>				REV	DWG	CHK	ZONE	DATE	INITIAL RELEASE	A	ARH	SPV		11-15-02	CHANGES	<p>UNLESS OTHERWISE SPECIFIED</p> <p>TOLERANCES: X.X ± 0.1, X.XX ± 0.03, X.XXX ± 0.010</p> <p>FRAC. ± 1/64, Angles ± 1.00°</p> <p>FINISH 125 \sqrt{Ra}</p> <p>DO NOT SCALE PRINT</p> <p>THREADS ARE CLASS 2</p> <p>CHAMFER ENDS OF ALL SCREW THREADS 30°</p> <p>CUT ROUND, 1.5 THREAD RELIEF ON MACHINED THREADS</p> <p>BREAK EDGES .016 MAX. ON MACHINED WORK</p> <p>REMOVE BURRS, WELD SPLATTER & LOOSE SCALE</p> <p>IN ACCORDANCE WITH ASME Y14.5M & B46.1</p>				<p>SHOP ORDERS</p> <p>ACCT NO. _____ NO. _____</p> <p>DEL TO _____ DATE ISSD _____</p> <p>DATE RECD _____</p> <p>SURFACE TREATMENT _____</p> <p>IDENT METHOD TAG _____</p> <p>PROJECT NUMBER N/A</p> <p>PROJECT NAME NA</p> <p>DWG BY R LA MANTIA DATE 13-Nov-01</p> <p>CHK BY Jon Zbasnik/s.Virostek DATE 15-Nov-02</p> <p>APP BY Jon Zbasnik/D.Oshatz DATE 15-Nov-02</p>				<p>ERNEST ORLANDO LAWRENCE BERKELEY NATIONAL LABORATORY UNIVERSITY OF CALIFORNIA - BERKELEY</p> <p>LHC IR FEEDBOX CRYogenics SUPPORT, QOSB, DFBXF</p> <p>MICROFILMED: _____ DWG. TYPE ASSEM SHOWN ON _____ SCALE: 1/1 DO NOT SCALE PRINTS</p> <p>PATENT CLEAR: _____ DESIGN ACCT. NO. Z5LCE2 CATEGORY CODE LH2003</p> <p>DWG. NO. 2512024 SIZE A REV. 1</p>			
REV	DWG	CHK	ZONE	DATE	INITIAL RELEASE																						
A	ARH	SPV		11-15-02	CHANGES																						

8

7

6

5

4

3

2

1