

SECTION B-B

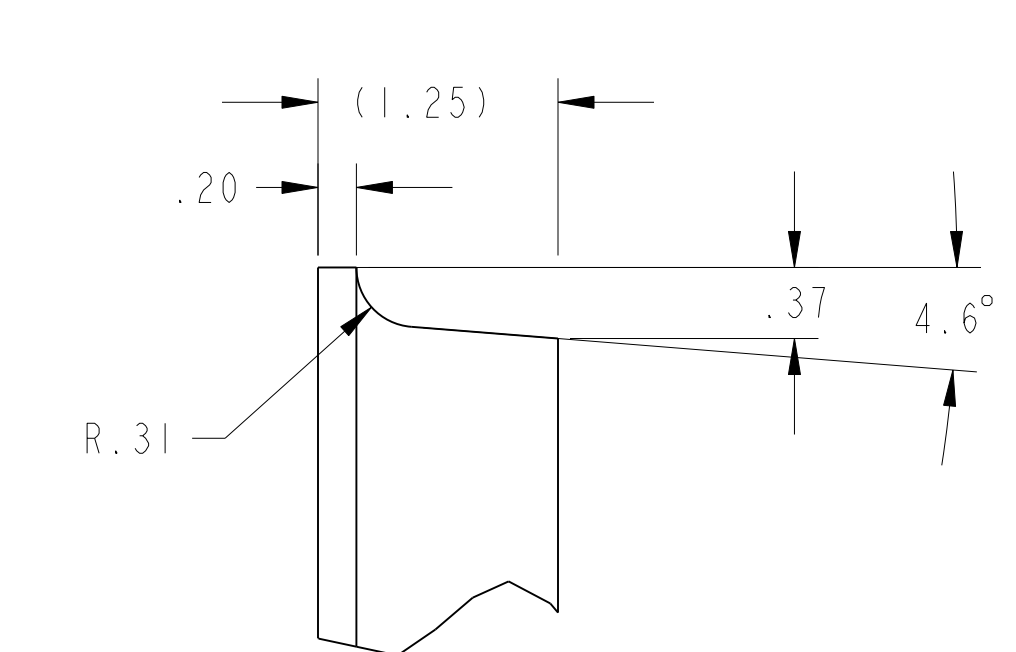
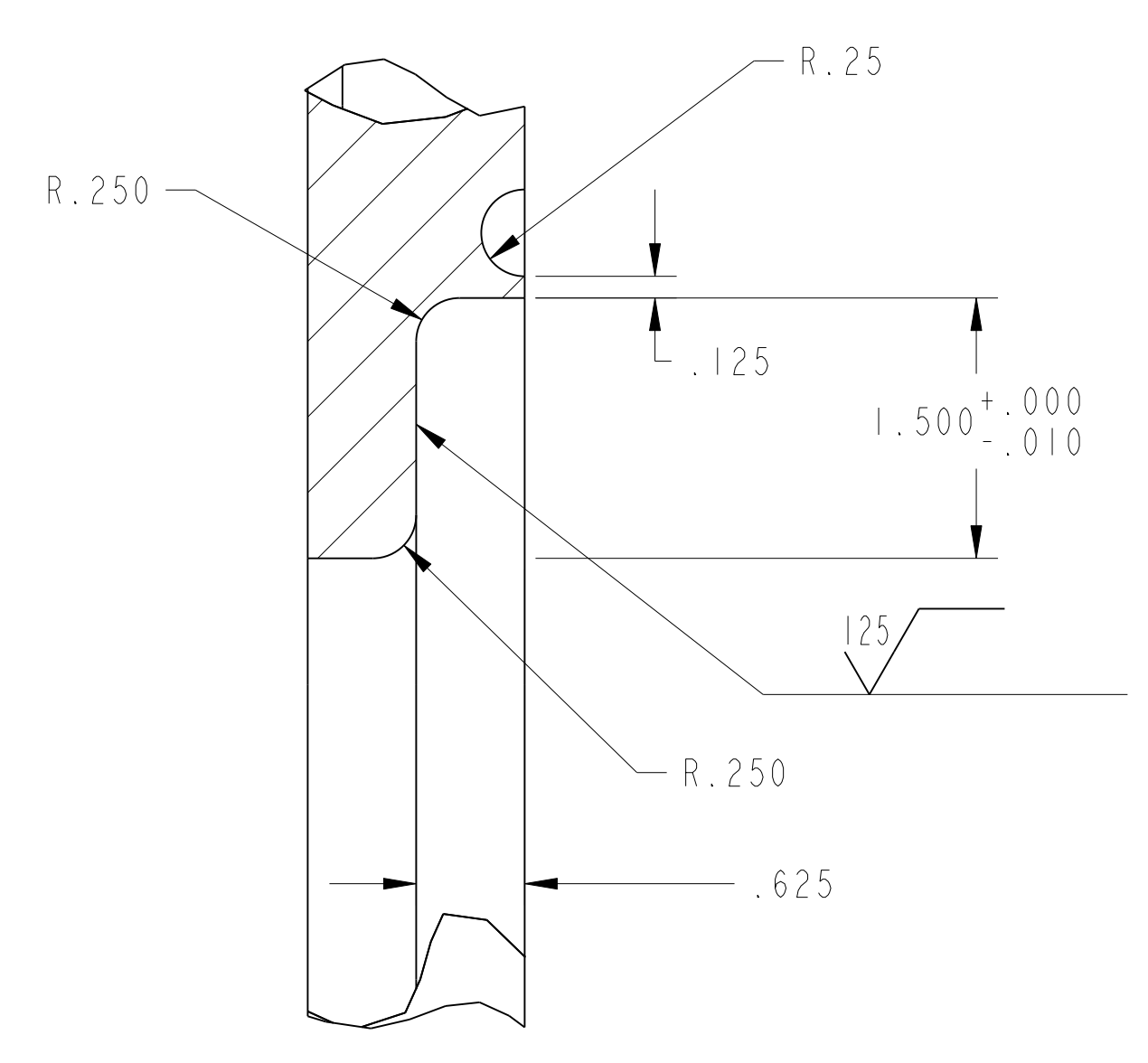

DETAIL A
WELD PREP - ALL EDGES
SCALE 1/1

- NOTES: UNLESS OTHERWISE SPECIFIED.
1. DIMENSIONS AND TOLERANCING PER ANSI Y14.5M-1982 UNITS ARE IN INCHES UNLESS OTHERWISE SPECIFIED.
 2. USE OF SULFUR OR SILICONE BEARING OILS, LUBRICANTS, OR COOLANTS ARE STRICTLY PROHIBITED
 3. USE OF RESIN OR RUBBER BONDED ABRASIVES UNDER POWER IS STRICTLY PROHIBITED. USE VITREOUS BONDED ABRASIVES ONLY.
 4. VENDOR TO PROVIDE CLEANING SPECIFICATIONS PRIOR TO WELDING FOR LBL APPROVAL.
 5. PROTECT FINISHED PART BY BAGGING OR SIMILAR METHOD TO PROTECT AND MAINTAIN CLEANLINESS DURING SHIPMENT AND STORAGE.
 6. ESTIMATED WEIGHT = 751 LBS WITH ACCESS PANEL CUTOUT
ESTIMATED WEIGHT = 1,403 LBS WITHOUT ACCESS PANEL CUTOUT
 7. TEMPORARY LIFTING FEATURES NOT SHOWN. TO BE PROVIDED BY VENDOR AND REMOVED PRIOR TO SHIPMENT

DETAIL C
COVER PLATE POCKET & WELD PREP
SCALE 1/1

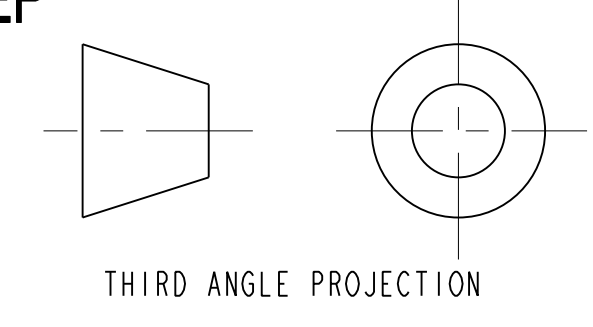

REV	DATE	CHK	ZONE	DATE	INITIALS	RELEASE	CHANGES
A							

UNLESS OTHERWISE SPECIFIED		SHOP ORDERS	
TOLERANCES	X.X ± 0.1 FRACTION ± 1/64	NO.	NO.
	X.XX ± 0.03 ANGLES ± 1.00°	DATE	DATE
	X.XXX ± 0.010 FINISH 125 μm	REVISION	REVISION
DO NOT SCALE PRINT		PROJECT	PROJECT
THREADS ARE CLASS 2		DATE	DATE
CHAMFER ENDS OF ALL SCREW THREADS 30°		BY	BY
CUT ROUNDS, 1.5 THREAD RELIEF ON MACHINED THREADS		DATE	DATE
BREAK EDGES, 1/16 MAX. ON MACHINED WORK		DATE	DATE
REMOVE BURRS, WELD SPATTER & LOOSE SCALE		DATE	DATE
IN ACCORDANCE WITH ASME Y14.5M-1987		DATE	DATE

PLATE, 1.25 THK., HOT ROLLED, ANNEALED AND PICKLED PER ASTM A240	304L SS	
DESCRIPTION	MATERIAL	MAT. LOCATION
ERNEST ORLANDO LAWRENCE BERKELEY NATIONAL LABORATORY UNIVERSITY OF CALIFORNIA - BERKELEY LHC IR FEEDBOX VACUUM INSIDE, RIGHT SIDE PLATE		
MICROFILMED:	DWG. TYPE:	SCALE: 3/16
PART:	SHOWN ON:	SHEET 1 OF 1
PATENT CLEAR:	DESIGN ACCT. NO:	DWG. NO. 2511236
ZSLCE2	LH2002	SIZE: REV. A

2511236 A 1
 SHEET 1 OF 1
 ERNEST ORLANDO LAWRENCE
 BERKELEY NATIONAL LABORATORY
 UNIVERSITY OF CALIFORNIA - BERKELEY