

8

7

6

5

4

3

1

DWG. NO. 2510944 SIZE REV. SH. A 1

ITEM	PART NO	RECD	DESCRIPTION	MATERIAL
5	-	20	WASHER, M5, SILVER PLATE	SS 18-8
4	-	20	SCH, M5X.8, 15LG, SILVER PLATED	SS 18-8
3	251379	2	SUPPORT PLATE	NEMA G10
2	251380	2	RETAINER PLATE ASSEMBLY	NEMA G10
1	251449	2	ORL ENCLOSURE, LONG, 1P 1, 2&8	NEMA G10

D

D

C

C

B

B

A

A

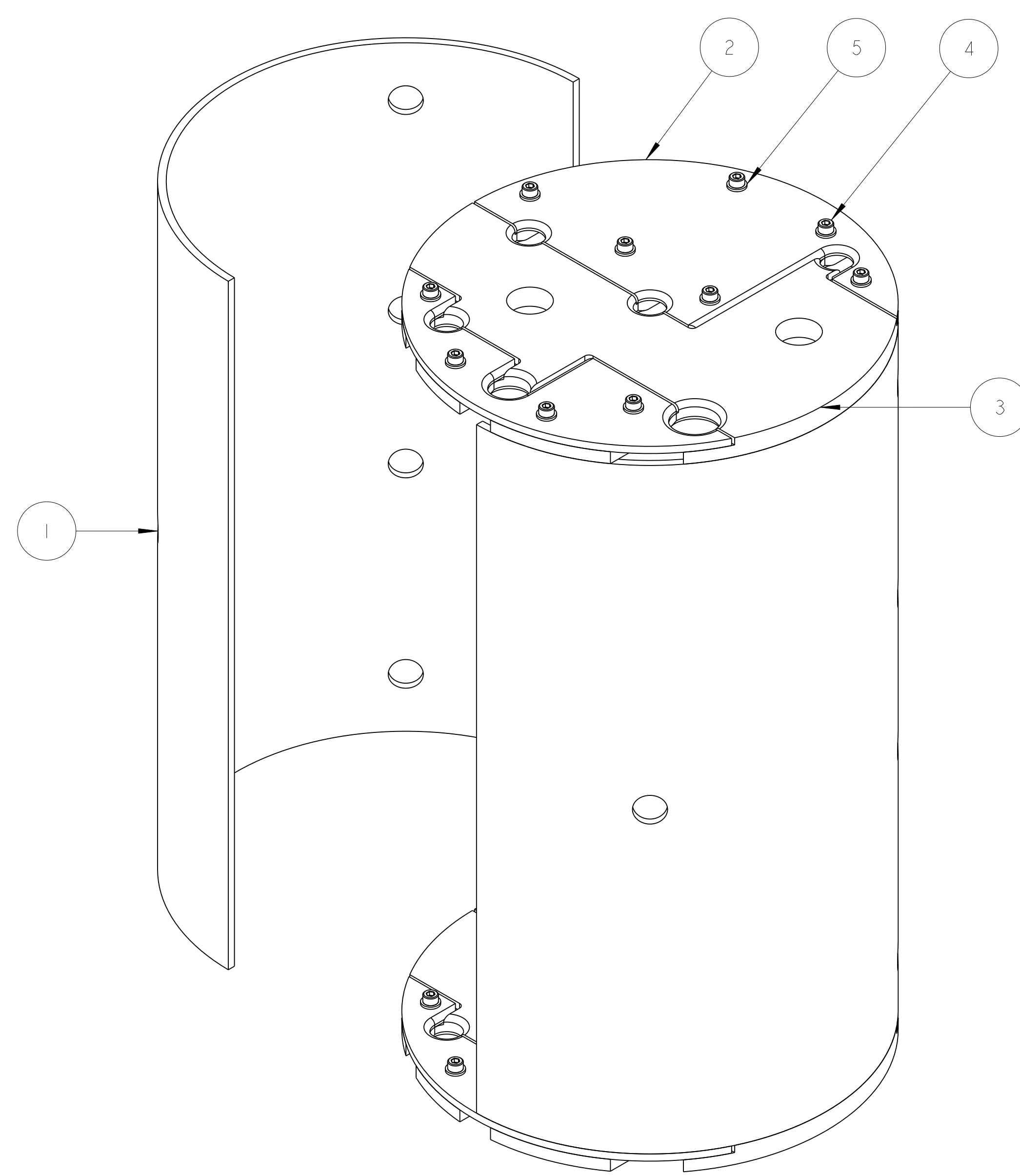
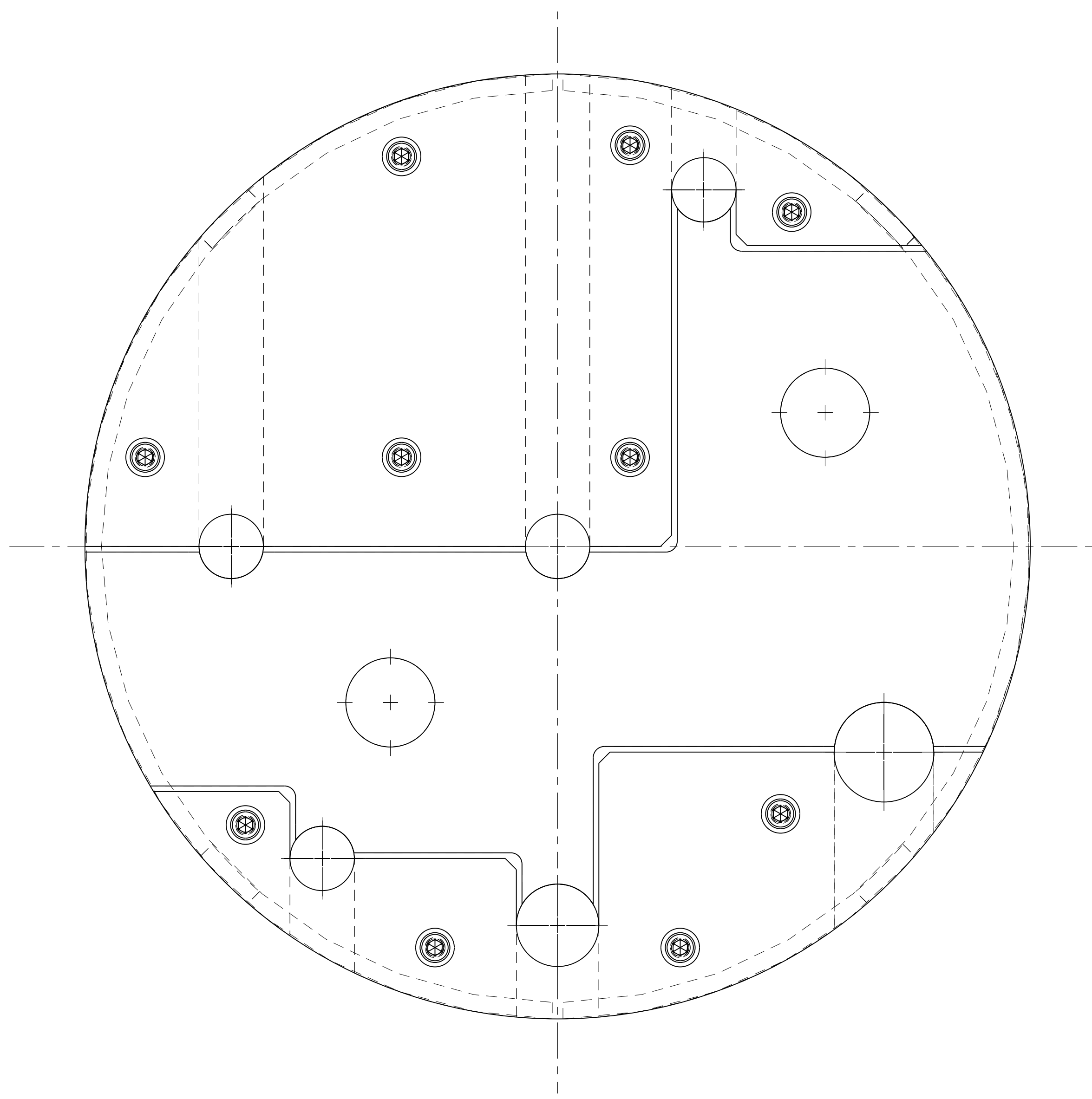

SCALE 1/2

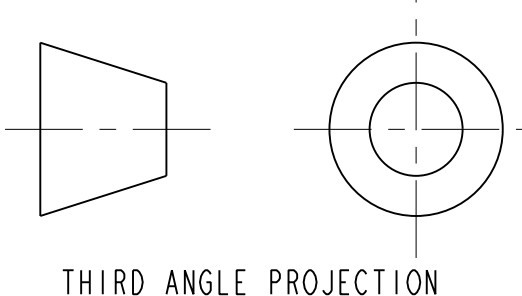

THIRD ANGLE PROJECTION

<table border="1"> <tr> <td>REV</td> <td>DWG</td> <td>CHK</td> <td>ZONE</td> <td>DATE</td> </tr> <tr> <td>A</td> <td>ARH</td> <td>SPV</td> <td></td> <td>11-13-02</td> </tr> </table>				REV	DWG	CHK	ZONE	DATE	A	ARH	SPV		11-13-02	<p>INITIAL RELEASE CHANGES</p>				<p>UNLESS OTHERWISE SPECIFIED</p> <p>TOLERANCES X.X ± 0.1 FRAC. ± 1/64 X.XX ± 0.03 Angles ± 1.00° X.XXX ± 0.010 FINISH 125\sqrt{Ra}</p> <p>DO NOT SCALE PRINT</p> <p>THREADS ARE CLASS 2</p> <p>CHAMFER ENDS OF ALL SCREW THREADS 30°</p> <p>CUT ROUND, 1.5 THREAD RELIEF ON MACHINED THREADS</p> <p>BREAK EDGES .016 MAX. ON MACHINED WORK</p> <p>REMOVE BURRS, WELD SPLATTER & LOOSE SCALE</p> <p>IN ACCORDANCE WITH ASME Y14.5M & B46.1</p>				<p>SHOP ORDERS</p> <table border="1"> <tr> <td>ACCT NO.</td> <td>NO.</td> <td>DATE</td> </tr> <tr> <td>DEL TO</td> <td>ISSD</td> <td>DATE</td> </tr> <tr> <td>SURFACE TREATMT</td> <td>TAG</td> <td></td> </tr> <tr> <td>IDENT METHOD</td> <td>NUMBER</td> <td></td> </tr> <tr> <td>PROJECT NAME</td> <td>N/A</td> <td></td> </tr> <tr> <td>DWG BY</td> <td>R LA MANTIA</td> <td>DATE</td> <td>18-Jul-02</td> </tr> <tr> <td>CHK BY</td> <td>Jon Zbasnik/S.Virostek</td> <td>DATE</td> <td>13-Nov-02</td> </tr> <tr> <td>APP BY</td> <td>Jon Zbasnik/D.Oshatz</td> <td>DATE</td> <td>13-Nov-02</td> </tr> </table>				ACCT NO.	NO.	DATE	DEL TO	ISSD	DATE	SURFACE TREATMT	TAG		IDENT METHOD	NUMBER		PROJECT NAME	N/A		DWG BY	R LA MANTIA	DATE	18-Jul-02	CHK BY	Jon Zbasnik/S.Virostek	DATE	13-Nov-02	APP BY	Jon Zbasnik/D.Oshatz	DATE	13-Nov-02	<p>ERNEST ORLANDO LAWRENCE BERKELEY NATIONAL LABORATORY UNIVERSITY OF CALIFORNIA - BERKELEY</p> <p>LHC IR FEEDBOX CRYOGENICS SUPPORT, QOSB, DFBXA</p> <table border="1"> <tr> <td>MICROFILMED:</td> <td>DWG. TYPE</td> <td>SHOWN ON</td> <td>SCALE:</td> <td>DO NOT SCALE PRINTS</td> </tr> <tr> <td></td> <td>ASSEM</td> <td>-</td> <td>1/1</td> <td></td> </tr> </table> <p>PATENT CLEAR: DESIGN ACCT. NO. Z5LCE2 CATEGORY CODE LH2003</p> <p>DWG. NO. 2510944 SIZE A REV. A</p>				MICROFILMED:	DWG. TYPE	SHOWN ON	SCALE:	DO NOT SCALE PRINTS		ASSEM	-	1/1	
REV	DWG	CHK	ZONE	DATE																																																														
A	ARH	SPV		11-13-02																																																														
ACCT NO.	NO.	DATE																																																																
DEL TO	ISSD	DATE																																																																
SURFACE TREATMT	TAG																																																																	
IDENT METHOD	NUMBER																																																																	
PROJECT NAME	N/A																																																																	
DWG BY	R LA MANTIA	DATE	18-Jul-02																																																															
CHK BY	Jon Zbasnik/S.Virostek	DATE	13-Nov-02																																																															
APP BY	Jon Zbasnik/D.Oshatz	DATE	13-Nov-02																																																															
MICROFILMED:	DWG. TYPE	SHOWN ON	SCALE:	DO NOT SCALE PRINTS																																																														
	ASSEM	-	1/1																																																															

8

7

6

5

4

3

2

1