

- NOTES: (UNLESS OTHERWISE SPECIFIED)
- THIS IS A CRYOGENIC VACUUM COMPONENT.
 - WELDING PROCEDURE: PER VENDOR SPECIFICATION WITH LBNL APPROVAL.
 - CLEANING PROCEDURE : PER VENDOR SPECIFICATION WITH LBNL APPROVAL.
 - PACKAGING AND STORAGE PROCEDURE OF THE COMPONENTS: PER VENDOR SPECIFICATION WITH LBNL APPROVAL.
 - DIMENSIONS AND TOLERANCING PER ANSI Y14.5M-1982. UNITS ARE IN INCHES [mm] UNLESS OTHERWISE SPECIFIED.
 - USE OF SULFUR OR SILICONE BEARING OILS, LUBRICANTS, OR COOLANTS ARE STRICTLY PROHIBITED.
 - USE OF RESIN OR RUBBER BONDED ABRASIVES UNDER POWER IS STRICTLY PROHIBITED. USE VITREOUS BONDED ABRASIVES ONLY.
 - TIN NOTED AREAS WITH 60/40 Sn/Pb SOLDER, USE RESIN FLUX.

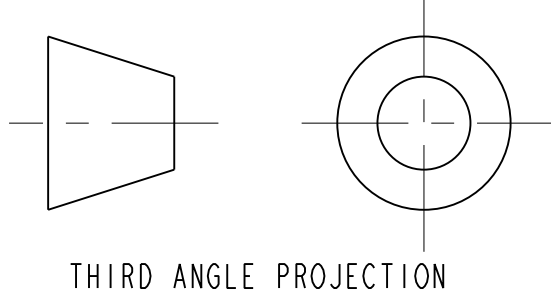

REV	DWG	CHK	ZONE	DATE	CHANGES
B	JDR	DPO		11-08-02	ADDED XB THRUST PLATE HOLES
A	ARH	DPO		09-09-02	INITIAL RELEASE

UNLESS OTHERWISE SPECIFIED	SHOP ORDERS
COEFFICIENTS: X.X ± 0.1 FRACTION: ± 1/64	DATE: 15-FEB-02
TOLERANCES: X.XX ± 0.03 ANGLES: ± 1.00°	DATE: 13-AUG-02
DO NOT SCALE PRINT	DATE: 13-AUG-02
THREADS: ALL CLASS 1	
CHAMFER ENDS OF ALL SCREW THREADS 30°	
OUT ROUND, 1.5 THREAD RELIEF ON MACHINED THREADS	
BREAK EDGES .016 MAX. ON MACHINED WORK	
REMOVE BURRS, WELD SPATTER & LOOSE SCALE	
IN ACCORDANCE WITH ASME Y14.5M-1994	

ITEM	PART NO.	RECD	DESCRIPTION	MATERIAL
2	-	6	MS CAPTIVE NUT, PEM AC-MS-1-SF	SS
1	-	1	COPPER SHEET, .125 THICK	COPPER, OFHC, C101

REV	DWG	CHK	ZONE	DATE	CHANGES
B	JDR	DPO		11-08-02	ADDED XB THRUST PLATE HOLES
A	ARH	DPO		09-09-02	INITIAL RELEASE

ERNEST ORLANDO LAWRENCE
BERKELEY NATIONAL LABORATORY
UNIVERSITY OF CALIFORNIA - BERKELEY

LHC IR FEEDBOX
CRYOGENICS
TOP SHIELD, DFBXA/DFBXC/DFBXG

SCALE: 3/8
SHEET 1 OF 3
DWG. NO. 2510716
REV. B

SCALE: 3/8 SHEET 1 OF 3 DWG. NO. 2510716 REV. B

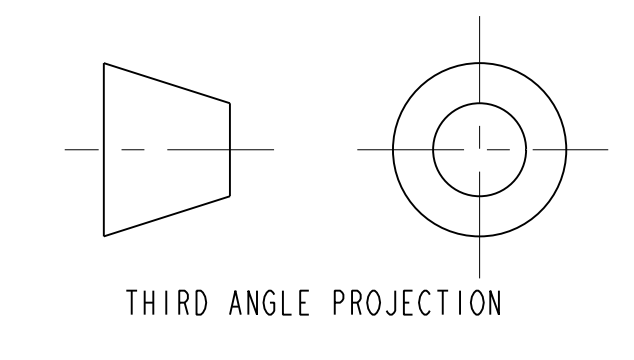
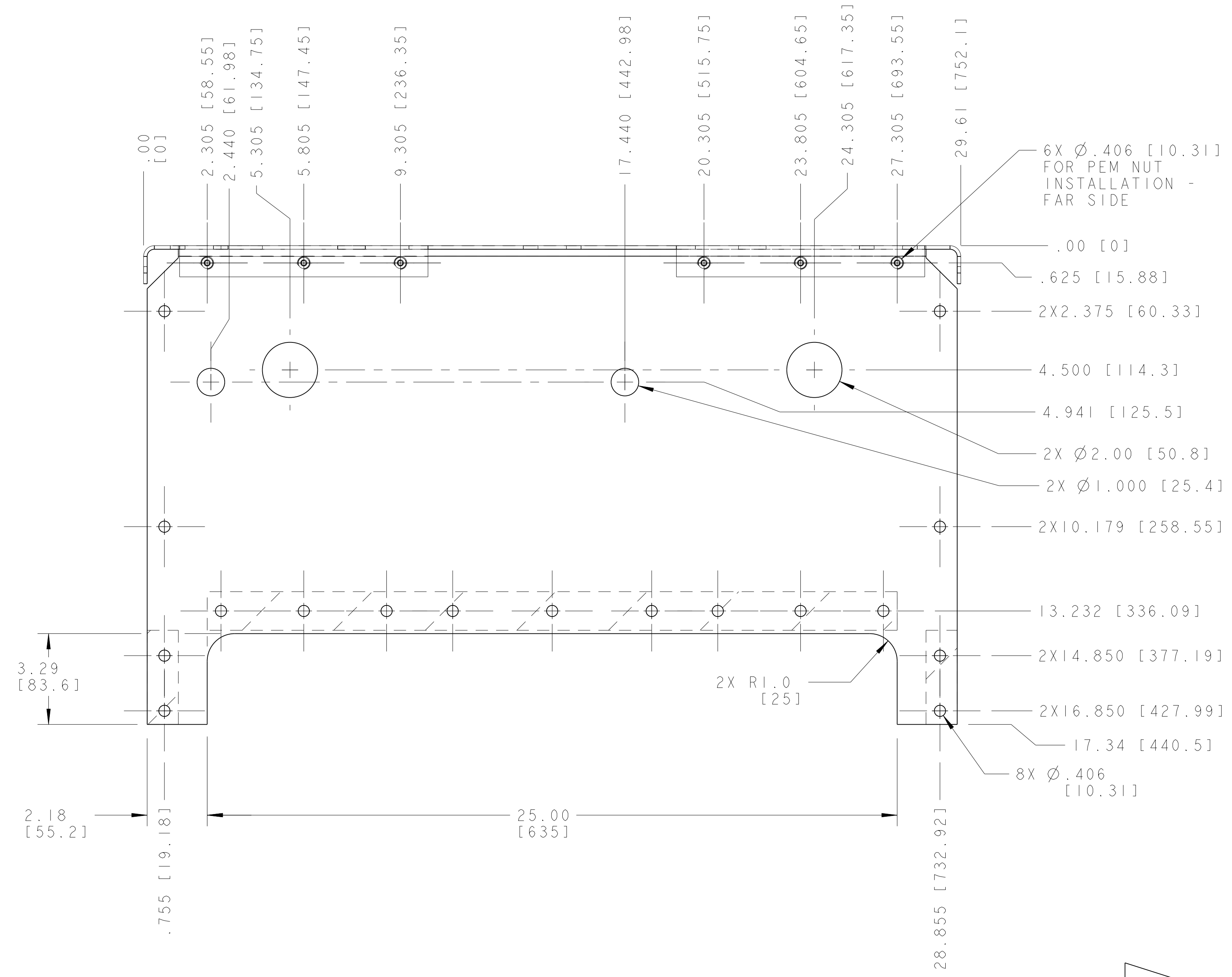
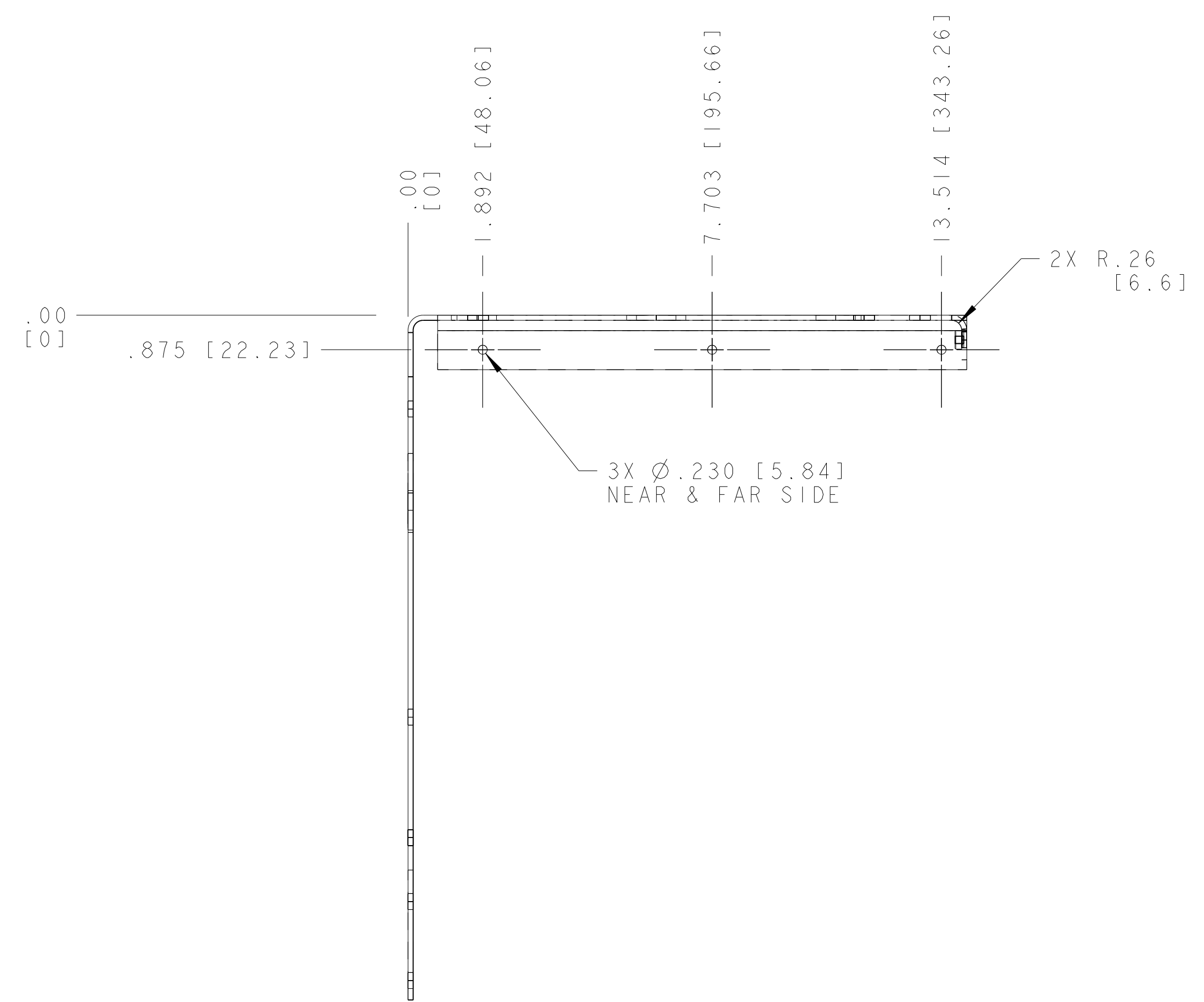
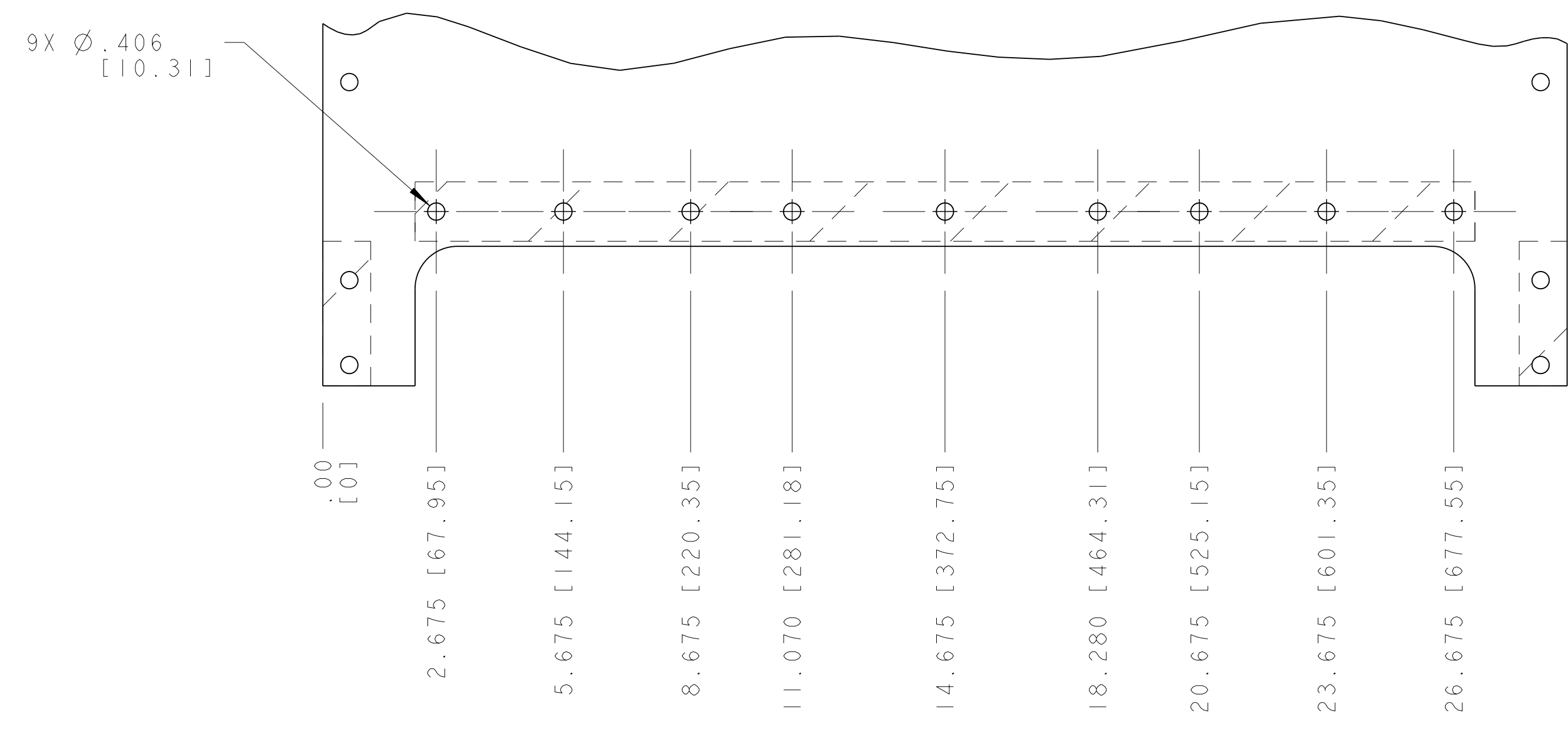
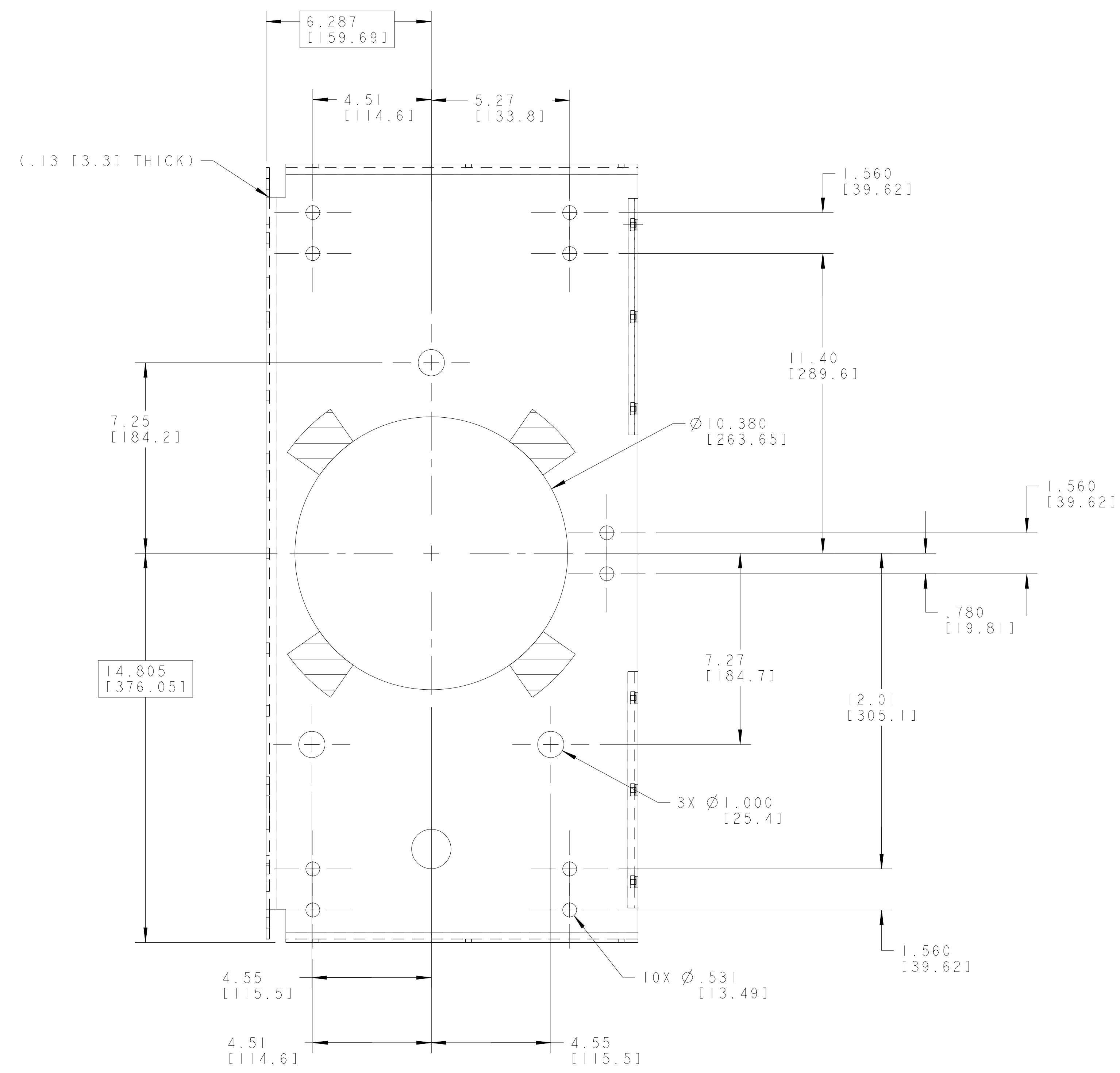

ERNEST ORLANDO LAWRENCE BERKELEY NATIONAL LABORATORY				UNIVERSITY OF CALIFORNIA - BERKELEY	
LHC IR FEEDBOX CRYGENICS					
TOP SHIELD, DFBXA/DFBXC/DFBXG					
MICROFILMED:	DWG. TYPE:	SHOWN ON:	SCALE:	3/8	DO NOT ENLARGE
	ASSEM				
PATENT CLEAR:	DESIGN ACCT. NO:	CATEGORY CODE:	DWG. NO.:	2510716	REV.:
	5ZLCE2	LH2003			B

2510716 B 2

8 7 6 5 4 3 2 1

D

C

B

A

D

C

B

A

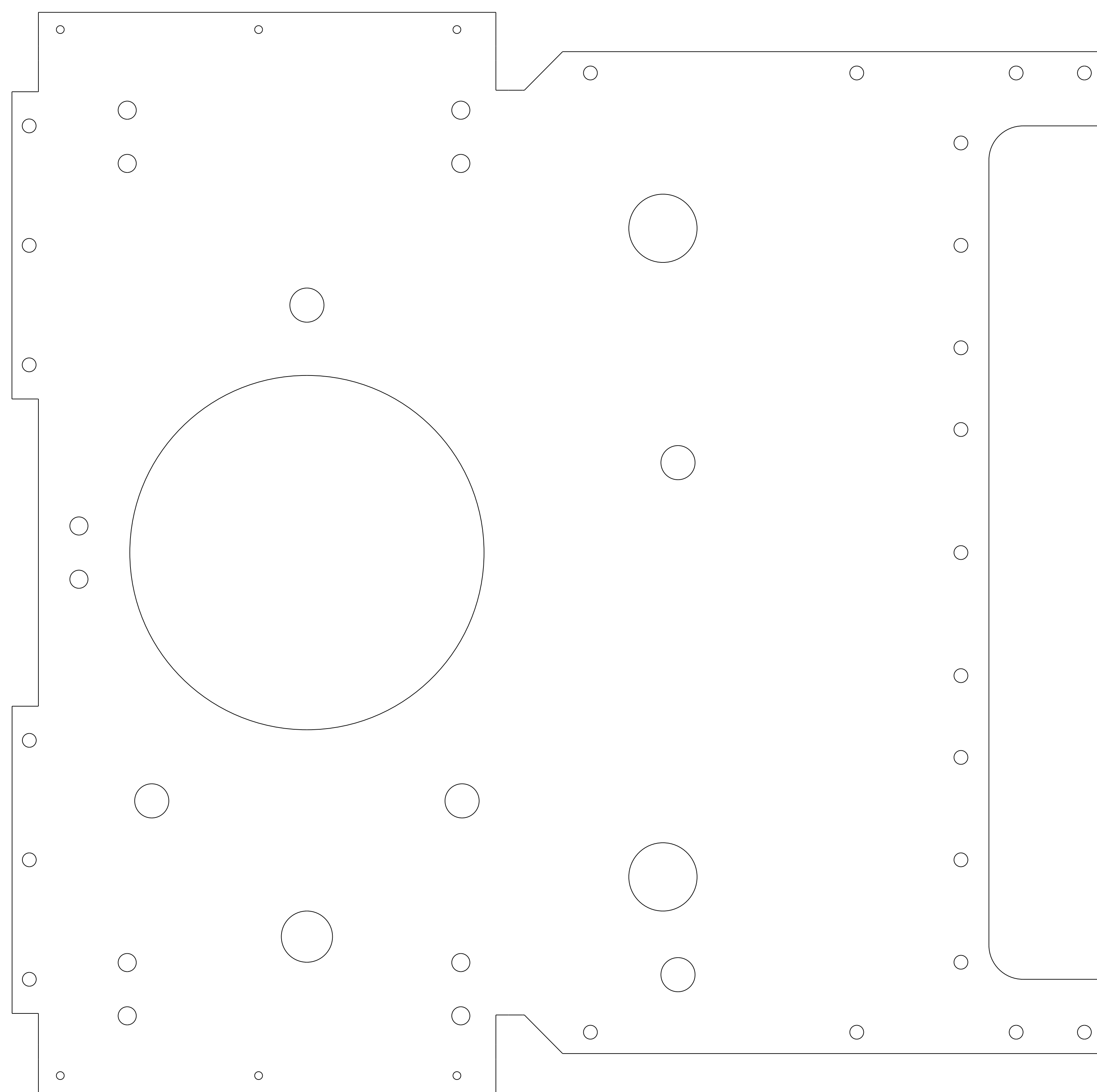
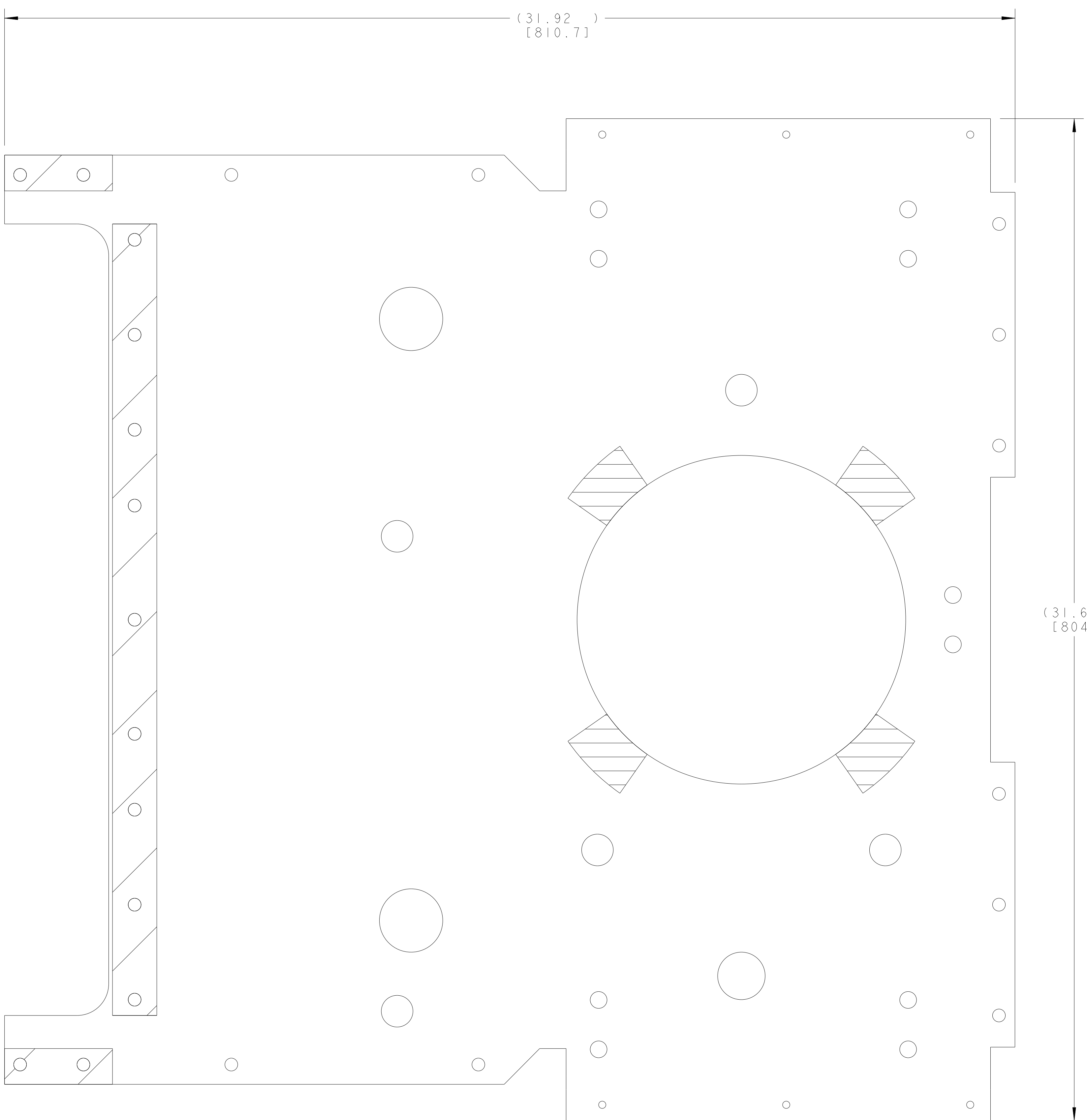

SCALE 1/2

FLAT PATTERN SCALE: 1/2

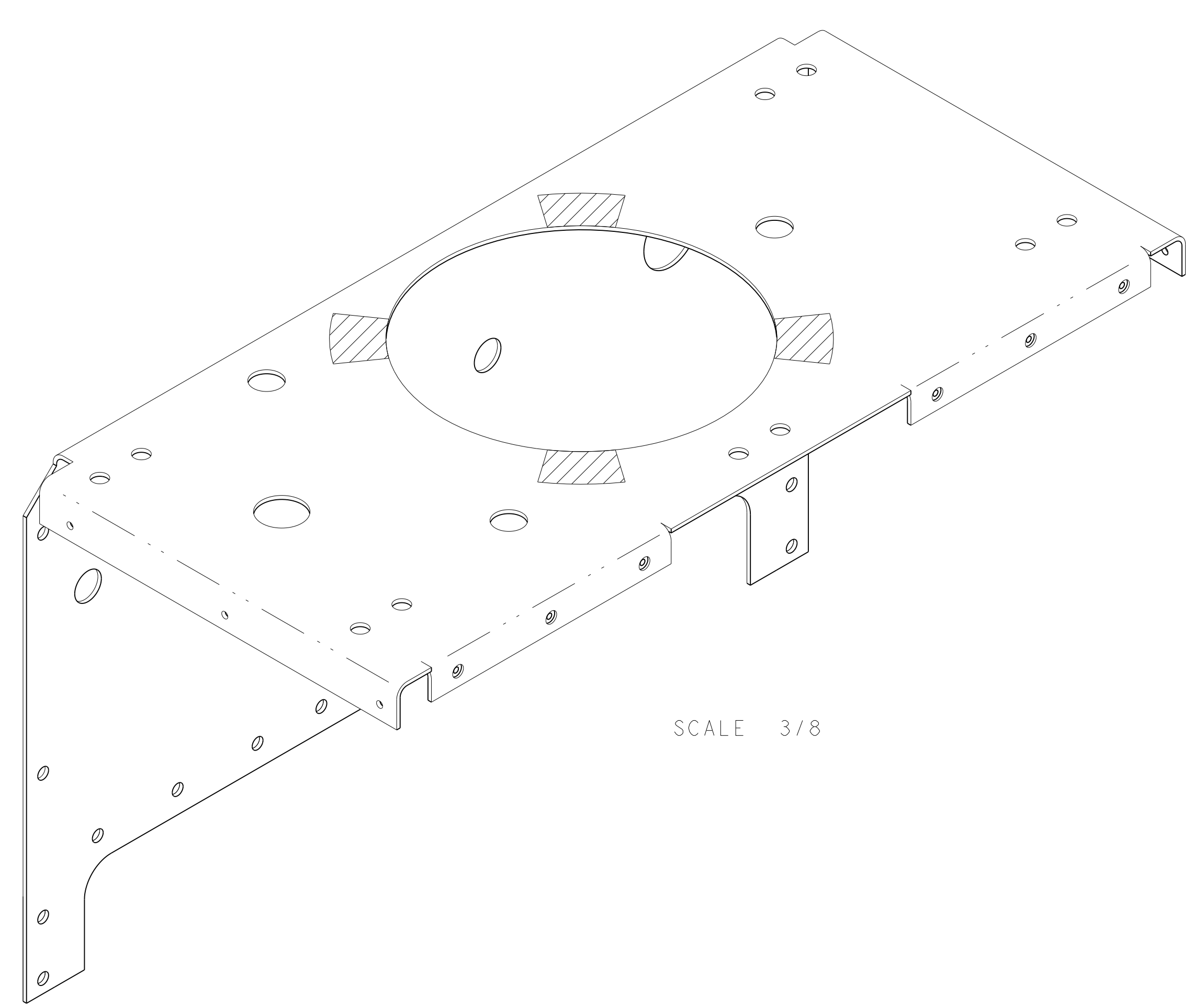

SCALE 3/8

8 7 6 5 4 3 2 1

ERNEST ORLANDO LAWRENCE BERKELEY NATIONAL LABORATORY				UNIVERSITY OF CALIFORNIA - BERKELEY	
LHC IR FEEDBOX CRYOGENICS					
TOP SHIELD, DFBXA/DFBXC/DFBXG					
MICROFILMED:	DWG. TYPE:	ISSUED ON:	SCALE:	DO NOT ENLARGE	
	ASSEM		3/8	SHEET 3 OF 3	
PATENT CLEAR:	DESIGN ACCT. NO.	CATEGORY CODE:	DWG. NO.:	SIZE:	REV.
	5ZLCE2	LH2003	2510716	B	

DWG. NO. 2510716