



# MEBT MEETING AGENDA

September 13, 2001

---

## Mechanical Systems Update

1. **Raft 3 Assembly Status** ([photos](#))
2. **Fabrication and Procurement Update**
  - Raft weldments
  - Profile Monitor Beambox Welding
  - Beampipe welding underway
  - Other fabrications underway:
    - Rebuncher Shims, Main Shop
    - BPM clips
    - Raft Water Manifolds
3. **Rebuncher Cavity #4 Status** ([drawing](#))
4. **Design Status** ([MEBT](#))
  - Beambox welding drawings underway
  - Water system design underway

## Electrical Systems Update

1. **Low Level RF**
2. **Rebuncher System**
3. **Beam Diagnostics**

## System Integration / Installation

### Upcoming Tasks and Milestones

- |                                       |            |
|---------------------------------------|------------|
| ◆ Raft and Support Structure Complete | 5/31/01 OR |
| ◆ Rebuncher Cavity #2-4 Received      | 6/30/01    |
| ◆ Profile Monitor all complete        | 7/31/01    |
| ◆ MEBT Raft 3 assembly complete       | 9/30/01    |

*Next Meeting: Thursday, 9/27/01, 10 AM*

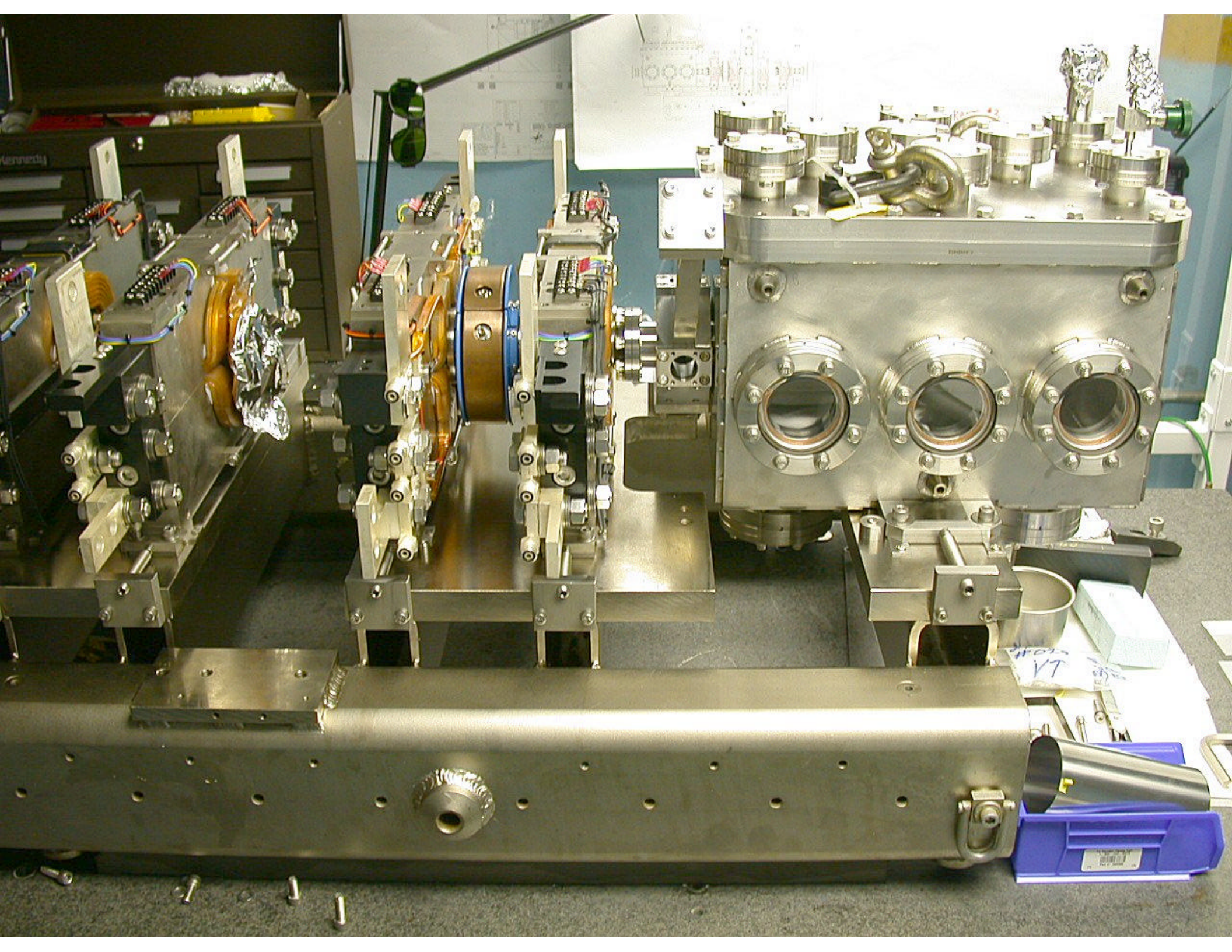

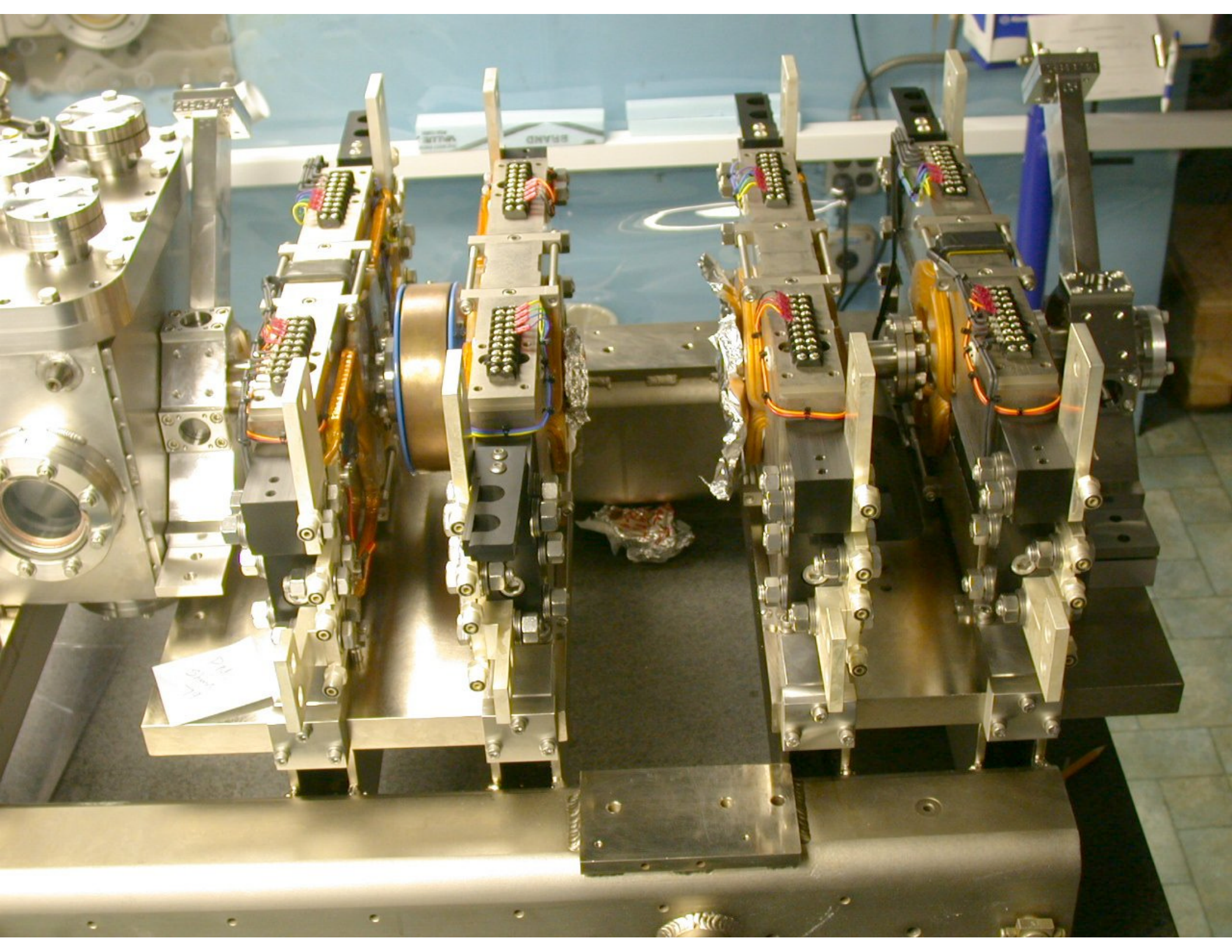

D11  
S11  
71

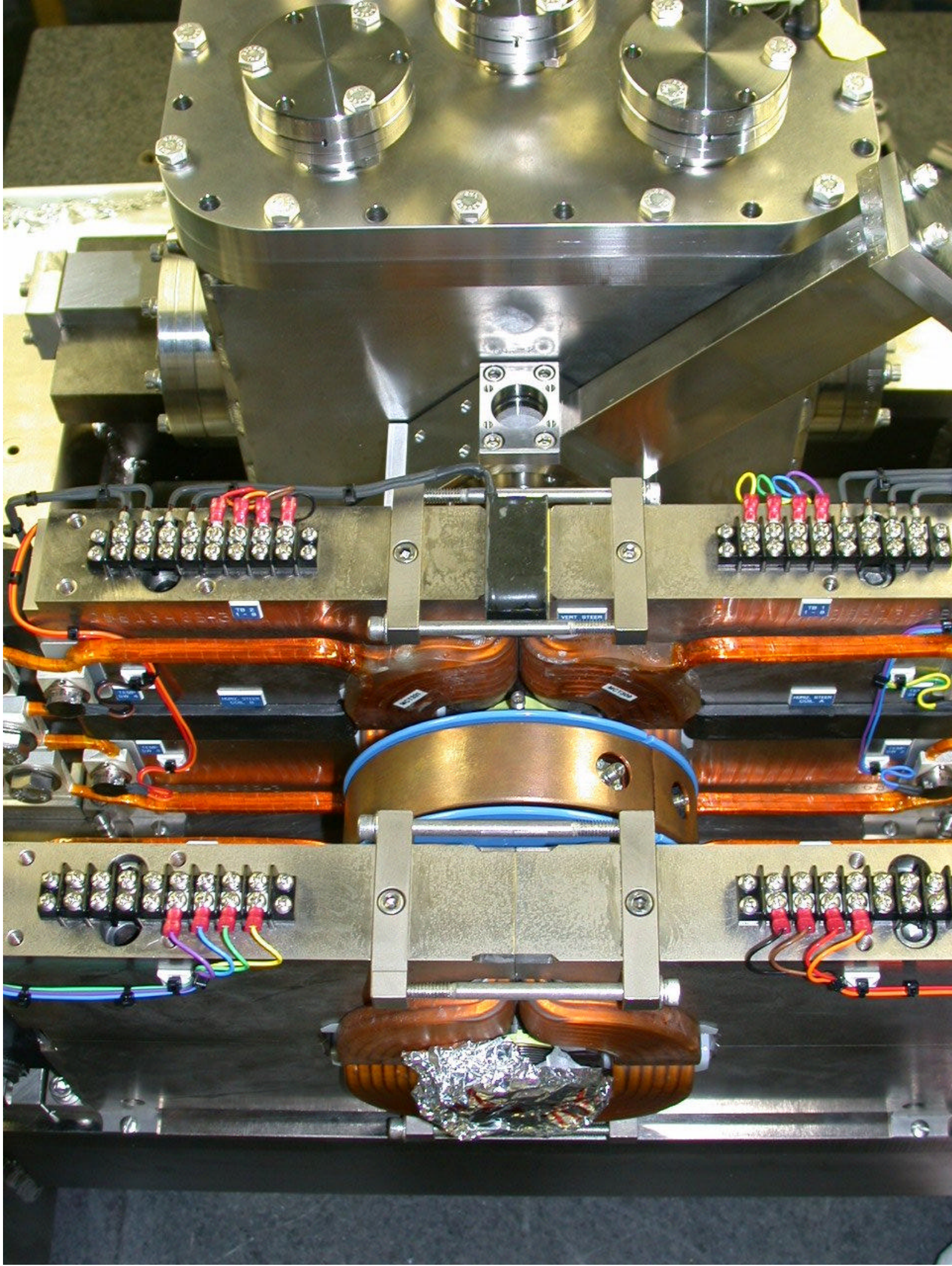

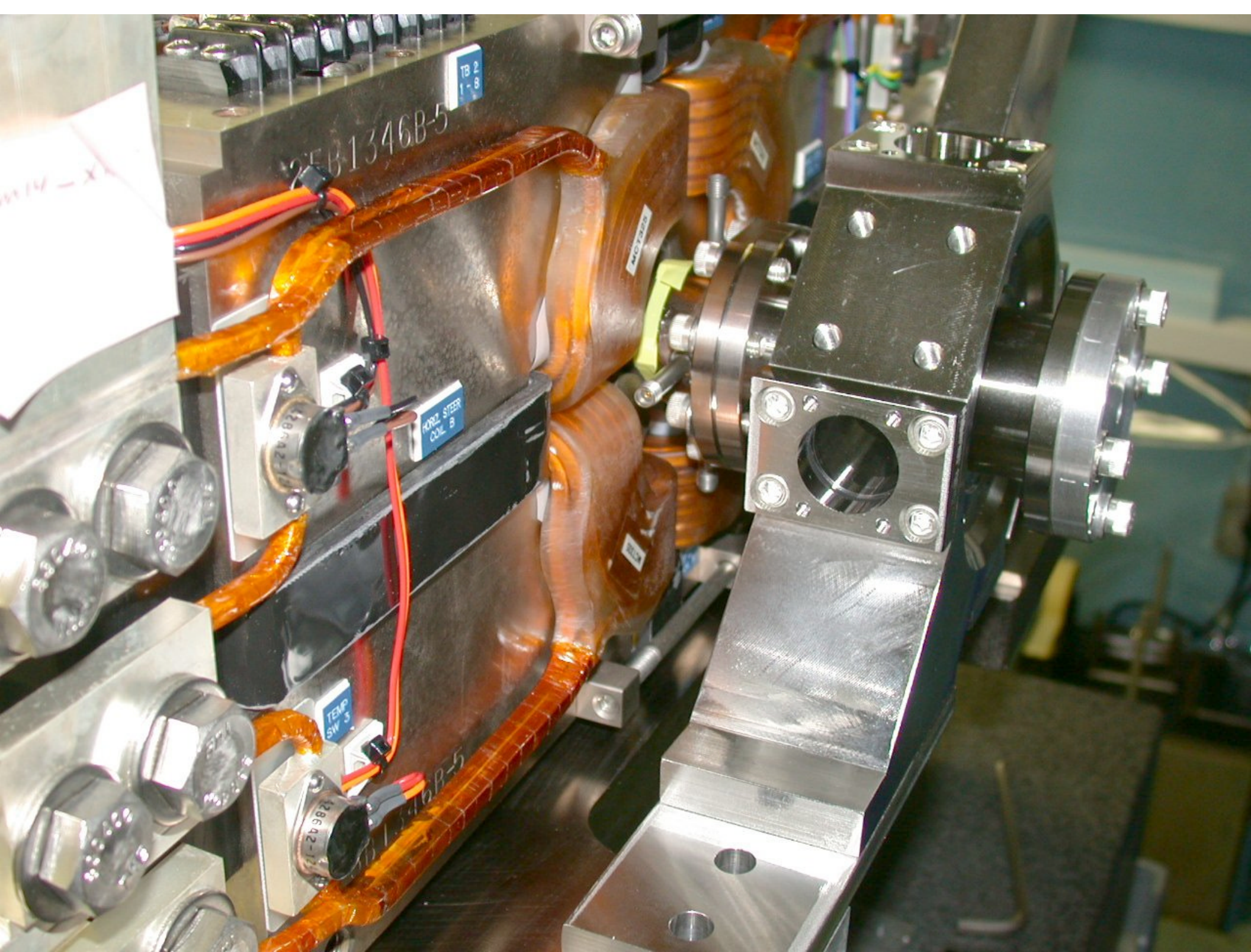

2EB1346B-5

TB 2 8

X-114

HORIZ STEER COIL B

TEMP SW 3

18642-11

2EB1346B-5

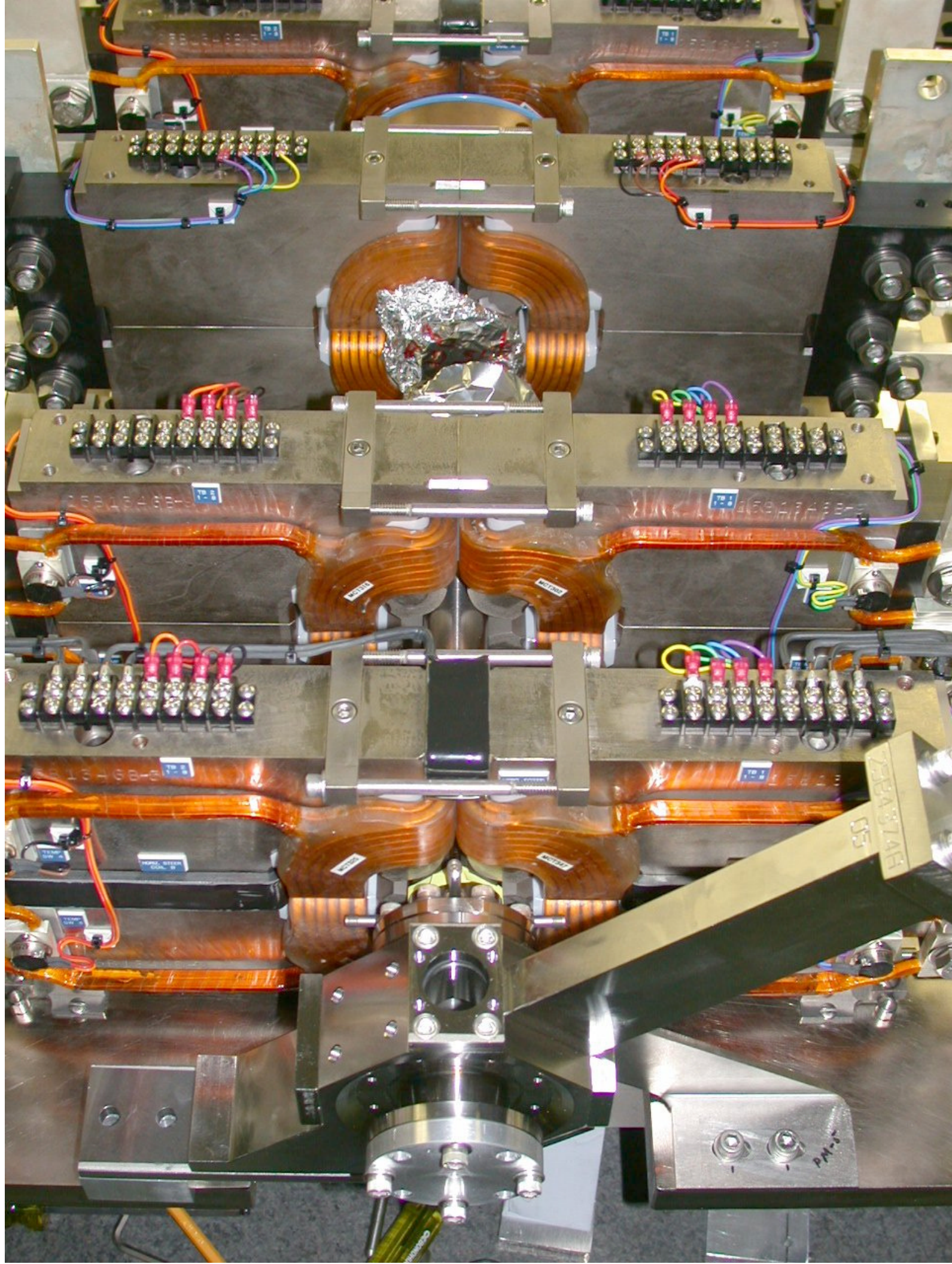

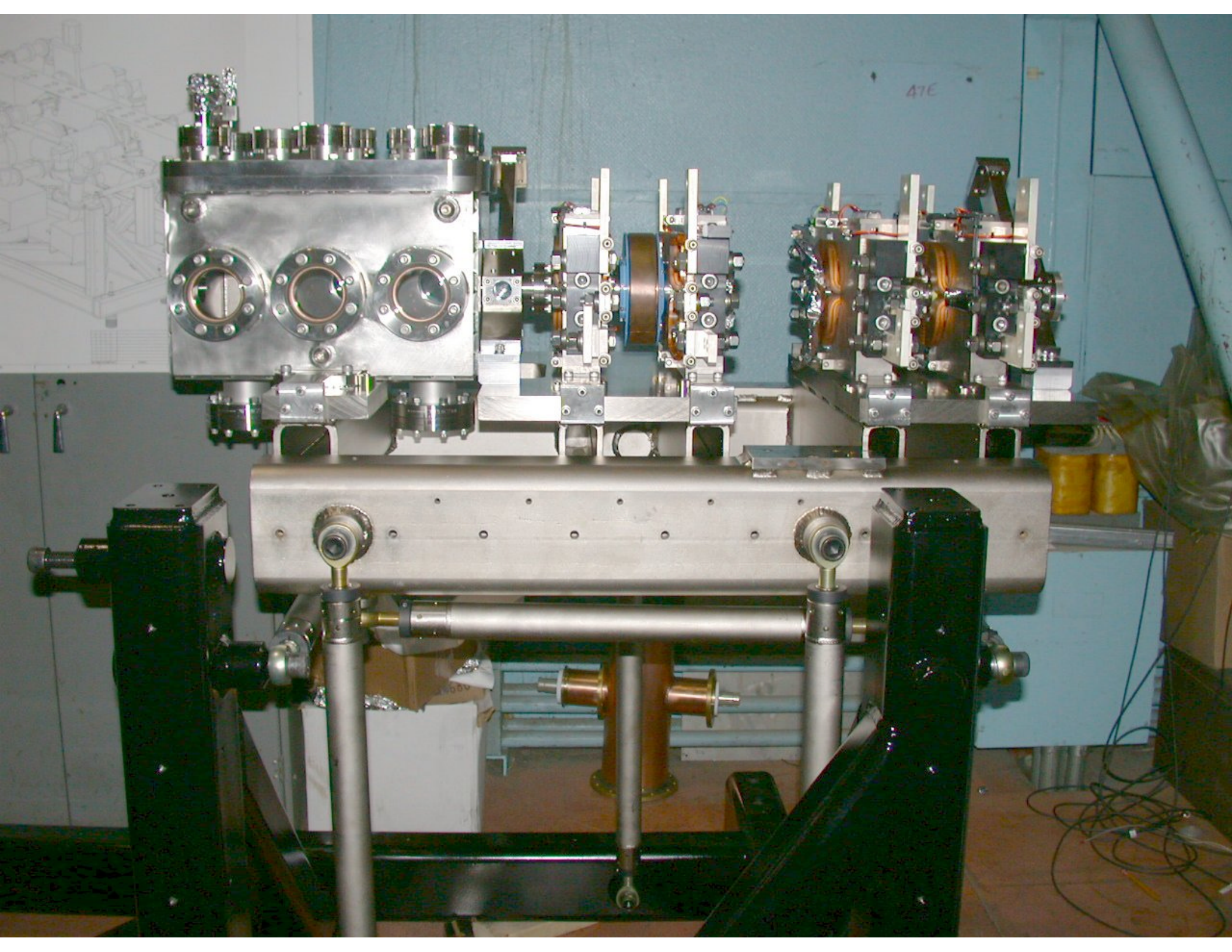

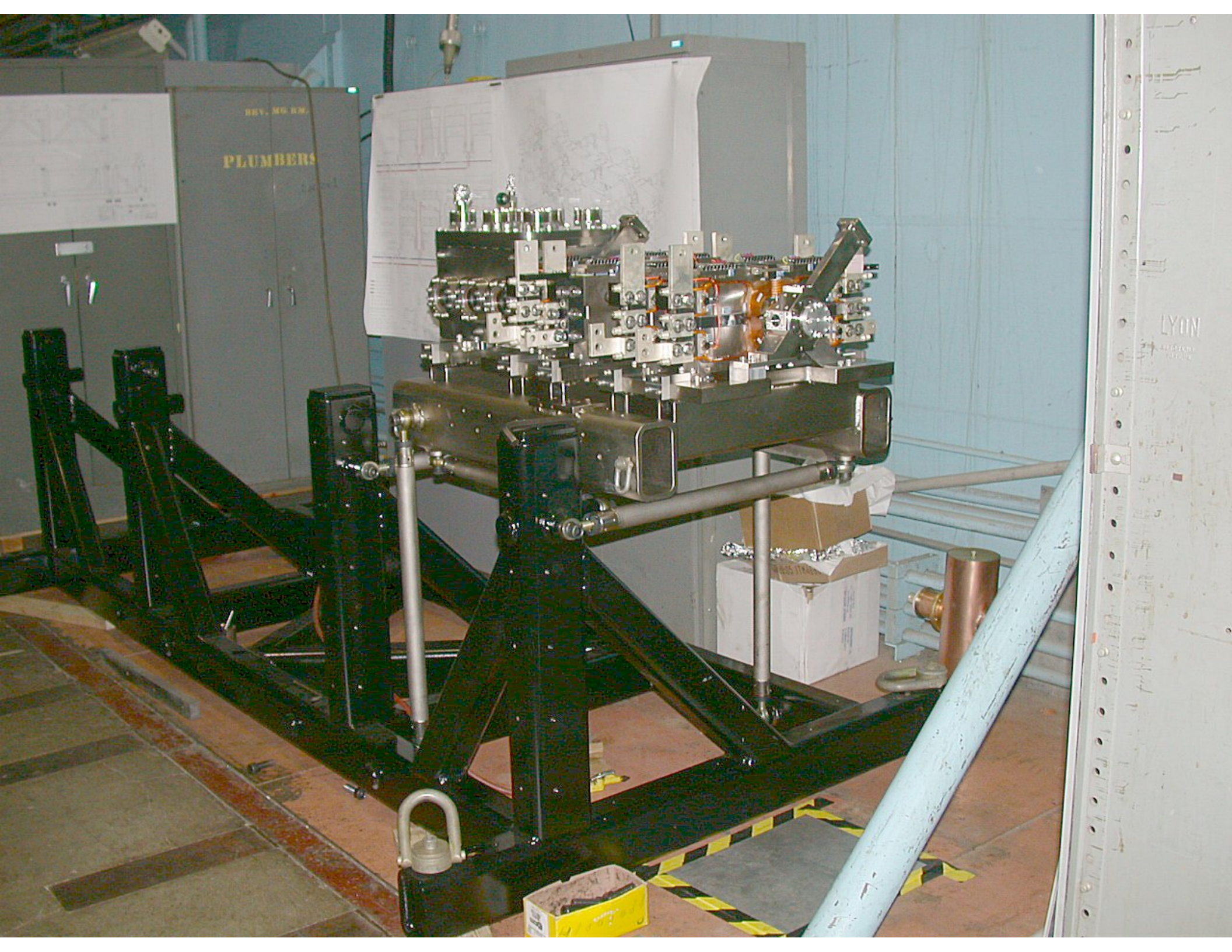

PLUMBERS

LYON



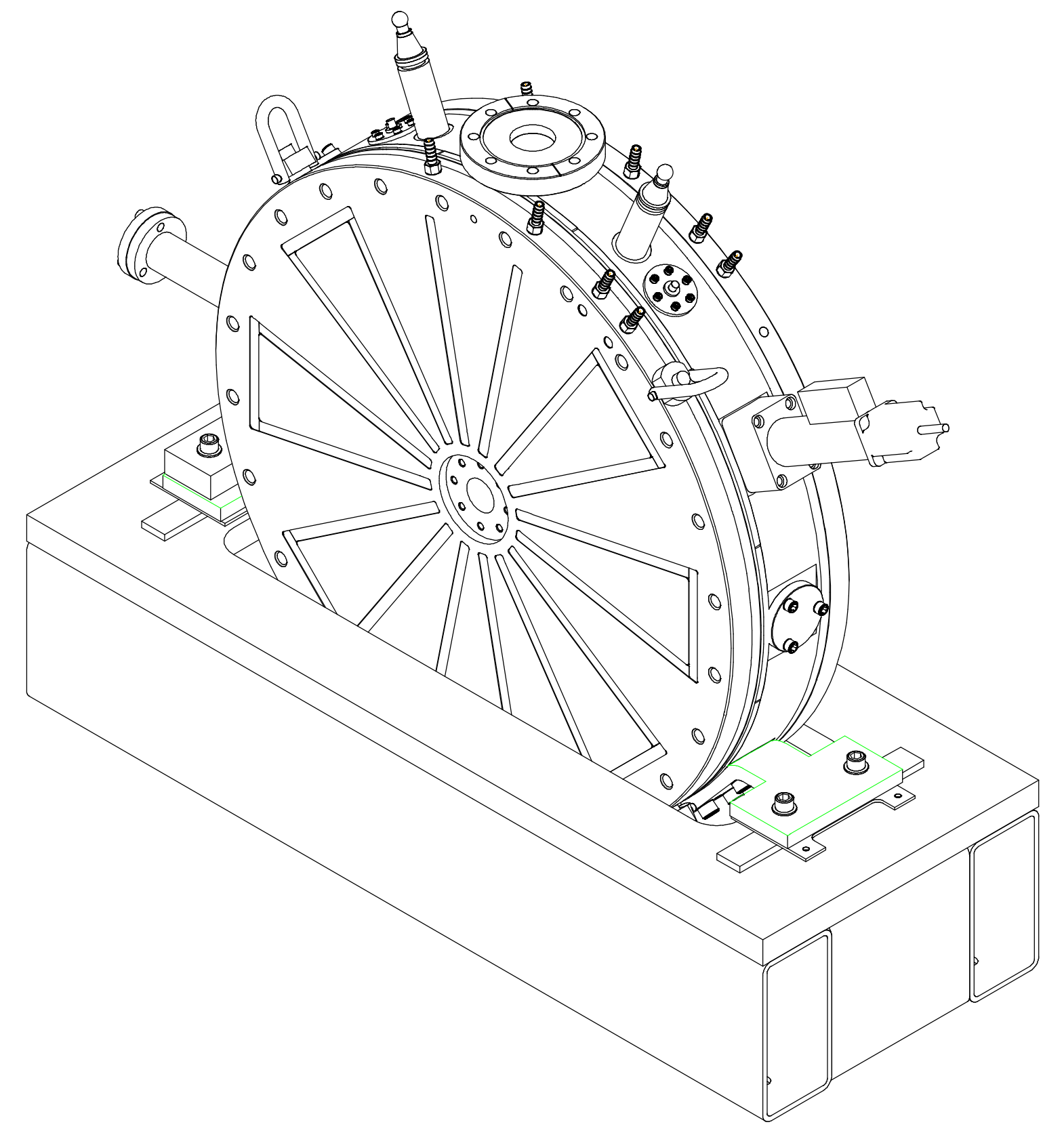
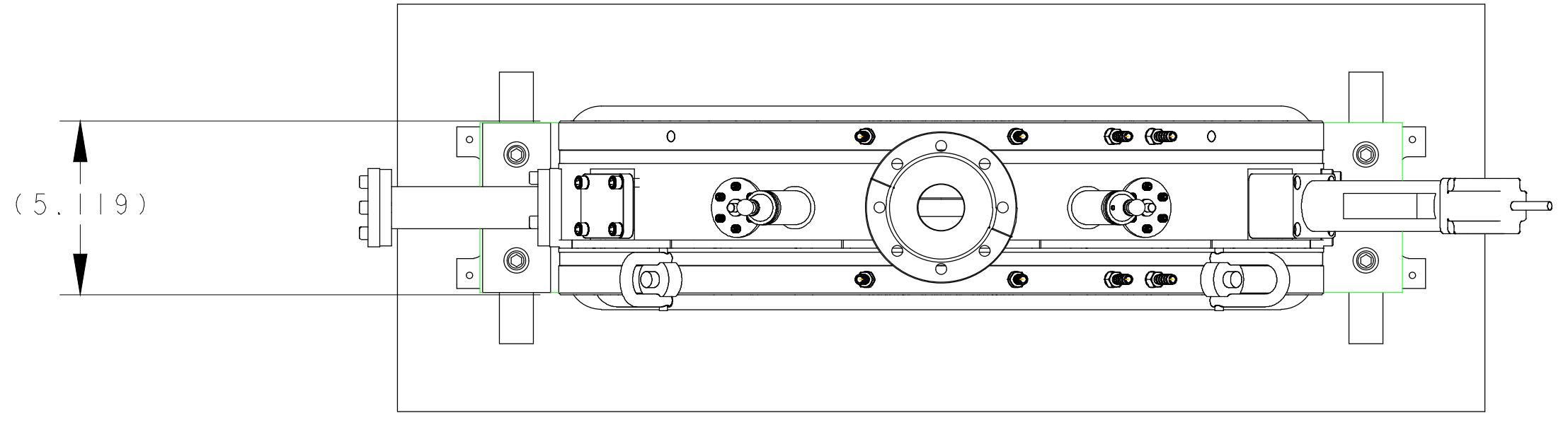

**PRELIMINARY, NOT RELEASED**

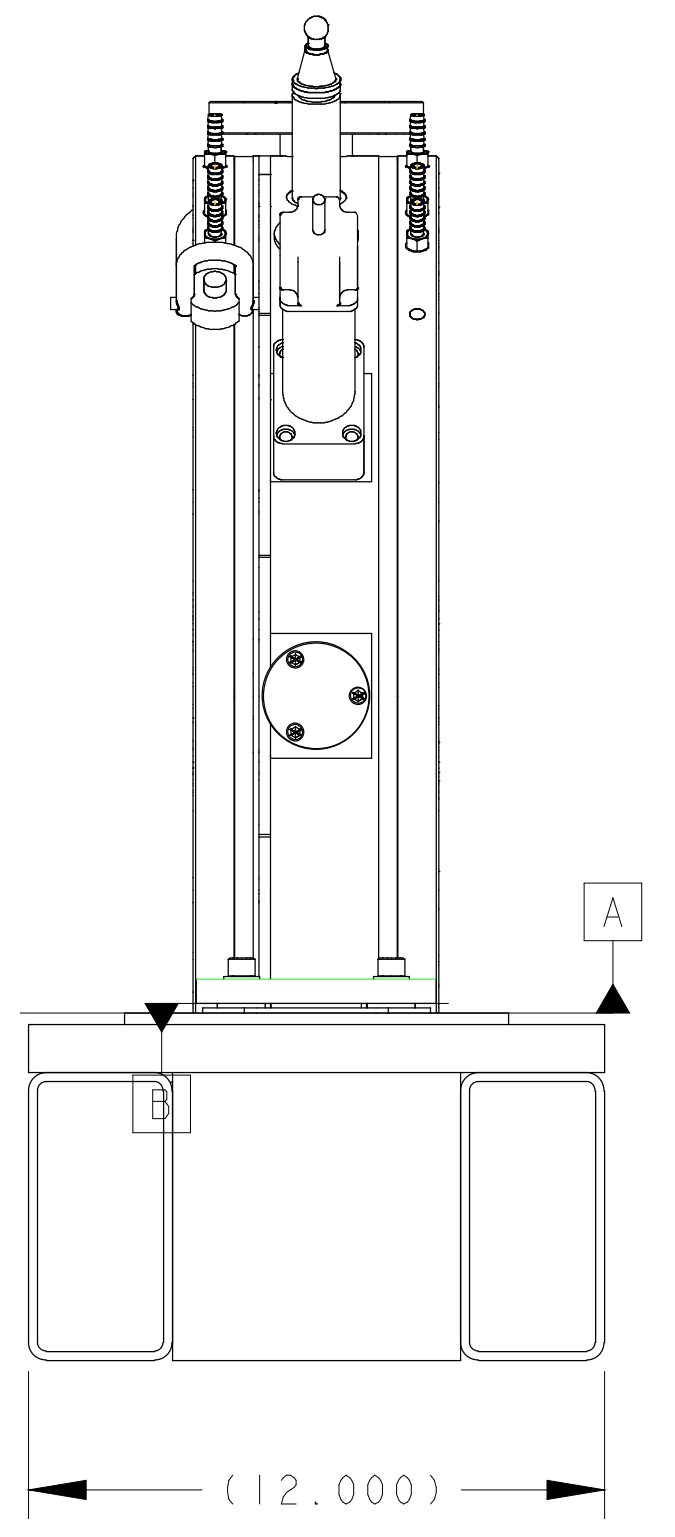
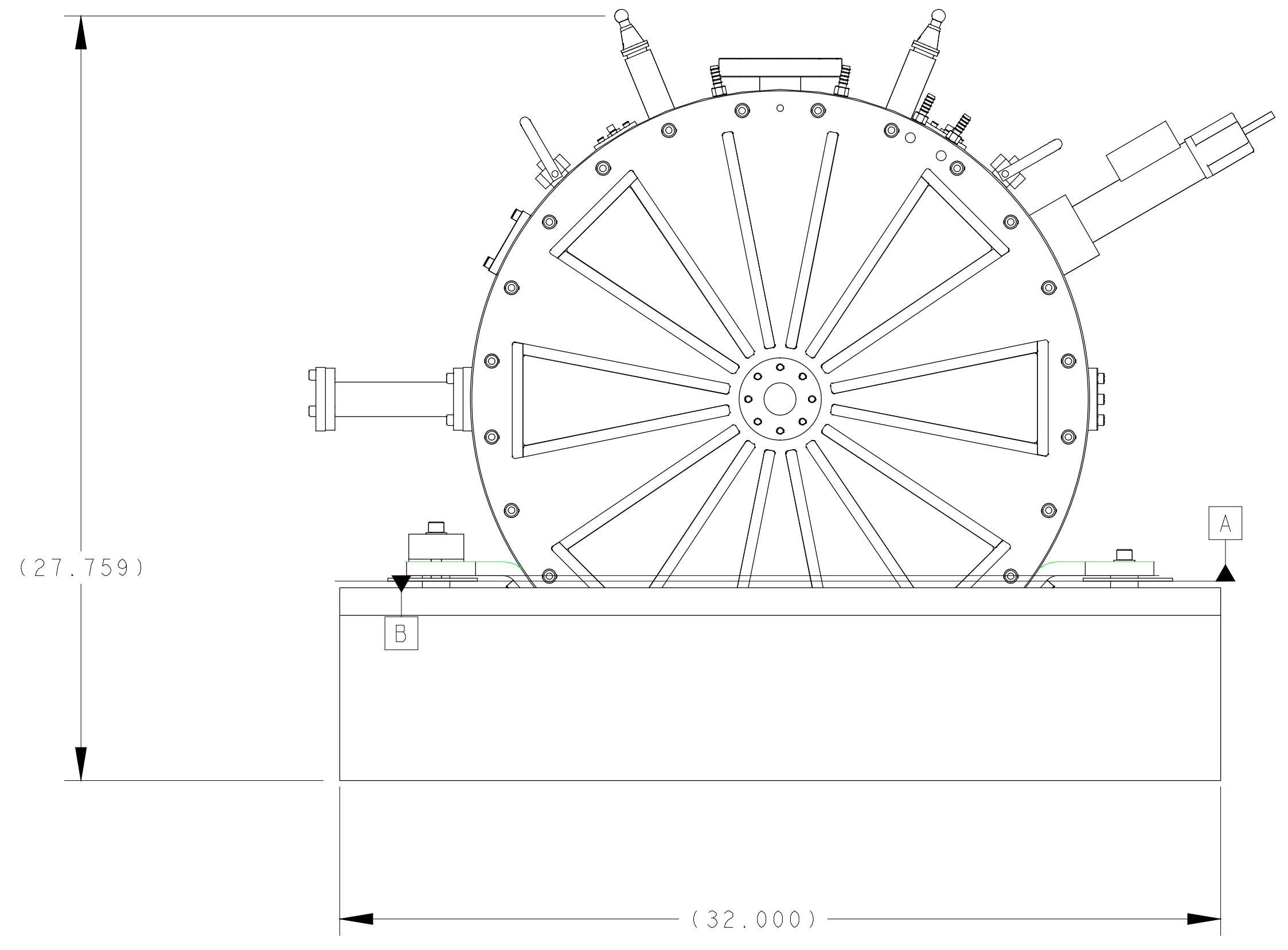

ITEM	PART NO	REQD	DESCRIPTION	MATERIAL
8	nnXnnn	1	THIRD LINE TITLE	-
7	98017A205	4	3/8" FLAT WASHER AN 960 C, MCMASTER-CARR OR EQUIV	18-8 SST
6	92196A634	2	3/8-16 UNC, 2.5 LG SOC HD SCREW, MCMASTER-CARR OR EQUIV	18-8 SST
5	92196A628	2	3/8-16 UNC, 1.5 LG SOC HD SCREW, MCMASTER-CARR OR EQUIV	18-8 SST
4	25B702	1	T-BAR, REBUNCHER	SST, 304 PRODEC
3	25B479	1	Y-SHIM, DUPLEX, REBUNCHER	SST, 304 PRODEC
2	25B475	1	Y-SHIM, SIMPLEX, REBUNCHER	SST, 304 PRODEC
1	25B472	1	REBUNCHER FIDUCIALIZATION STAND	CARBON AND STAINLESS STEEL

REV	DWG	CHK	ZONE	DATE	CHANGES

UNLESS OTHERWISE SPECIFIED		SHOP ORDERS	
PROJECTION:		ACCT NO.	SER NO.
TOLERANCES	X.X ± 0.1    FRAC. ± 1/64	NO. REQD	DATE REQD
	X.XX ± 0.03    Angles ± 1.0°		
	X.XXX ± 0.010    FINISH 125/		
DO NOT SCALE PRINT		SURFACE TREATMT	TAG
THREADS ARE CLASS 2		IDENT METHOD	PROJECT NUMBER
CHAMFER ENDS OF ALL SCREW TREADS 30°		PROJECT NAME	N/A
CUT ROUNDS, 1.5 THREAD RELIEF ON MACHINED THREADS		DWG BY	D. OSHATZ
BREAK EDGES .016 MAX. ON MACHINED WORK		CHK BY	-
REMOVE BURRS, WELD SPLATTER & LOOSE SCALE		DATE	12-Sep-01
IN ACCORDANCE WITH ASME Y14.5M & B46.1		APR BY	D. OSHATZ
		DATE	

**ERNEST ORLANDO LAWRENCE BERKELEY NATIONAL LABORATORY**  
UNIVERSITY OF CALIFORNIA - BERKELEY

**SNS - FES MBT**  
BEAM TRANSPORT SYSTEMS  
REBUNCHER FIDUCIALIZATION DATA

MICROFILMED:     DWG. TYPE: ASSEM    SCALE: 1/4    DO NOT SCALE PRINTS

PATENT CLEAR:     SHOWN ON:     SHEET 1 OF 1

DESIGN ACCT. NO. FE3312    DWG. NO. 25B7324    SIZE A    REV. 1

