

DETAIL B  
SCALE 8 : 1

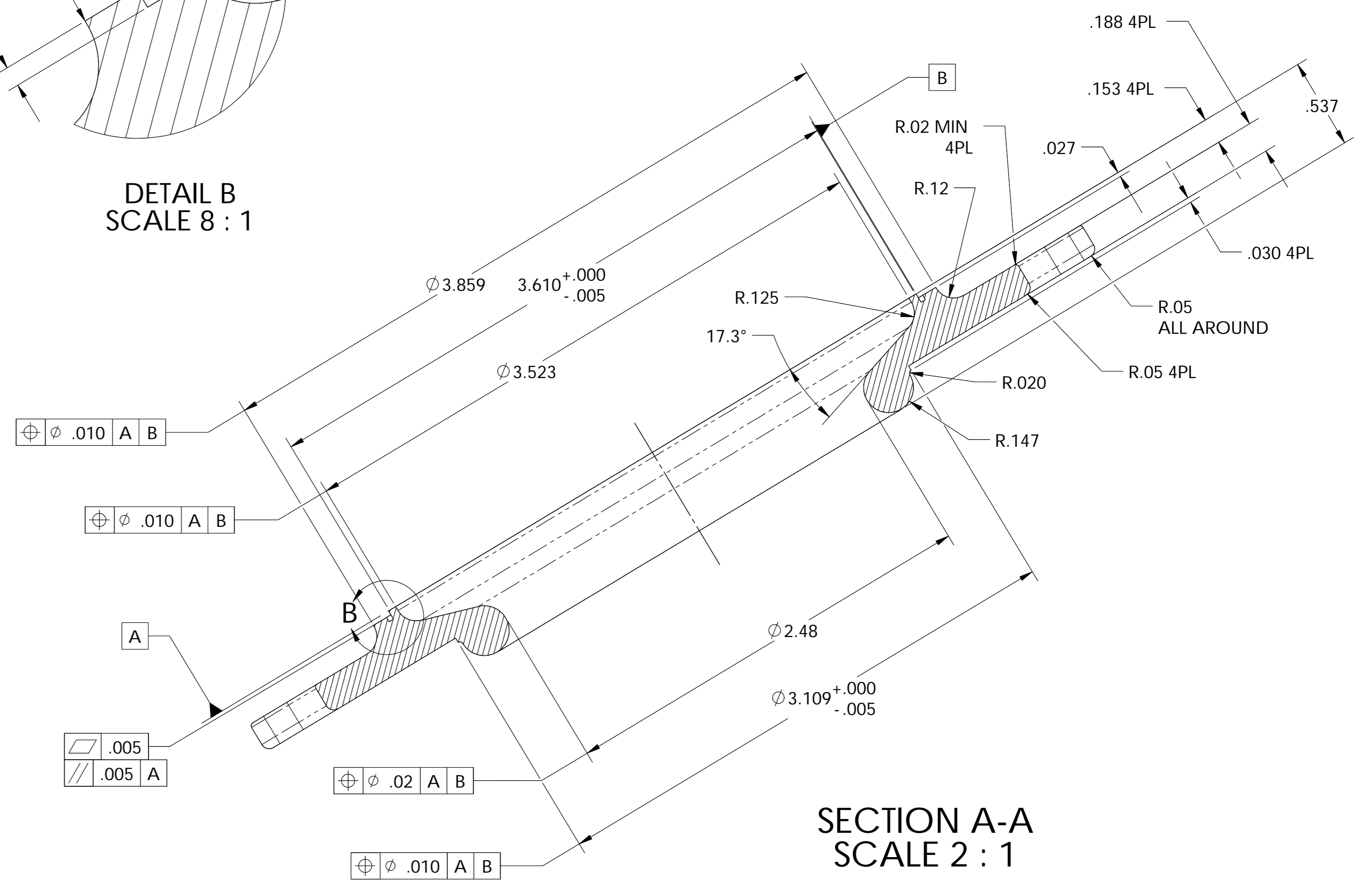

SECTION A-A  
SCALE 2 : 1

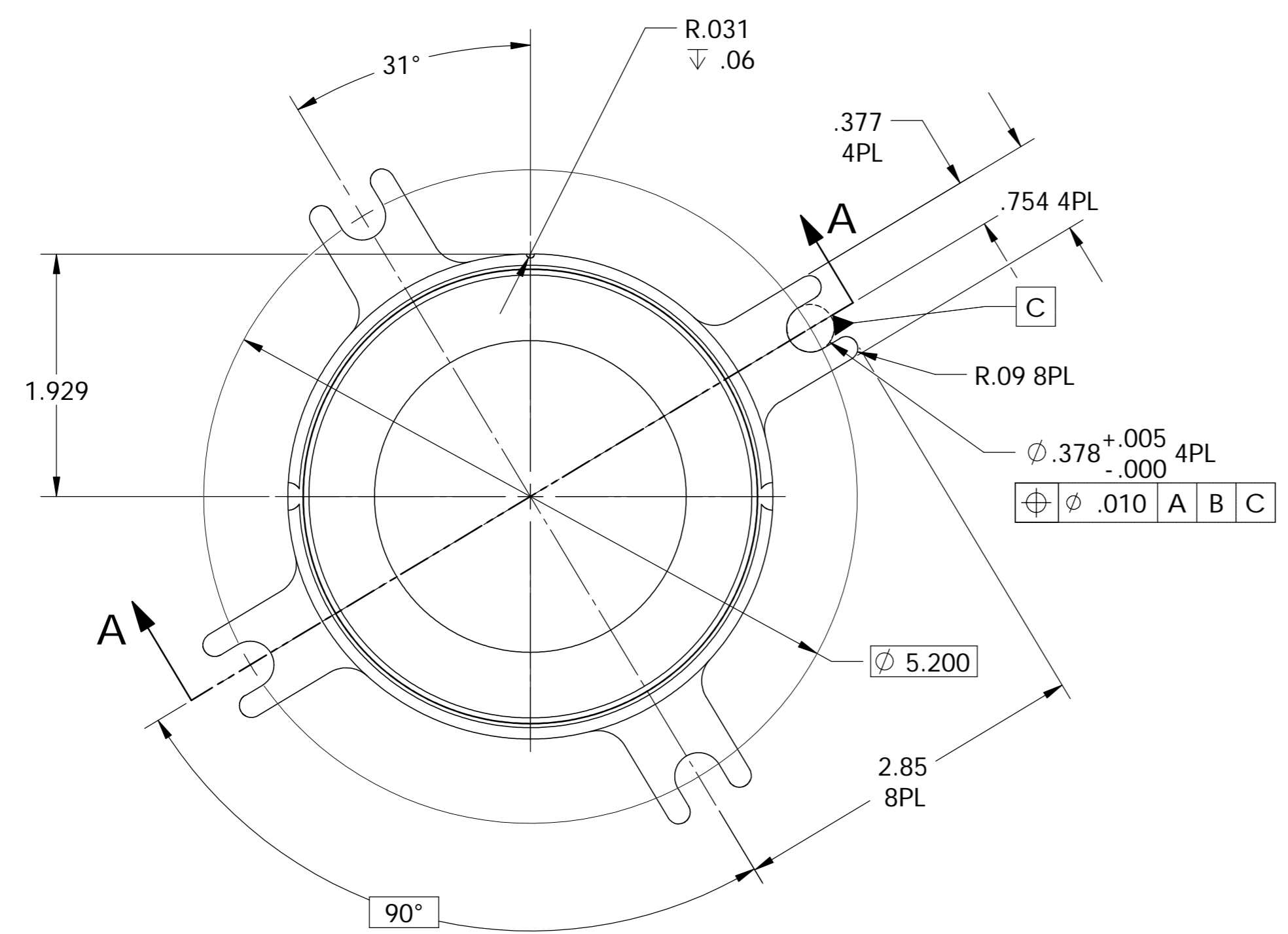
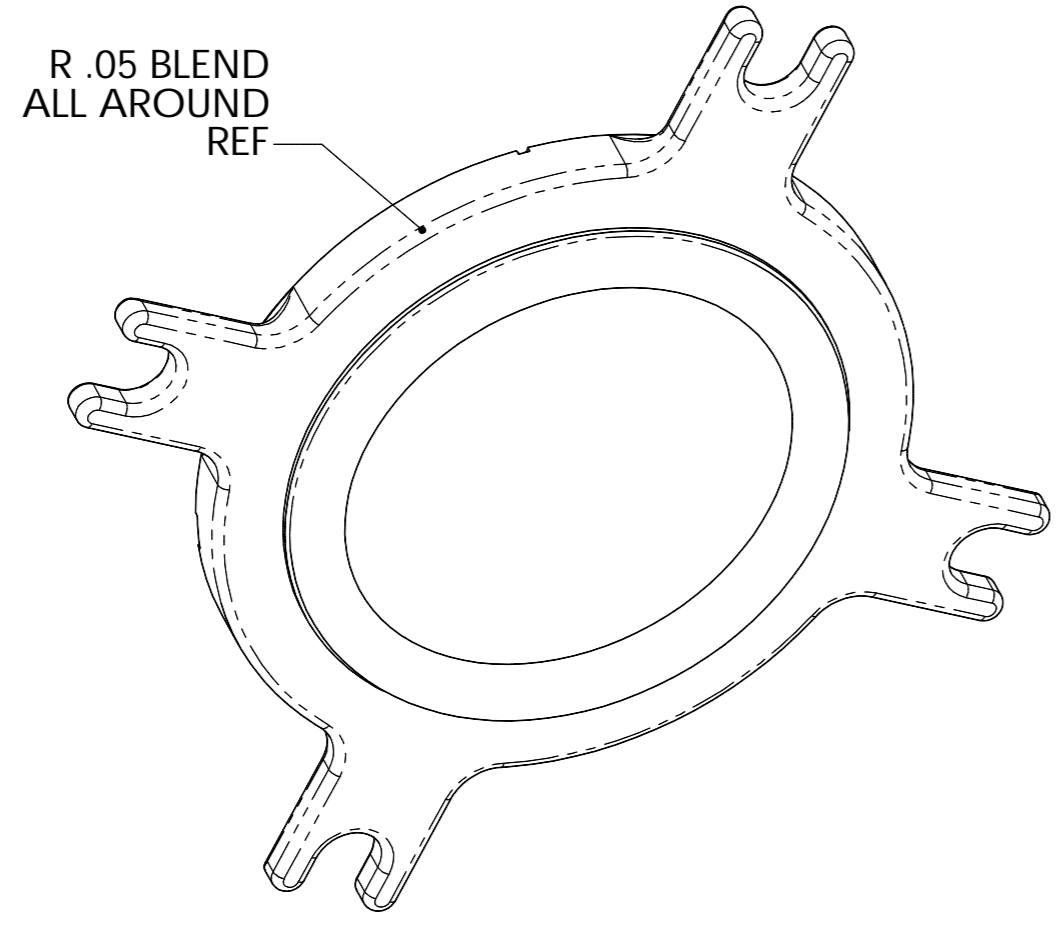
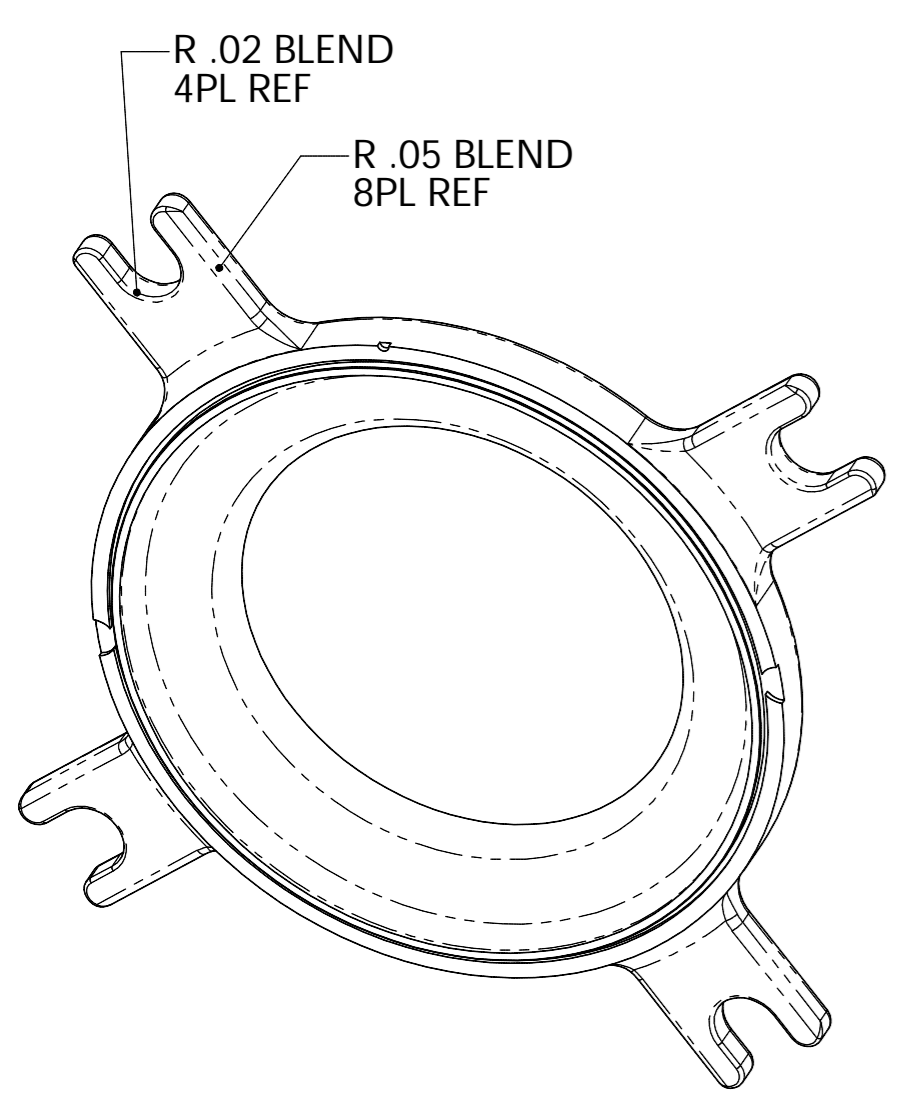

REV	DRAWN BY	APPVD.	DATE	DESCRIPTION
B	PAL	R. KELLER	12/15/03	CHANGED EBW JOINT DESIGN TO BRAZE. REVISED MATL.
A	PAL	R. KELLER	11/20/03	INITIAL RELEASE

UNLESS OTHERWISE SPECIFIED			PROJECT NAME:		SST, 304L	
.X ± 1_INCH .XX ± .01_INCH .XXX ± .005_INCH			PROJECT NUMBER:		DESCRIPTION	
FRACTIONS: -/-			NEXT ASSEMBLY:		27A343	
ANGLES: 0.1° / INCH			CALC. WT.		KG. 0.62 LB.	
MACH. SURFS.: 125 MICRO-INCH ✓			SCALE: 1:1		CATEGORY CODE:	
DO NOT SCALE DRAWING. INTERPRET PER ASME Y14.5M-1994. THREADS ARE CLASS 2. BREAK MACHINED EDGES .016 MAX. REMOVE BURRS, WELD SPLATTER & LOOSE SCALE.			THIRD ANGLE PROJECTION			
ERNEST ORLANDO LAWRENCE BERKELEY NATIONAL LABORATORY UNIVERSITY OF CALIFORNIA						
HYBRID ION SOURCE (HYBRIS)				WELDMENT, EXTRACTOR		
FLANGE, EXTRACTOR / CATHODE				SHEET 1 OF 1		
DWG NO: 27A346				REV B		