

NOTE: MODEL DEFINES GEOMETRY

FABRICATION PROCESS	MATERIAL	MATERIAL LOCATION
	Clear Acrylic	

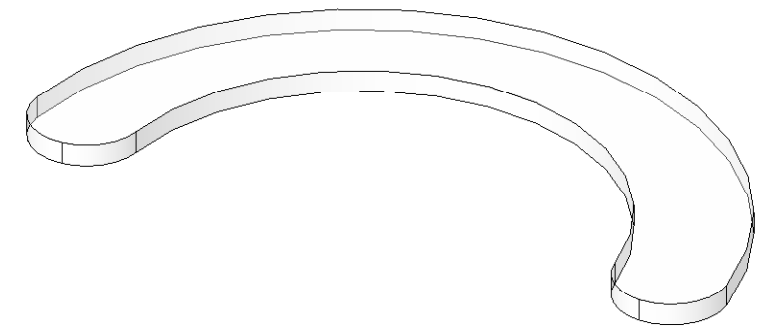
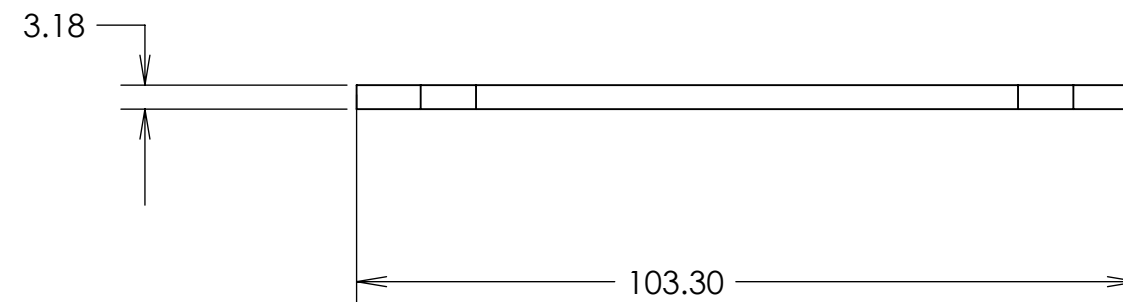
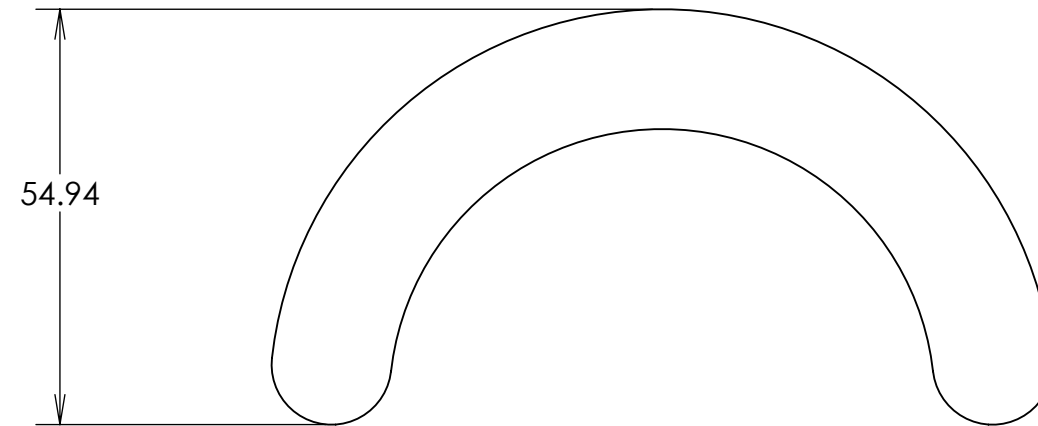

CURRENT CONFIGURATION:  
Default

						TOLERANCES	UNLESS OTHERWISE SPECIFIED		SHOP ORDERS		SER NO. -	<div>ERNEST ORLANDO LAWRENCE BERKELEY NATIONAL LABORATORY UNIVERSITY OF CALIFORNIA - BERKELEY</div> <div>PHENIX Barrel Support Tooling Curved Plenum Cover, Barrel 2 Bonding Fixture</div>				
							X.X ± 0.5	FRAC. ± 1/64	ACCT NO.	NO. REQ'D	DATE ISSD -					
							X.XX ± 0.05	Angles ± 1.00°	DEL TO		DATE REQ'D -					
							X.XXX ± 0.010	FINISH $\sqrt[25]{\text{lin}}$	SURFACE TREATMT - None							
							DO NOT SCALE PRINT		IDENT METHOD							
							THREADS ARE CLASS 2		PROJECT NUMBER							
							CHAMFER ENDS OF ALL SCREW THREADS 30°		PROJECT NAME							
						CUT ROUND, 1.5 THREAD RELIEF ON MACHINED THREADS		DWG BY D Uken		DATE 6/3/2009	MICROFILMED:	DWG. TYPE		SCALE: 1:1	DO NOT SCALE PRINTS	
						BREAK EDGES .016 MAX. ON MACHINED WORK		CHK BY		DATE	PATENT CLEAR:	DESIGN ACCT. NO.	SHOWN ON	SHEET 1 OF 1		
						REMOVE BURRS, WELD SPLATTER & LOOSE SCALE		APR BY		DATE			CATEGORY CODE	DWG. NO.	SIZE	REV.
REV	DWG	CHK	ZONE	DATE	CHANGES	IN ACCORDANCE WITH ASME Y14.5M & B46.1								FNX206		A