

REQD	ITEM	PART NUMBER	DESCRIPTION
A/R	1	-	ALUMINA, 85% AI2O3
			21G7202

NOTES:

- THIS PART TO BE MACHINED GREEN (85% AI2O3) PRIOR TO FIRING.

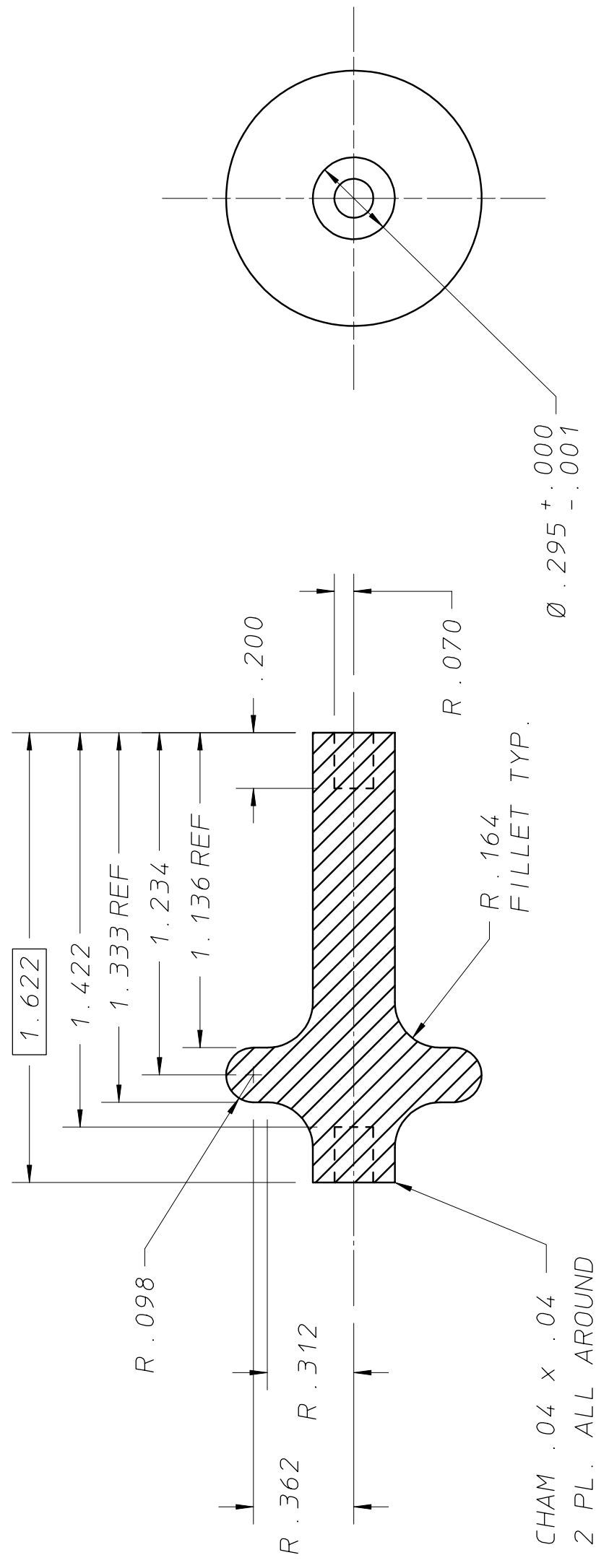

UNLESS OTHERWISE SPECIFIED	SHOP ORDERS		LAWRENCE BERKELEY LABORATORY	
TOLERANCE .X ± .1 .XX ± .01 .XXX ± .005	ACCT NO	SER NO	UNIVERSITY OF CALIFORNIA-BERKELEY	
SURFACE FINISH 32 ✓	DATE ISSD	DATE RECD	SNS-FES ION SOURCE AND LEFT MECHANICAL SYSTEMS	
1. SAWED, FLAMECUT, SHEARED OR CUT STOCK FINISH.	DELIVER TO		G3 INSULATOR STANDOFF	
2. THREADS CLASS 2.	SURFACE TREATMENT		PAT CLEAR	
3. CHAMFER ENDS OF ALL SCREW THRDS 30°.	DEGREASE		DWG TYPE	SHOWN ON
4. 1 1/2 PITCH RELIEF WITH ROUND NOSE TOOL ON ALL MACHINE CUT THRDS.	IDENTIFIC TAG		DETAIL	21G7272
5. BREAK EDGES 1/64 MAX. ON MACHINE WORK.	BY	DATE	DESIGN ACCT NO	CATEGORY CODE
6. REMOVE BURRS, LOOSE SCALE AND WELD SPLATTER.	D. CHENG	5-16-99	8210-14	FE3111
7. REF. -USASI OR ASA STDS SECT Y-14 & B46-1.	CHK BY	DATE	MICROFILMED	DWG NO
				21G7202
REV DWN	CHK	DATE	DESCRIPTION	