

NOTES (UNLESS OTHERWISE SPECIFIED):

1) DIMENSIONS IN INCHES.

2) MATL: SST, 304.

21C9862	ITEM	REQD	PART NUMBER	DESCRIPTION
	1	2		304 STAINLESS STEEL BAR STOCK

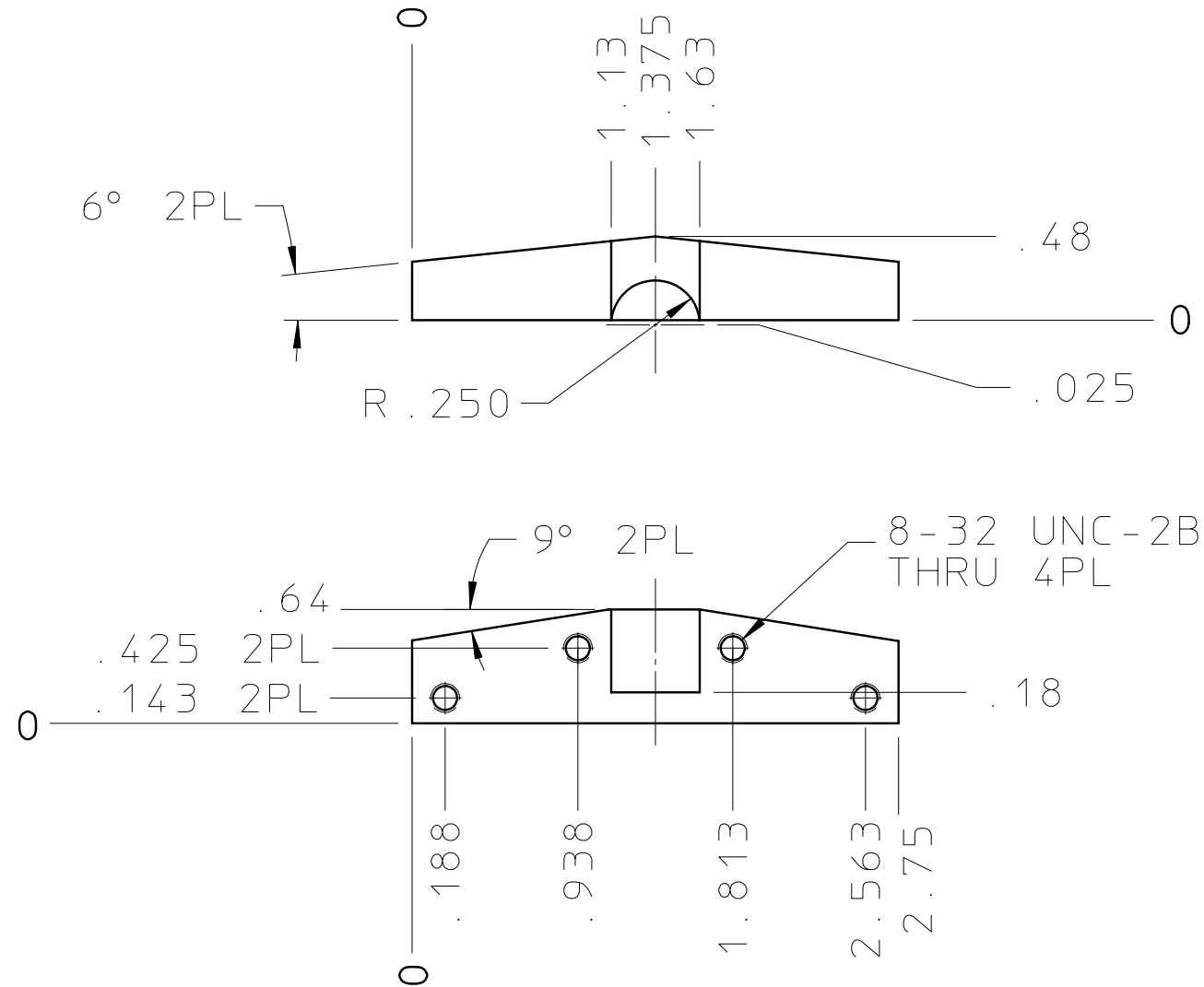

				UNLESS OTHERWISE SPECIFIED	SHOP ORDERS			LAWRENCE BERKELEY NATIONAL LABORATORY				
				TOLERANCE .X ± .1 .XX ± .01 .XXX ± .005	ACCT NO	SER NO		UNIVERSITY OF CALIFORNIA-BERKELEY				
				ANGLES: ± 0.5° SURFACE FINISH 125 ✓	DATE ISSD	DATE REQD	NO REQD	SNS - FRONT END SYSTEM				
				1. SAWED, FLAMECUT, SHEARED OR CUT STOCK FINISH. 2. THREADS CLASS 2. 3. CHAMFER ENDS OF ALL SCREW THRDS 30°. 4. 1 1/2 PITCH RELIEF WITH ROUND NOSE TOOL ON ALL MACHINE CUT THRDS. 5. BREAK EDGES 1/64 MAX. ON MACHINE WORK. 6. REMOVE BURRS, LOOSE SCALE AND WELD SPLATTER. 7. REF: ASME Y14.5M & ANSI B46.1.	DELIVER TO			ION SOURCE PROTOTYPE DESIGN				
					SURFACE TREATMENT CLEAN			PILLOW BLOCK INNER				
					IDENTIFIC METHOD TAG			PAT CLEAR	DWG TYPE	SHOWN ON	SCALE: FULL	
					DWG BY PAL	DATE 01-20-99		MICROFILMED	DESIGN ACCT NO	CATEGORY CODE	DWG NO	REV
REV	DWN	CHK	DATE	DESCRIPTION	CHK BY SKM	DATE 01-21-99		8210-14		21C9862	0	