

DWG. NO. <b>2511064</b>	SIZE <b>A</b>	REV. <b>1</b>	SH. <b>1</b>
DESCRIPTION		MATERIAL	MAT. LOCATION
PLATE, 3/8" THK. PER ASTM A-240 HR, ANEALD & PICKLED		304L SS	-

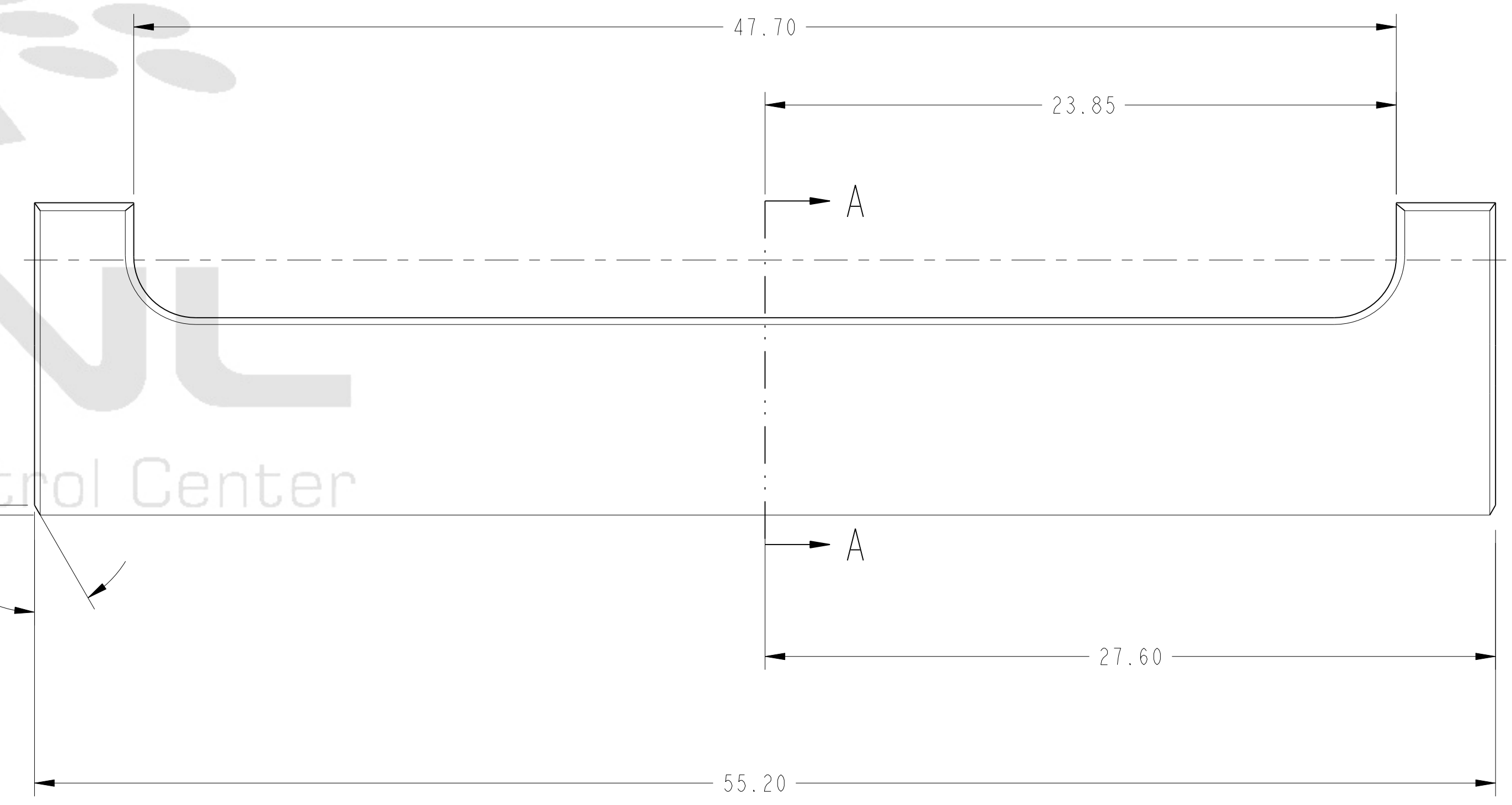

- NOTES: UNLESS OTHERWISE SPECIFIED.
1. DIMENSIONS AND TOLERANCING PER ANSI Y14.5M-1982 UNITS ARE IN INCHES UNLESS OTHERWISE SPECIFIED.
  2. USE OF SULFUR OR SILICONE BEARING OILS, LUBRICANTS, OR COOLANTS ARE STRICTLY PROHIBITED
  3. USE OF RESIN OR RUBBER BONDED ADRASIVES UNDER POWER IS STRICTLY PROHIBITED. USE VITREOUS BONDED ABRASIVES ONLY.
  4. CLEAN AFTER MACHINING PER VENDOR SPECIFICATION; SUBJECT TO LBNL APPROVAL.
  5. VENDOR SUGGESTED CHANGES TO WELD PREPS; SUBJECT TO LBNL APPROVAL.
  6. PROTECT FINISHED PART BY BAGGING OR SIMILAR METHOD TO PROTECT AND MAINTAIN CLEANLINESS DURING SHIPMENT AND STORAGE.
  7. ESTIMATED WEIGHT = 194 LBS

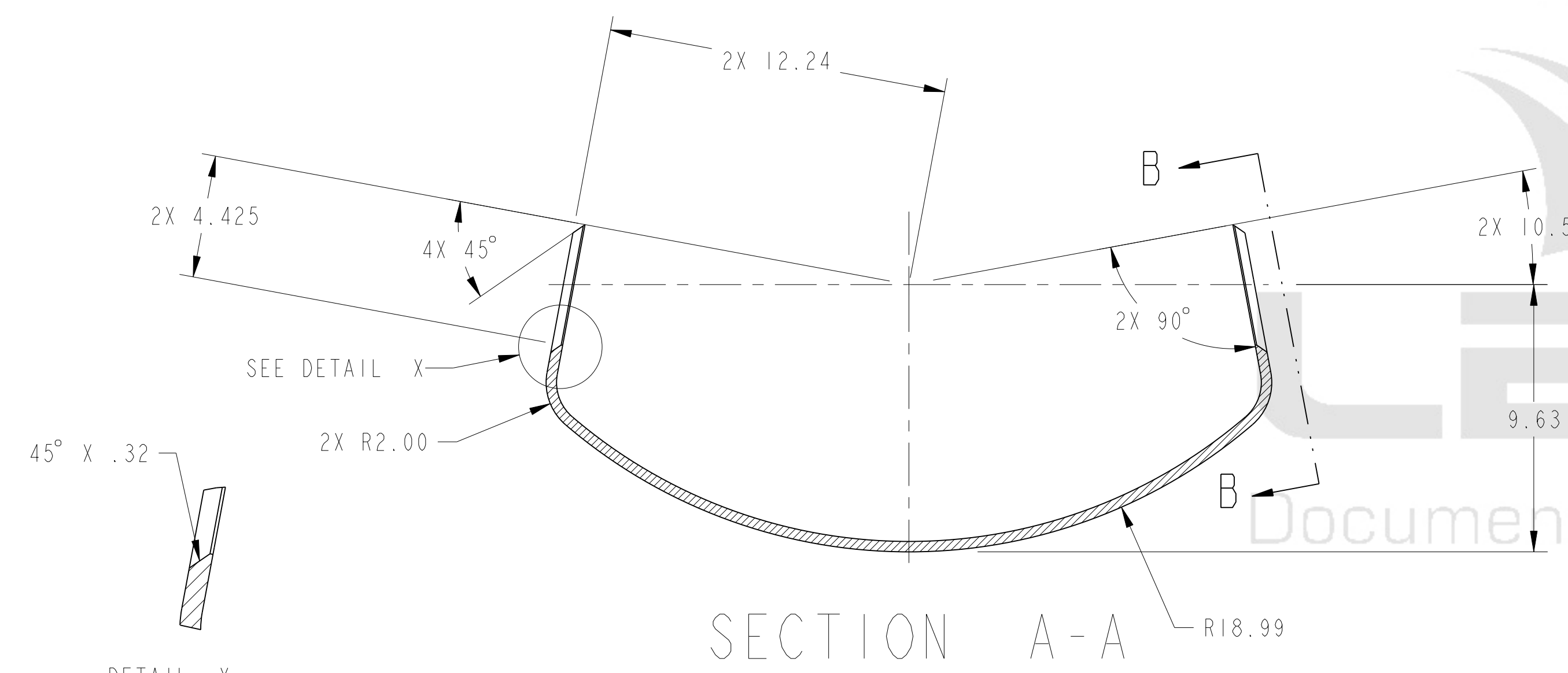
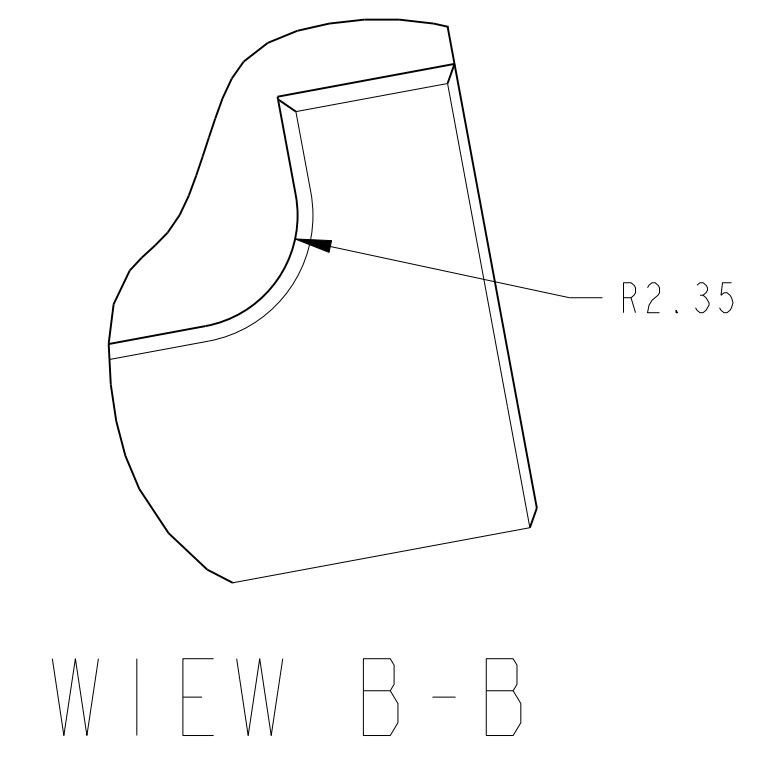
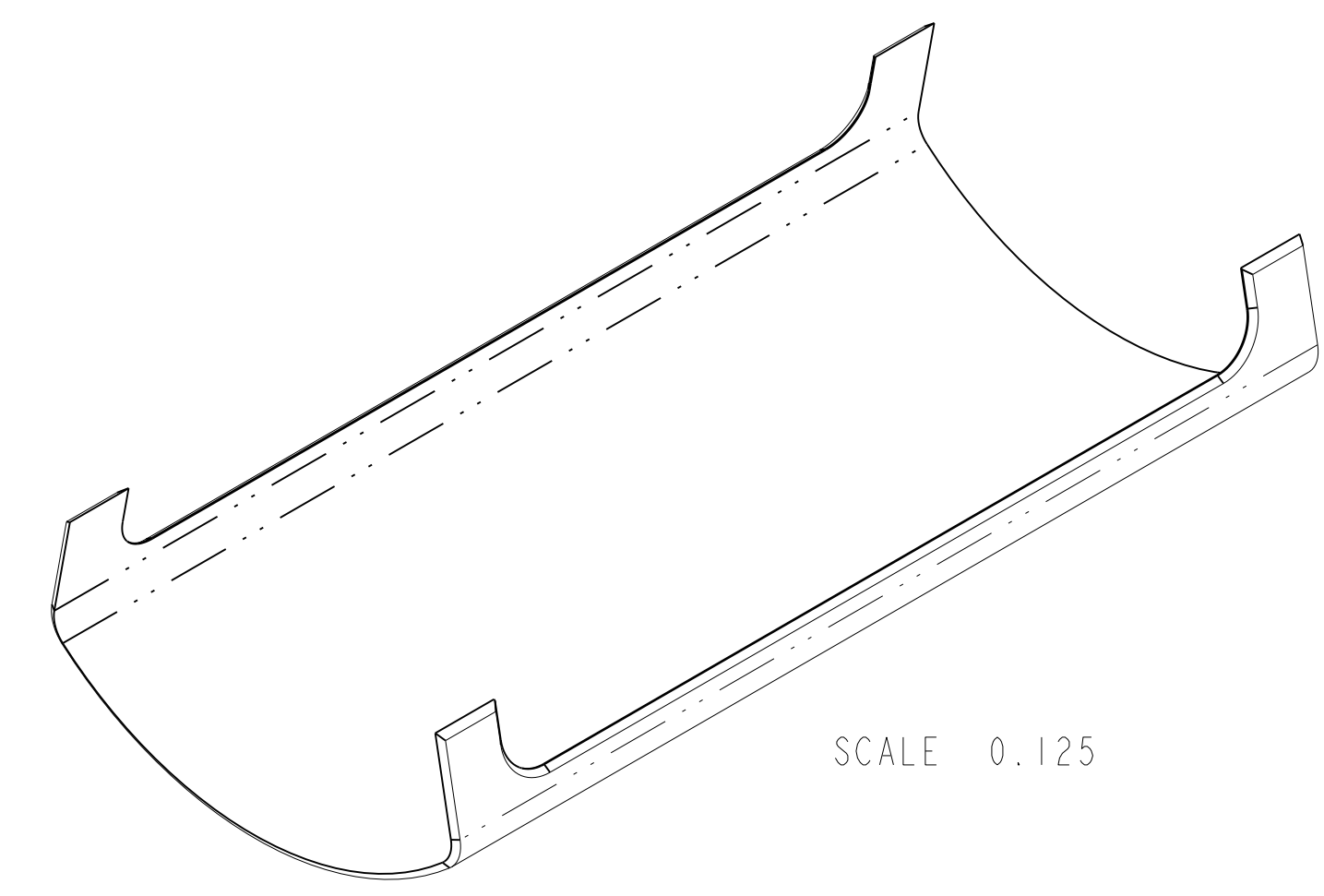
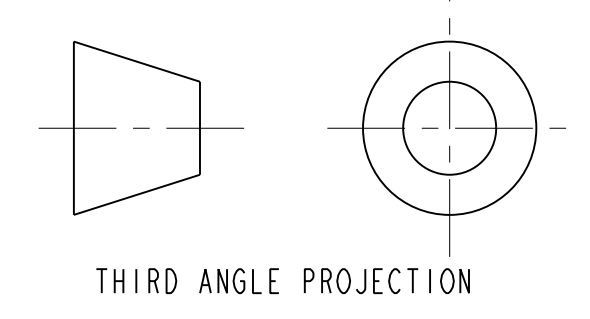

REV	DWG	CHK	ZONE	DATE	CHANGES
A	JDR/DPO			09/23/02	INITIAL RELEASE

UNLESS OTHERWISE SPECIFIED		SHOP ORDERS	
TOLERANCES	ACCT NO.	NO. REQD.	SER. NO.
X.X ± 0.1	FRAC. ± 1/64		
X.XX ± 0.03	Angles ± 1.00°		
X.XXX ± 0.010	FINISH 125 $\sqrt{Ra}$		
DO NOT SCALE PRINT		PROJECT NUMBER	
THREADS ARE CLASS 2		PROJECT TAG	
CHAMFER ENDS OF ALL SCREW THREADS 30°		METHOD	
CUT ROUND, 1.5 THREAD RELIEF ON MACHINED THREADS		MATERIAL	
BREAK EDGES .016 MAX. ON MACHINED WORK		DATE	
REMOVE BURRS, WELD SPATTER & LOOSE SCALE		DATE	
IN ACCORDANCE WITH ASME Y14.5M & B46.1		DATE	

**ERNEST ORLANDO LAWRENCE  
BERKELEY NATIONAL LABORATORY**  
UNIVERSITY OF CALIFORNIA - BERKELEY

LHC IR FEEDBOX  
CRYOGENICS  
LIQUID HELIUM TANK, LOWER SHELL.

MICROFILMED:  DWG. TYPE: PART SHOWN ON: SHEET 1 OF 1

SCALE: 0.250 DO NOT SCALE PRINTS

PATENT CLEAR: Z5LCE2 CATEGORY CODE: LH2003

DWG. NO. 2511064 SIZE A REV. 1

FILE: 2511064.LIQUID\_HELIIUM\_TANK\_LOWER\_SHELL

Officially Released to the LBNL Document Control Center  
Released: October 1st, 2002 DCC Auth Key: PNWNVIZKU9