

ITEM	PART NO	REQD	DESCRIPTION	MATERIAL
7	-	4	RING TERMINAL, AWG #4, MCMASTER 7113K252 OR EQUIVALENT	CU, TIN PLATED
6	-	1	THREADED ROD, 3/8"-16 UNC	B8M STRN.HRD.316 SS
5	-	1	THREADED ROD, 3/8"-24 UNF	B8M STRN.HRD.316 SS
4	-	1	TUBE, Ø5/8"OD, .188 WALL OR 5/8" ROD	304 SS
3	-	2	LOCK WASHER, 3/8	SS
2	-	2	JAM NUT, 3/8-16 UNC	ST 18-8
1	-	1	JAM NUT, 3/8-24 UNF	ST 18-8

NOTES: (UNLESS OTHERWISE SPECIFIED)

- THIS IS A CRYOGENIC VACUUM COMPONENT.
- CLEANING PROCEDURE: PER VENDOR SPECIFICATION WITH LBNL APPROVAL.
- PACKAGING AND STORAGE PROCEDURE OF THE COMPONENTS: PER VENDOR SPECIFICATION WITH LBNL APPROVAL.
- DIMENSIONS AND TOLERANCING PER ANSI Y14.5M-1982. UNITS ARE IN INCHES UNLESS OTHERWISE SPECIFIED.
- MOLYBDENUM DISULFIDE OR EQUIVALENT ANTI-SEIZE AGENT ON THREADS.
- RING TERMINALS USED FOR THERMAL INTERCEPT AT HIGHER ASSEMBLY.

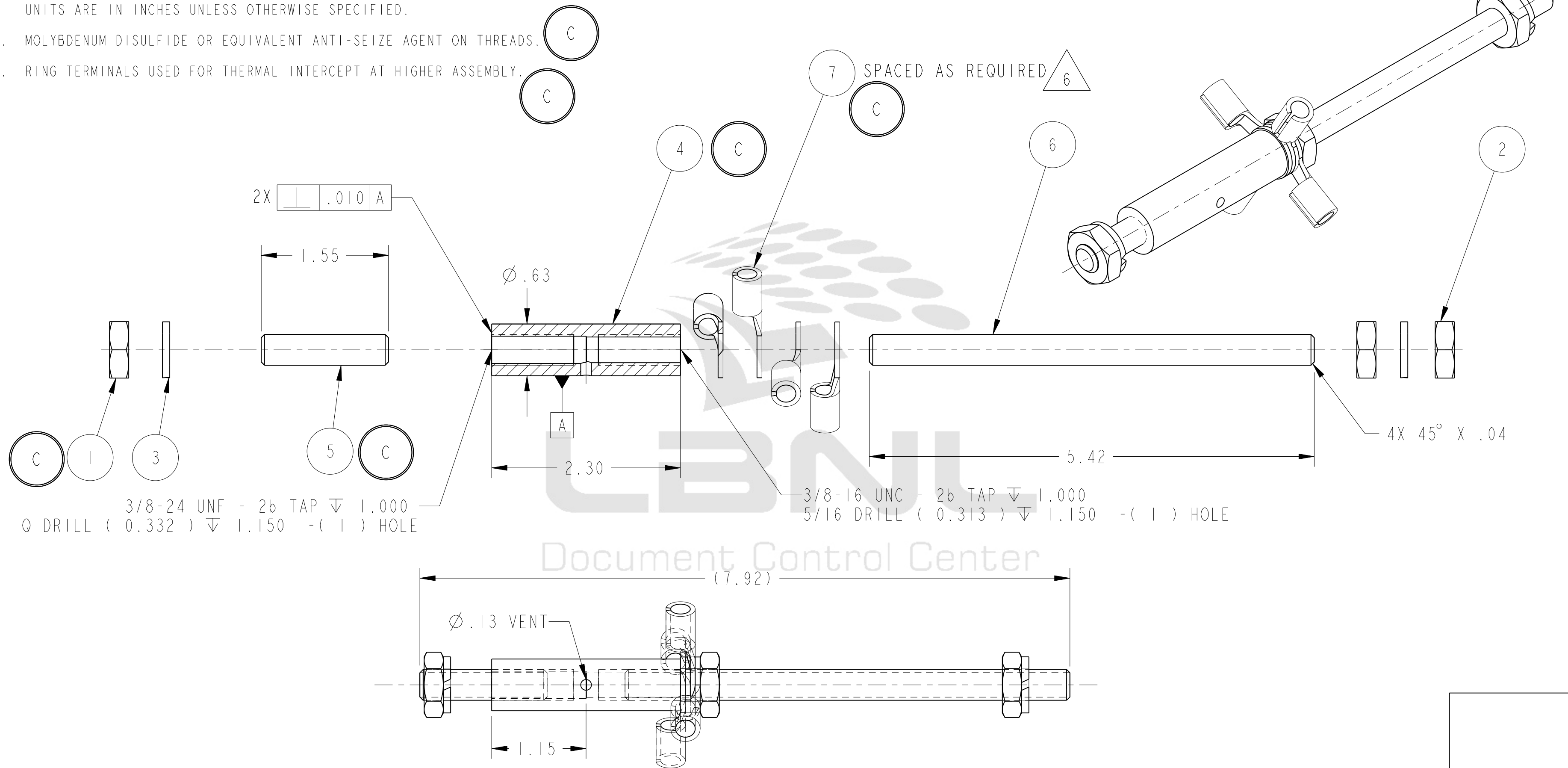

3/8-24 UNF - 2b TAP  $\nabla$  1.000  
 Ø DRILL ( 0.332 )  $\nabla$  1.150 - ( 1 ) HOLE

3/8-16 UNC - 2b TAP  $\nabla$  1.000  
 5/16 DRILL ( 0.313 )  $\nabla$  1.150 - ( 1 ) HOLE

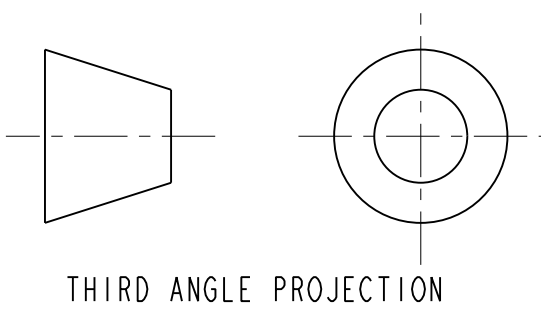

THIRD ANGLE PROJECTION

REV	DWG	CHK	ZONE	DATE	CHANGES
C	RLM	JPZ		2/11/04	TITLE: ADJUSTABLE WAS THERMAL BREAK REMOVE DOWEL PINS AND HOLES. ITEM 4 WAS NEMA G-10, ADD THREADS. THREADED RODS 3/8-16-UNC AND 3/8-24-UNF. JAM NUTS 3/8-16-UNC AND 3/8-24-UNF. REMOVE NOTE 7, ADD RING TERMINALS, NEW NOTES 5 AND 6.
B	MJK	DPO	B2	11/6/02	CREATED LONGER THREAD "5.42"
A	ARH	DPO		9/16/02	INITIAL RELEASE

TOLERANCES		UNLESS OTHERWISE SPECIFIED	
X.X ± 0.1	FRAC. ± 1/64		
X.XX ± 0.02	Angles ± 1.00°		
X.XXX ± 0.005	FINISH $\sqrt{25}$ (µin)		

SHOP ORDERS		SER. NO.
ACCT NO.	NO. REQD	-
DEL TO	DATE ISSD	-
PROJECT NAME	DATE REQD	-
IDENT METHOD	TAG	
PROJECT NUMBER	N/A	
PROJECT NAME	N/A	
DWG BY	R LA MANTIA	DATE 20-Aug-02
CHK BY	M HOFF	DATE 23-Aug-02
APR BY	D OSHATZ	DATE 23-Aug-02

ERNEST ORLANDO LAWRENCE BERKELEY NATIONAL LABORATORY			
UNIVERSITY OF CALIFORNIA - BERKELEY			
LHC IR FEEDBOX CRYOGENICS THRUST SUPPORT, ADJUSTABLE			
MICROFILMED:	DWG. TYPE	SHOWN ON	SCALE: 1.000
	ASSEM	-	DO NOT SCALE PRINTS
PATENT CLEAR:	DESIGN ACCT. NO.	CATEGORY CODE	DWG. NO. SIZE REV.
	Z5LCE3	LH2003	25H4133 C

DWG. NO. 25H4133 REV. C 1

REV. 1/23/00 J. K. OSHATZ